



## 联系我们

### 销售总部

地址:重庆市江津区德感工业园东方红大街  
电话:023-47211107 023-47211108  
邮箱:xs@chongchi.com

北方片区(京/津/蒙/黑/吉/辽/冀/豫/鲁/晋/陕)  
邮箱:beifang@chongchi.com

上海片区(沪/苏/浙/皖)  
邮箱:shanghai@chongchi.com

武汉片区(鄂/湘/粤/桂/闽/赣/琼)  
邮箱:wuhan@chongchi.com

西部片区(渝/云/贵/川/青/藏/新/甘/宁)  
电话:023-47211953 邮箱:xibu@chongchi.com

国际贸易中心  
电话:023-47211092 邮箱:sales@chongchi.com

版本号: CC202501



齿齿相依·带动未来  
GEARING INTERDEPENDENCE MOVING FUTURE



# CH/CK系列通用齿轮箱

CH/CK SERIES OF GEAR UNITS

## CSSC

重庆齿轮箱有限责任公司  
CHONGQING GEARBOX CO.,LTD

# contents

## 目录

<b>一. 产品概述</b>	Product Overview
1. 执行标准	Execution Standards
2. 技术特点	Technical Features
3. 产品分类	Product Classification
4. 命名规则	Naming Rules
5. 其他说明	Other Explanations
<b>二. 产品选型</b>	Product Selection
1. 符号定义	Definition of Symbols
2. 选型方法	Selection guideline
3. 选型举例	Selection Examples
4. 服务系数	Service Factor
<b>三. 产品参数</b>	Overview tables
1. CH2产品参数	Overview tables
2. CH3产品参数	Overview tables
3. CH4产品参数	Overview tables
4. CK2产品参数	Overview tables
5. CK3产品参数	Overview tables
6. CK4产品参数	Overview tables
<b>四. 其他说明</b>	Other Explanations
1. 输出空心轴	Output Hollow Shaft
2. 输出空心轴带锁紧盘	Hollow Shaft with shrink Disk

## 一、产品概述

### PRODUCT OVERVIEW

重庆齿轮箱有限责任公司(重齿公司)CH/CK系列通用齿轮箱,属通用工业平行轴/直交轴传动装置。

系列产品包含多级减速,多种装配布置型式,多种输出轴结构型式,多个型号。

本系列齿轮箱是集重齿公司长期的科研、齿轮设计以及制造经验,推出的新一代通用型工业齿轮传动装置。

主要参数均优化设计,采用了齿轮修形和修向技术。

结构上应用成组技术对零部件进行标准化、系列化以及模块化组合设计,实现了主要传动零件的跨越结构、跨型号的通用替换。

CH/CK系列通用齿轮箱,具有优异的承载能力和标准接口尺寸。

能与进口品牌产品同尺寸、同扭矩、同功率能力互换,稳定性和一致性良好。

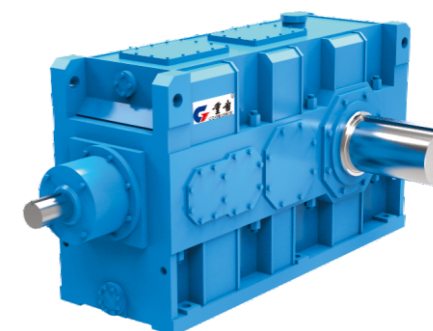

The CH/CK series gear units by Chongqing Gearbox Co., Ltd. are universal industrial parallel-axis/right-angle-axis transmission devices.

The series includes multi-stage reduction, multiple assembly arrangements, various output shaft structures, and multiple models.

This series of gear units is a new generation of general industrial gear transmission devices developed by the company based on its long-term scientific research, gear design, and manufacturing experience.

The main parameters are optimized, and tooth tip relief and end relief are applied.

Structurally, the component parts are standardized, serialized, and modularly combined, enabling the universal replacement of main transmission parts for different structures and models.

The CH/CK series of gear units possess excellent loading capacity and standard interface dimensions.

They can be interchanged with imported brands in terms of size, torque, and power, with good stability and consistency.

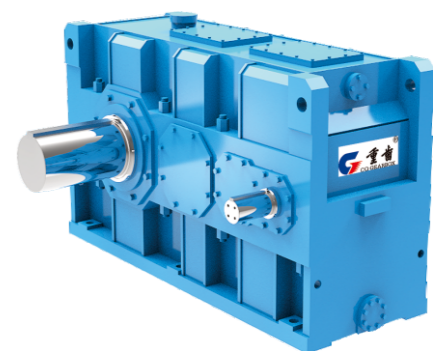

# 1

## 执行标准 Execution Standards

- ▶ 齿轮精度按:ISO13281995圆柱齿轮精度制;
- ▶ 圆柱齿轮强度按:ISO63362006直齿和斜齿轮承载能力计算方法;
- ▶ 圆锥齿轮强度按:ISO10300B伞齿轮负载容量的计算;
- ▶ 材料和热处理的质量控制按:ISO63365直齿和斜齿轮承载能力计算方法,第5部分材料的强度和重量;
- ▶ 同时也符合ANSI/AGMA6010E88闭式直齿和斜齿、人字齿轮传动装置;

- 
- Gear accuracy: ISO 1328 - 1995 Cylindrical Gear Accuracy System;
  - Cylindrical gear strength: ISO 6336 - 2006 Calculation Method of Load Capacity for Spur and Helical Gears;
  - Bevel gear strength: ISO 10300 - B Calculation of Load Capacity for Bevel Gears;
  - Quality control of materials and heat treatment: ISO 6336 - 5 Strength and Quality of Materials, Part 5 of the Calculation Method of Load Capacity for Spur and Helical Gears;
  - Also complies with ANSI/AGMA 6010 - E88 Enclosed Spur, Helical, and Herringbone Gear Drives.

## 技术特点 Technical Features

# 2

- ▶ **结构:**主要零部件采用模块化设计、结构独特、外形简洁,可实现水平或垂直等多种安装;
- ▶ **齿轮:**齿轮采用高级合金渗碳钢制造,齿面渗碳淬火、经高精度磨齿机磨齿,齿轮达到ISO1328-6级以上,进行齿廓修形和螺旋线修形,保证齿轮高精度和高强度并且齿向载荷分布均匀,具有很高的齿轮精度和负荷容量;
- ▶ **箱体:**采用焊接(或铸造)箱体,经过有限元分析后,设计的可吸收噪声的箱体结构,既保持箱体轻量化,又能更好的承受扭矩传动带来的受力变形,保证齿轮箱平稳运行;
- ▶ **轴承:**采用滚动轴承,尽可能地加大了轴承型号,保证齿轮箱在寿命期内使用可靠,维护方便;
- ▶ **密封:**旋转轴可选用性能优异的骨架油封和非接触式迷宫密封,非接触式迷宫密封在寿命期内无需维护;
- ▶ **润滑:**一般使用VG220~VG460矿物(合成)齿轮润滑油,可采用飞溅、油浴或集中强制润滑;
- ▶ **散热:**增大了箱体的散热表面积,根据使用要求,可用自然冷却,风扇冷却,盘管冷却和外部强制冷却多种方式;
- ▶ **可靠性:**重齿公司50多年的硬齿面齿轮传动系统的研制应用,积累了出色的设计、制造和使用维护经验,为各行业重要装备工业动力传动应用场景提供可靠解决、实施方案;
- ▶ 供货时间稳定;
- ▶ 针对客户要求非定制化设计;

- 
- Structure: The main components are designed with a modular structure, which is unique and good appearance. It can be installed on both horizontal or vertical position.
  - Gears: The gears are made of high grade-alloy carburized steel, with the tooth surface carburized, and ground by a high-precision gear grinding machine. The gear accuracy reaches above ISO 1328 - 6 level. Tooth profile modification and helix modification are carried out to ensure high gear accuracy, high strength, and uniform tooth load distribution.
  - Gear unit Housing: Welded (or cast) Gear unit housing. After finite element analysis, the housing structure is designed to absorb noise. It maintains the lightweight of the housing and can better withstand the deformation caused by torque transmission, ensuring the stable operation of the gearbox.
  - Bearings: Rolling bearings are used, and the bearing model is enlarged as much as possible to ensure reliable operation and easy maintenance during the service life of the gearbox.
  - Seals: For the rotating shaft, high-performance skeleton oil seals and non-contact labyrinth seals can be selected. The non-contact labyrinth seal requires no maintenance during its service lifetime.
  - Lubrication: Generally, VG220 - VG460 mineral (synthetic) gear lubricants are used. Splash lubrication, bath lubrication, or centralized forced lubrication can be adopted.
  - Heat Dissipation: The heat dissipation surface area of the Gear unit is increased. Multiple heat dissipation methods such as natural cooling, fan cooling, coil cooling, and external forced cooling can be used according to requirements.
  - Reliability: With over 50 years of experience in the research and application of case hardened gear transmission systems, the company has accumulated excellent design, manufacturing, operation and maintenance experience. It provides reliable solutions and implementation plans for various industries.
  - Stable Delivery Time: The company offers stable delivery time.
  - Customization: Customized design can be provided according to customer requirements.

# 3

## 产品分类 Product Classification

卧式安装 Horizontal Mounting

平行轴齿轮箱 Helical Gear unit

类型Types: CH2.H, CH3.H, CH4.H

传动级数Transmission Stages: 2~4, 速比范围Speed Ratio Range: 6.3~450

**CH.SH**

实心轴平键联接  
Solid Shaft

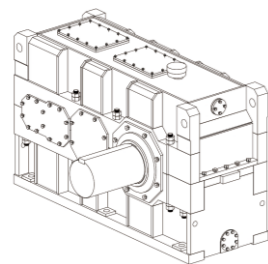

**CH.HH.**

空心轴平键联接  
Hollow Shaft

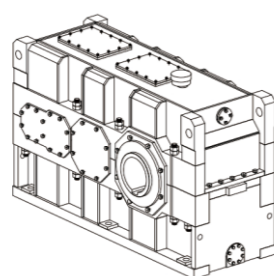

**CH.DH.**

空心轴锁紧盘联接  
Hollow Shaft with shrink Disk

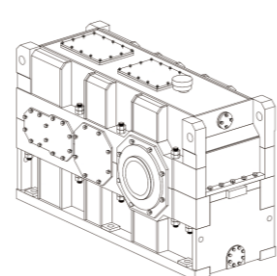

卧式安装 Horizontal Mounting

垂直轴齿轮箱 Bevel Gear unit

类型Types: CK2.H, CK3.H, CK4.H

传动级数Transmission Stages: 2~4级, 速比范围Speed Ratio Range: 6.3~400

**CK.SH**

实心轴平键联接  
Solid Shaft

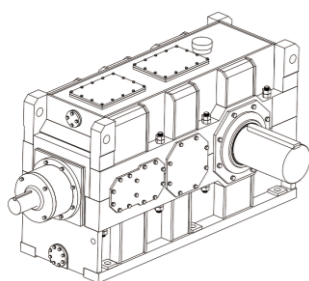

**CK.HH.**

空心轴平键联接  
Hollow Shaft

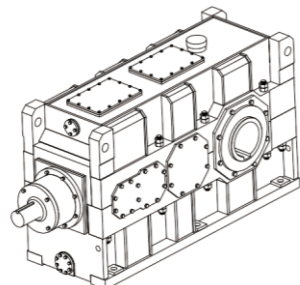

**CK.DH.**

空心轴锁紧盘联接  
Hollow Shaft with shrink Disk

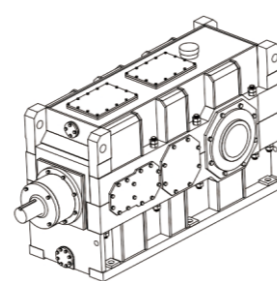

注:立式安装产品信息敬请垂询重齿公司。

Note: For information of vertical mounting products, please contact Chongqing Gearbox Co., Ltd.

## 命名规则 Naming Rules

# 4

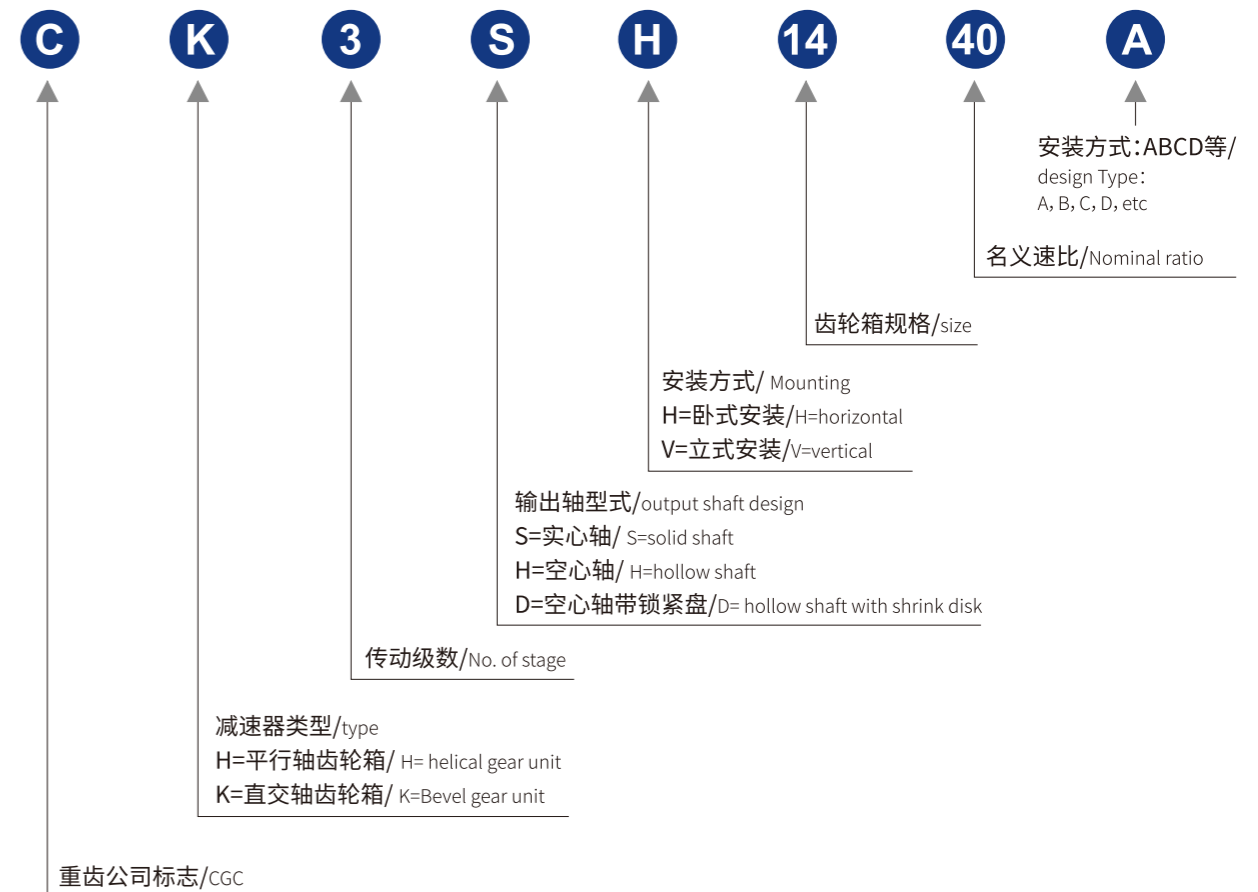

举例: 齿轮箱CK3SH14-40A

含义为: CK直交轴齿轮箱, 3级传动, 实心轴输出, 卧式安装, 规格14, 名义传动比40, 装配型式A。

Example: gear unit CK3SH14-40A

The meaning of the Gear unit is as follows: CK indicates a vertical/helical gear unit, 3-stage transmission, solid shaft output, horizontal mounting, size 14, nominal transmission ratio 40, and design type A.

# 5 其他说明 Other Explanations

- ▶ 样本中的插图仅为示例,不具有约束力;
- ▶ 样本给出的参考重量是重量平均值,不具有约束力;
- ▶ 齿轮箱最终参数应由重齿公司确认,为保证齿轮箱技术参数的准确性,请详细咨询重齿公司;
- ▶ 设备开动前必须认真阅读设备的使用维护说明书和操作说明;
- ▶ 齿轮箱供货前已做好运行准备,运行前需加注润滑油;
- ▶ 用油见使用维护说明书和操作说明,润滑油粘度和类别必须符合铭牌的规定;
- ▶ 有关油量的数据和说明仅供参考,实际加油量以液位计或油尺上的油位标记为准;
- ▶ 检查拆除输入(输出)轴和空气过滤器的密封胶带(如果有);
- ▶ 转动部件应由用户加罩保护,防止意外接触;
- ▶ 地脚螺栓的最低强度等级为8.8级;
- ▶ 请遵守使用方当地现行的其他安全规定要求;
- ▶ 齿轮箱适合的环境温度范围为-40°C至+45°C,不同的环境温度可能需要对标准结构进行修改;
- ▶ 根据不同的应用工况可能需要对密封、润滑、通风、表面防护和其它齿轮箱特性进行调整;
- ▶ 超低温、高湿度、腐蚀或易爆等特殊环境,请和重齿公司联系;
- ▶ 超出规格,非标设计,请和重齿公司联系;
- ▶ 因技术升级,重齿公司保留变更样本参数的权力;

- The illustrations in this catalogue for reference only and are not binding.
- The reference weights provided in this catalogue are average values and are not binding.
- The final parameters of the Gear unit should be confirmed by Chongqing Gearbox Co., Ltd. To ensure the accuracy of the Gear unit technical parameters, please consult the company for details.
- Before the operation of equipment, the operation and maintenance manual and operating instructions must be read carefully.
- The Gear unit is prepared for operation before delivery and requires lubricating oil to be added before operation.
- Refer to the operation and maintenance manual and operating instructions for the lubricating oil. The viscosity and category of the lubricating oil must comply with the regulations on nameplate.
- The data and instructions regarding the oil quantity are for reference only. The actual oil quantity should be determined by the oil level mark on the liquid level gauge or dipstick.
- Check and remove the sealing tape on the input (output) shaft and air filter (if any).
- The rotating parts should be protected by a cover by the user to prevent accidental contact.
- The minimum strength grade of the foundation bolts is 8.8.
- Please comply with other local safety regulations and requirements.
- The Gear unit is suitable for an ambient temperature range of -40°C to +45°C. Different ambient temperatures may caused the modifications to standard structure.
- Depending on different application conditions, adjustments may be needed for the sealing, lubrication, ventilation, surface protection, and other characteristics of the gearbox.
- For special environments such as ultra-low temperature, high humidity, corrosion, or explosion, please contact with Chongqing Gearbox Co., Ltd.
- For non-standard designs exceeding the specifications, please contact with Chongqing Gearbox Co., Ltd.
- Chongqing Gearbox Co., Ltd. reserves the right to change the sample parameters due to technological upgrades.

# 二、产品选型 PRODUCT SELECTION

根据用户应用场景需要选择齿轮箱的安装型式和装配型式。  
Select the installation type and design type of the Gear unit according to the application at site.

## 1 符号定义 Definition of Symbols

符号 Symbol	含义	Meaning
<b>Ed</b>	齿轮箱每小时运转周期 (%)	Operating cycle percentage of the Gear unit per hour (%)
<b>f1</b>	工作机服务系数,表1	Service factor of the driven machine, Table 1
<b>f2</b>	原动机服务系数,表2	Service factor of the driving machine, Table 2
<b>f3</b>	峰值扭矩系数,表3	Peak torque factor, Table 3
<b>f4</b>	环境温度系数,表4	Ambient temperature factor, Table 4
<b>f5</b>	海拔高度系数,表5	Altitude factor, Table 5
<b>f6</b>	负荷利用率系数,表6	Load utilization factor, Table 6
<b>i</b>	齿轮箱实际传动比	Actual transmission ratio of the gearbox
<b>is</b>	用户需求传动比	Required transmission ratio by the user
<b>iN</b>	齿轮箱名义传动比	Nominal transmission ratio of the gearbox
<b>n1</b>	输入转速、原动机转速 (rpm)	Input speed, rotational speed of the driving machine (rpm)
<b>n2</b>	输出转速、工作机转速 (rpm)	Output speed, rotational speed of the driven machine (rpm)
<b>P1</b>	原动机功率 (kW)	Power of the driving machine (kW)
<b>P2</b>	工作机功率 (kW)	Power of the driven machine (kW)
<b>P2N</b>	齿轮箱额定功率 (kW)	Rated power of the Gear unit (kW)
<b>T2N</b>	齿轮箱额定输出扭矩 (kN·m)	Rated output torque of the Gear unit (kN·m)
<b>T1MAX</b>	输入最大启动/制动扭矩 (N·m)	Maximum input starting/braking torque (N·m)
<b>Pg</b>	齿轮箱热功率 (kW)	Thermal power of the Gear unit (kW)
<b>Pg1</b>	齿轮箱的基础热容量,不带辅助冷却装置 (kW)	Basic thermal capacity of the Gear unit without auxiliary cooling devices (kW)
<b>Pg2</b>	齿轮箱的基础热容量,带冷却风扇 (kW)	Basic thermal capacity of the Gear unit with a cooling fan (kW)

## 2 选型方法 Selection guideline

- 对于运行工况较为复杂多变, 请与重齿公司联系。  
For complex and variable operating conditions, please contact with Chongqing Gearbox Co., Ltd.
- 对于运行负荷较为单一的齿轮箱, 请按以下步骤和方法进行齿轮箱选型。  
For gearboxes with relatively single operating loads, please follow the steps and methods below for Gear unit selection.

步骤 Step	项目内容 Project	结果 Result	
步骤1: 输入技术参数 Step 1: Input Technical Parameters	原动机 Driving Machine	原动机类型(电机/液压马达/内燃机) Type of driving machine (motor/hydraulic motor/internal combustion engine)	
		P <sub>1</sub>	
		n <sub>1</sub>	
		T <sub>1MAX</sub>	
		输入轴附加力 Additional force on input shaft (N)	
	工作机 Driven Machine	f <sub>1</sub>	
		P <sub>2</sub>	
		n <sub>2</sub>	
		每天工作小时数 Working hours per day (h)	
		每小时启动次数(次) Number of starts per hour (times)	
		E <sub>D</sub> (%)	
	工作环境 Working Environment	最高环境温度 Maximum ambient temperature (°C)	
		安装海拔高度 altitude (m)	
		现场散热条件(狭小空间/室内大空间/室外安装) On site heat dissipation conditions (narrow space/indoor large space/outdoor installation)	
	齿轮箱的要求 Gear unit Requirements	特殊环境(多尘/潮湿/腐蚀/极冷) Special environment (dusty/humid/corrosive/extremely cold)	
		齿轮箱类型(平行轴/垂直轴) Gear unit type (helical/bevel):	
		输出轴形式(实心轴/空心轴平键/空心轴锁紧盘) Output shaft form (solid shaft/hollow shaft /hollow shaft with shrink Disk):	
		安装方式(卧式/立式) Installation method (horizontal/vertical):	
		固定方式(地脚/支撑板) Fixing method (foundation bolts/support plate):	
		布置形式(双驱/单驱, 左/右布置, 装配型式) Arrangement form (dual drive/single drive, left/right arrangement, design type):	
		旋向要求(面对输入左/右旋, 面对输出左/右旋, 双向旋转) Rotation direction	
允许的冷却方式(风扇/水冷/外接油站) Allowed cooling methods (fan/water cooling/external oil station):			
其他附件(逆止器/慢驱/探头等) Other accessories (backstop/slow drive/probe, etc.):			

步骤 Step	项目内容 Project	结果 Result
步骤2: 选择合适的齿轮箱规格 Step 2: Select a Suitable Gearbox Specification	确定用户需求传动比 Fixing the user's required transmission ratio $i_s = n_1/n_2$	
	校核齿轮箱功率(或输出扭矩) Check the Gear unit power (or output torque) $P_2 f_1 f_2 \leq P_{2N}$ OR $T = (9.549 \times P_2) / n_2 (f_1 f_2) \leq T_{2N}$	
	校核尖峰扭矩 Check the peak torque $(T_{1max} \times n_1) / 9550 \times f_3 \leq P_{2N}$	
	校核许用热功率 Check the allowable thermal power $P_2 \times f_4 \times f_5 \times f_6 \leq P_G$	
	校核附加力 Check the additional force of input shaft and output shaft 如果齿轮箱输出轴受到附加力, 请联系重齿公司进行技术校核 If the output/input shaft of the Gear unit is subjected to additional forces, please contact with Chongqing Gearbox Co., Ltd. for technical verification	
	校核实际传动比 Check the actual transmission ratio $(i - i_s) / i = \%$	
选型步骤结束 End of selection process 确定最终型号 Determine the final Gear unit model		

### 3 选型举例 Selection Examples

现将一带式单驱动斗提机齿轮箱的选型过程, 举例如下:  
The selection process of a belt-driven single hoist Gear unit is as follows:

步骤 Step	项目内容 Project	结果 Result	
步骤1: 输入技术参数 Step 1: Input Technical Parameters	原动机类型 Type of driving machine	电机 motor	
	P <sub>1</sub>	75kW	
	n <sub>1</sub>	1500rpm	
	T <sub>1MAX</sub>	0.75kNm	
	输入轴附加力 Input shaft additional force	0	
	工作机 Driven Machine	f <sub>1</sub>	1.5
		P <sub>2</sub>	60kW
		n <sub>2</sub>	30rpm
		每天工作小时数 Working hours per day (h)	12
		每小时启动次数(次) Number of starts per hour (times)	7
		E <sub>D</sub> (%)	100%
	工作环境 Working Environment	输出轴附加力 output shaft additional force (N)	无 none
		最高环境温度 Maximum ambient temperature (°C)	30°C
		安装海拔高度 altitude (m)	100m
	齿轮箱的要求 Gear unit Requirements	现场散热条件 On site heat dissipation conditions	室内大空间 indoor large space
		特殊环境 Special environment	无 none
		齿轮箱类型 Gear unit type	垂直轴 bevel
		输出轴形式 Output shaft form	实心轴 solid shaft
		安装方式 Installation method	卧式 horizontal/
		固定方式 Fixing method	地脚螺栓 foundation bolts
		布置形式 Arrangement form	单驱, 装配型式 design A
旋向要求 Rotation direction		面对输出顺时针 clockwise face to output shaft	
允许的冷却方式 Allowed cooling methods	所有 all		
其他附件 Other accessories	无 none		

步骤 Step	项目内容 Project	结果 Result
步骤2: 选择合适的齿轮箱规格 Step 2: Select a Suitable Gearbox Specification	确定用户需求传动比 Determine the user's required transmission ratio $i_s = n_1/n_2 = 1500/30 = 50$	50
	校核齿轮箱功率(或输出扭矩) Check the Gear unit power (or output torque) $P_2 f_1 f_2 \leq P_{2N} \quad 60 * 1.5 * 1 = 90 < 111$	CK3SH09
	校核尖峰扭矩 Check the peak torque $(T_{1max} * n_1) / 9550 * f_3 \leq P_{2N} \quad 750 * 1500 / 9550 * 0.7 = 85.2 < 111$	CK3SH09
	校核许用热功率 Check the allowable thermal power $P_2 * f_4 * f_5 * f_6 \leq P_G \quad 60 * 1.1 * 1 * 1 = 66kW \leq P_{G1} = 124kW$	不带风扇 Without fan
	校核附加力 Check the additional force of input shaft and output shaft	无 None
	校核实际传动比 Check the actual transmission ratio $(i - i_s) / I = (50 - 49.8) / 50 = 0.4\%$	CK3SH09-50
	选型步骤结束 End of selection process	CK3SH09-50A

# 4 服务系数

Service Factor

表1 / 工作机系数 Table 1 / Service Factor of Driven machine fl

应用领域 Application Field	工作机 Driven machine	工作周期/天 Working Cycle / Day			应用领域 Application Field	工作机 Driven machine	工作周期/天 Working Cycle / Day		
		□3h	3-10h	□10h			□3h	3-10h	□10h
输送机械 Conveying Machinery	斗式提升机 Bucket Elevator	-	1.4	1.5	混匀机和搅拌机 Blending Machine and Mixer	液体搅拌机 Liquid Mixer	1	1.25	1.5
	刮板式输送机 Scraper Conveyor	-	1.25	1.5		液体搅拌机(密度可变) Liquid Mixer (Variable Density)	1.2	1.5	1.65
	皮带输送机≤100KW Belt Conveyor ≤100KW	1.2	1.3	1.4		固体介质搅拌机(非均匀材料) (Non-Medium Mixer Solid-uniform Material)	1.4	1.6	1.7
	皮带输送机>100KW Belt Conveyor >100KW	1.2	1.4	1.5		固体介质搅拌机(均匀材料) Solid Medium Mixer (Uniform Material)	-	1.35	1.4
	绞车 Winch	1.4	1.6	1.6	混凝土搅拌机 Concrete Mixer	-	1.5	1.5	
	卷扬机 Hoist	-	1.5	1.8	冷却塔 Cooling Tower	干式冷却塔 Dry Cooling Tower	-	-	2
	轨道行走机构 Track Traveling Mechanism	-	1.5	-		湿式冷却塔 Wet Cooling Tower	2	2	2
	货用电梯 Freight Elevator	-	1.2	1.5		风机(轴流和离心式) Fan (Axial and Centrifugal)	1.5	1.5	1.5
	客用电梯 Passenger Elevator	-	1.5	1.8	能源 Energy	变频器 Frequency Converter	-	1.8	2
	自动扶梯 Escalator	1.25	1.25	1.5		水轮(慢转) Water Wheel (Slow Rotation)	-	-	1.7
金属加工设备 Metal Processing Equipment	翻板机 Plate Turner	1	1	1.2	水轮机 Water Turbine	-	-	2	
	推钢机 Pusher	1	1.2	1.2	离心泵 Centrifugal Pump	1.15	1.35	1.45	
	绕线机 Winding Machine	-	1.6	1.75	活塞泵(单缸) Piston Pump (Single Cylinder)	1.35	1.5	1.8	
	冷床横移架 Cooling Bed Transverse Frame	-	1.5	1.5	活塞泵(多缸) Piston Pump (Multi-cylinder)	1.2	1.4	1.5	

应用领域 Application Field	工作机 Driven machine	工作周期/天 Working Cycle / Day			应用领域 Application Field	工作机 Driven machine	工作周期/天 Working Cycle / Day		
		□3h	3-10h	□10h			□3h	3-10h	□10h
水泥工业 Cement Industry	辊式矫直机 Roll Straightener	-	1.6	1.6	压缩机 Compressor	活塞式压缩机 Piston Compressor	-	1.8	1.9
	破碎机 Crusher	-	1.2	1.4		离心式压缩机 Centrifugal Compressor	-	1.4	1.5
	回转窑 Rotary Kiln	-	-	2.5		螺旋式压缩机 Compressor	-	1.5	1.75
	管式磨机 Tube Mill	-	-	2.5	索道缆车 Cableway	运货索道 Freight Cableway	-	1.4	1.5
	选粉机 Separator	-	1.6	1.6		往复式空中索道 Reciprocating Aerial Cableway	-	1.6	1.8
	辊压机 Roller Press	-	-	2.5		拖牵式索道 Tow Cableway	-	1.3	1.4
碾磨机和滚筒 Grinding Mill and Drum	球磨机 Ball Mill	-	-	2	采矿工业 Mining Industry	循环式索道 Circulating Cableway	-	1.4	1.6
	回转炉 Rotary Furnace	-	1.5	2		用于料堆捡拾 Material Picking in Stockpile	-	1.7	1.7
	磨煤机 Coal Mill	-	1.5	1.75		用于原生岩土 For Native Rock and Soil	-	2.2	2.2
	冷却和干燥鼓 Cooling and Drying Drum	-	1.5	1.6		采掘机机头 Mining Machine Head	-	2.2	2.2
起吊 Lifting	起重机和升降机 Crane and Elevator	请与重齿公司联系 Please Contact Chongqing Gearbox Co., Ltd.			采掘臂回转 Mining Arm Rotation	-	1.4	1.8	
造纸 Papermaking	碎浆机驱动装置 Pulper Drive Device	-	1.8	2	食品工业 Food Industry	粉碎机和碾磨机 Crusher and Mill	-	-	1.75
污水处理 Sewage Treatment	浓缩器 Concentrator	1.15	1.25	1.5		块茎切碎机 Tuber Chopper	-	1.25	1.5
	真空过滤器 Vacuum Filter	1.15	1.3	1.5	鼓式干燥器 Drum Dryer	-	1.25	1.5	
	回转曝气机 Rotary Aerator	-	1.8	2	化学工业 Chemical Industry	挤出机 Extruder	-	-	1.6
	转刷曝气机 Rotating Brush Aerator	-	-	2		调浆机 Slurry Adjuster	-	1.8	1.8
	螺杆泵 Screw Pump	-	1.3	1.5		橡胶研关机 Rubber Calendaring Machine	-	1.5	1.5
	收集器 Collector	1.15	1.25	1.5		冷却圆筒 Cooling Cylinder	-	1.3	1.4

**表2 / 原动机系数 $f_2$**  Table 2 / Service Factor  $f_2$  of driving machine

电机, 液压马达, 汽轮机 Motor, Hydraulic Motor, Steam Turbine	1.0
4~6缸活塞发动机 4-6 Cylinder Piston Engine	1.25
1~3缸活塞发动机 1-3 Cylinder Piston Engine	1.5

**表3 / 峰值扭矩系数 $f_3$**  Table 3 / Peak Torque Factor  $f_3$

系数 Coefficient	每小时尖峰载荷次数 Number of Peak Loads per Hour			
	1~5	6~30	31~100	≥100
单向载荷 Unidirectional Load	0.5	0.65	0.7	0.85
交变载荷 Alternating Load	0.7	0.95	1.1	1.25

**表4 / 环境温度系数 $f_4$**  Table 4 / Ambient Temperature Factor  $f_4$

系数 Coefficient	环境温度 Ambient Temperature (°C)				
	10	20	30	40	50
$f_4$ (不带其他辅助冷却或仅带风扇) (Without Other Auxiliary Cooling or Only with Fan)	0.88	1.0	1.15	1.35	1.65
$f_4$ (带冷却盘管或同时带冷却盘管和风扇) (With Cooling Coil or with Both Cooling Coil and Fan)	0.9	1.0	1.10	1.20	1.30

**表5 / 海拔高度系数 $f_5$**  Table 5 / Altitude Factor  $f_5$

系数 Coefficient	环境温度 Ambient Temperature (°C)				
	0~1000	1000~2000	2000~3000	3000~4000	>4000
$f_5$ (不带其他辅助冷却或仅带风扇) (Without Other Auxiliary Cooling or Only with Fan)	1.0	1.05	1.10	1.18	1.25
$f_5$ (带冷却盘管或同时带冷却盘管和风扇) (With Cooling Coil or with Both Cooling Coil and Fan)	1.0	1.02	1.04	1.06	1.09

**表6 / 运行时间系数 $f_6$**  Table 6 / Operating Time Factor  $f_6$

系数 Coefficient	齿轮箱每小时运转周期 ED(%) Gear unit Operating Cycle ED (%) per Hour				
	100	80	70	40	20
$f_6$	1.0	0.94	0.86	0.74	0.56

# 三、产品参数

## OVERVIEW TABLES

### 1 / CH2产品参数 Overview tables

CH2齿轮箱额定输出扭矩 Nominal output torque of low speed shaft  $T_{2N}$  (kNm)

in	齿轮箱规格 Gear unit sizes																				
	04	05	06	07	08	09	10	11	12	13	14	15	16	17	18	19	20	21	22	23	24
6.3	6.3	10.5		19.9		33.2		58.4		85		140		192		290				492	
7.1	6.4	11		19.9		33.2		58.4		85		140	157	192	226	290	330	404		512	556
8	6.6	11	13.2	19.9	25.2	33.2	41.5	58.4	72.7	85	105	140	157	192	226	290	330	404	451	532	576
9	6.6	11	14.1	19.9	25.2	33.2	41.5	58.4	72.7	85	105	140	157	192	226	290	330	404	451	547	600
10	6.2	10.3	14.1	19.9	25.2	33.2	41.5	58.4	72.7	85	105	140	157	192	226	290	330	404	451	566	615
11.2	6.2	10.4	14.1	19.9	25.2	33.2	41.5	58.4	72.7	85	105	140	157	192	226	290	330	404	451	566	635
12.5	6.6	11	13.2	19.9	25.2	33.2	41.5	58.4	72.7	85	105	140	15	192	226	290	330	404	451	591	640
14	6.6	11	13.2	19.9	25.2	33.2	41.5	58.4	72.7	85	105	140	157	192	226	290	330	404	451	610	665
16	6.6	11	14.1	19.9	25.2	33.2	41.5	58.4	72.7	85	105	140	157	192	226	290	330	404	451	630	685
18	6.2	10.3	14.1	18.7	25.2	33.2	41.5	58.4	72.7	85	105	140	157	192	226	290	330	404	451	630	714
20	6.5	11	14.1	18.7	25.2	33.2	41.5	58.4	72.7	85	105	140	157	192	226	290	330	404	451	576	714
22.4	6.2	10.7	13.2	19.5	23.6	32.6	41.5	58.4	72.7		105		157		226		330		451		650
25			14		23.6		41.5		72.7		105										
28			13.6		24.6		40.9		71.5												

CH2齿轮箱实际传动比 $i$  Actual ratios  $i$  for types Ch2

in	齿轮箱规格 Gear unit sizes																				
	04	05	06	07	08	09	10	11	12	13	14	15	16	17	18	19	20	21	22	23	24
6.3	6.2	6.3		6.1		6.1		6.3		6.0		6.2		6.3		6.3		6.1		6.1	
7.1	7.0	7.0		6.9		6.8		7.1		6.8		7.0	7.3	7.1	7.3	6.9	7.2	6.8	6.7	6.8	7.0
8	7.8	7.9	7.9	7.8	7.8	7.6	7.7	8.1	8.0	7.7	7.5	7.9	8.2	8.0	8.2	7.7	8.0	7.6	7.6	7.8	8.0
9	8.9	9.0	8.9	8.7	8.8	8.6	8.6	9.2	8.8	8.6	8.6	8.9	9.0	9.0	8.9	8.8	8.6	8.6	8.6	9.0	9.0
10	9.8	10	9.8	9.9	10	9.8	9.8	10.2	9.8	9.7	9.7	10	10.2	10.2	10	9.8	9.7	10	9.9	9.9	10
11.2	11.1	11.0	11.1	10.9	11.3	11.0	11.2	11.2	11.1	10.8	10.9	11.6	11.4	11.4	11.3	11.1	11.1	11.4	11.2	11.3	11.3
12.5	12.7	12.6	12.7	12.3	12.7	12.2	12.4	12.3	12.2	12.2	12.2	12.8	13.1	12.6	13.3	12.4	12.4	12.8	12.5	12.8	12.7
14	14.1	14.2	14.7	13.9	14.4	13.9	13.8	13.7	13.7	13.7	13.6	14.1	14.5	13.9	14.7	14.0	13.8	14.5	14.1	14.6	14.3
16	15.5	15.6	16.2	15.4	16.0	15.6	15.4	15.6	15.6	15.6	15.5	15.8	16.0	15.6	16.2	15.7	15.6	15.7	16.0	16.6	16.4
18	18.0	17.7	17.7	17.3	18.1	17.7	17.5	18.1	17.6	17.7	17.4	17.9	17.9	17.9	18.2	17.5	17.5	17.9	17.4	18.6	18.5
20	19.6	20	20	19.3	20.2	19.3	19.8	19.6	20.3	19.4	19.7	19.5	20.3	20.3	19.7	19.9	19.9	19.2	19.9	20.1	21.0
22.4	21.9	22.6	22.0	22.6	21.7	21.9	21.9	21.9	22.4		22.1		21.7		21.9		22.4		22.5		22.6
25			24.8		24.3		24.0		24.3		24.3		24.3								
28			28.3		27.5		27.3		27.5												



CH2齿轮箱额定功率 Nominal power ratings P																						
ni	in	齿轮箱规格 Gear unit sizes																				
		04	05	06	07	08	09	10	11	12	13	14	15	16	17	18	19	20	21	22	23	24
1500	6.3	157	264		513		857		1446		2213		3520		4750		7288					
	7.1	144	248		450		762		1290		1952		3136	3364	4233	4832	6625	7240	9346			
	8	133	218	261	399	505	682	846	1131	1434	1735	2198	2798	3001	3777	4311	5933	6484	8325			
	9	117	192	250	359	450	605	756	1002	1291	1554	1923	2476	2734	3344	4002	5202	5999	7371	8261		
	10	99	163	226	316	396	532	665	901	1161	1379	1707	2194	2423	2963	3547	4631	5339	6361	7130	8948	
	11.2	88	148	200	287	352	473	583	817	1031	1236	1516	1901	2160	2641	3132	4091	4687	5586	6334	7847	8850
	12.5	82	137	164	254	311	426	525	743	938	1097	1346	1724	1881	2395	2670	3666	4184	4964	5654	7279	7933
	14	74	122	141	225	274	375	474	672	836	972	1214	1558	1706	2164	2421	3246	3749	4375	5025	6541	7323
	16	67	110	137	203	247	334	422	587	730	855	1067	1390	1541	1931	2188	2902	3320	4030	4428	5971	6567
	18	54	91	125	170	219	295	373	508	649	755	948	1225	1376	1680	1953	2608	2968	3553	4079	5332	6051
	20	52	87	110	152	196	270	330	469	561	688	837	1128	1216	1487	1803	2290	2605	3301	3554	4502	5349
	22.4	44	74	94	135	171	234	297	418	510		745		1139		1621		2319		3150		4509
25			89		153		272		471		679											
28			76		141		236		408													
1000	6.3	105	176		342		571		964		1475		2347		3167		4859				8430	
	7.1	96	165		300		508		860		1301		2091	2243	2822	3221	4417	4827	6231	7916	8321	
	8	88	146	174	266	337	455	564	754	956	1157	1465	1865	2001	2518	2874	3955	4322	5550	6247	7183	7527
	9	78	128	166	239	300	403	504	668	860	1036	1282	1650	1823	2229	2668	3468	3999	4914	5508	6354	6953
	10	66	108	150	210	264	355	444	601	774	919	1138	1463	1615	1976	2364	3087	3560	4241	4753	5965	6465
	11.2	58	99	134	191	235	315	389	545	687	824	1011	1268	1440	1761	2088	2727	3124	3724	4222	5231	5900
	12.5	55	91	109	169	207	284	350	496	625	732	898	1149	1254	1596	1780	2444	2789	3310	3769	4853	5289
	14	49	81	94	150	183	250	316	448	557	648	809	1039	1137	1443	1614	2164	2499	2917	3350	4360	4882
	16	45	74	91	135	165	223	282	391	487	570	712	927	1028	1287	1458	1935	2213	2686	2952	3981	4378
	18	36	61	83	113	146	197	249	338	433	503	632	817	917	1120	1302	1739	1979	2369	2719	3555	4034
	20	35	58	74	101	130	180	220	312	374	459	558	752	811	991	1202	1526	1737	2201	2370	3001	3566
	22.4	30	50	63	90	114	156	198	279	340		497		759		1081		1546		2100		3006
25			59		102		181		314		453											
28			50		94		157		272													
750	6.3	79	132		257		428		723		1106		1760		2375		3644				6322	
	7.1	72	124		225		381		645		976		1568	1682	2117	2416	3313	3620	4673	5937	6240	
	8	66	109	131	199	253	341	423	566	717	867	1099	1399	1500	1888	2155	2967	3242	4163	4685	5387	5645
	9	58	96	125	179	225	303	378	501	645	777	962	1238	1367	1672	2001	2601	2999	3686	4131	4766	5215
	10	50	81	113	158	198	266	333	451	580	689	853	1097	1212	1482	1773	2315	2670	3181	3565	4474	4849
	11.2	44	74	100	144	176	236	291	409	516	618	758	951	1080	1321	1566	2046	2343	2793	3167	3924	4425
	12.5	41	68	82	127	155	213	263	372	469	549	673	862	941	1197	1335	1833	2092	2482	2827	3639	3967
	14	37	61	70	112	137	187	237	336	418	486	607	779	853	1082	1211	1623	1875	2187	2512	3270	3662
	16	33	55	68	101	124	167	211	293	365	427	534	695	771	966	1094	1451	1660	2015	2214	2986	3284
	18	27	46	63	85	109	147	187	254	324	377	474	613	688	840	976	1304	1484	1777	2039	2666	3025
	20	26	43	55	76	98	135	165	234	281	344	419	564	608	744	902	1145	1303	1651	1777	2251	2674
	22.4	22	37	47	68	85	117	149	209	255		373		569		811		1160		1575		2255
25			44		76		13		235		340											
28			38		70		118		204													

CH2齿轮箱无冷却措施的许用热功率 Thermal capacities Without Other Auxiliary Cooling PG1 (kW)																	
ni	in	齿轮箱规格 Gear unit sizes															
		04	05	06	07	08	09	10	11	12	13	14	15	16	17	18	
1500	6.3~10	PG1	51	61	71	78	84	96	95								
	11.2~16	PG1	44	58	70	79	95	104	110	144	169	160	193				
	18~28	PG1	39	50	54	71	76	93	94	133	150	179	195	179	179		
1000	6.3~10	PG1	51	65	77	88	100	119	125	164	193	209	234	200	198		
	11.2~16	PG1	42	57	69	79	97	108	117	166	206	212	263	252	254	280	292
	18~28	PG1	36	48	52	69	73	92	93	142	160	208	227	242	248	293	300
750	6.3~10	PG1	48	63	75	87	100	121	128	179	219	249	284	277	286		
	11.2~16	PG1	39	53	65	75	92	104	113	164	208	218	272	275	282	319	339
	18~28	PG1	33	44	48	64	68	87	87	137	154	207	240	251	258	311	322

CH2齿轮箱带风扇冷却的许用热功率 Thermal capacities With fan PG2 (kW)																	
ni	in	齿轮箱规格 Gear unit sizes															
		04	05	06	07	08	09	10	11	12	13	14	15	16	17	18	
1500	6.3~10	PG2	123	165	196	241	273	320	335	489	577	631	715	612	617	710	691
	11.2~16	PG2	99	140	169	210	257	281	303	469	583	603	751	710	721	873	919
	18~28	PG2	85	116	125	181	190	239	235	397	439	586	627	665	676	882	893
1000	6.3~10	PG2	96	131	156	193	222	262	278	424	516	587	673	640	668	812	830
	11.2~16	PG2	76	108	131	163	201	221	240	377	476	501	626	617	634	782	837
	18~28	PG2	65	89	96	139	146	185	182	314	347	473	506	554	566	751	764
750	6.3~10	PG2	80	109	132	164	180	212	225	341	413	468	536	504	524	633	643
	11.2~16	PG2	63	90	109	136	164	180	195	307	386	405	507	497	509	627	669
	18~28	PG2	54	74	79	114	120	151	149	256	283	384	442	448	458	606	616

注意 NOTE

- PG1: 齿轮箱内部存油, 飞溅润滑, 无额外冷却措施情况下许用热功率;
- PG2: 齿轮箱内部存油, 飞溅润滑, 带风扇冷却情况下许用热功率;
- 表中数值按每小时工作周期 100%, 室内大空间安装, 海拔高度至 1000m 得来的; 如果现场条件不同, 需对许用热功率进行修正, 所选齿轮箱的热功率必须满足:  $P2 \times f4 \times f5 \times f6 \leq PG$ ;
- 如无冷却措施许用热功率PG1或风扇冷却许用热功率PG2不能满足, 请联系重齿公司提供盘管冷却方案或强制润滑方案;
- 一般情况下, 电机功率  $\geq 500kW$  时建议采用强制润滑方案;

- PG1: Thermal capacities Without Other Auxiliary Cooling
- PG2: Thermal capacities With fan cooling
- The values in the table are obtained under conditions of 100% duty per hour, indoor large space installation and altitude of up to 1000m. if the on-site conditions are different, the values should be adjusted.
- Thermal capacities must satisfy:  $P2 \times f4 \times f5 \times f6 \leq PG$ ;
- If the thermal capacities PG1 PG2 is not suitable, please contact with Chongqing Gearbox Co., Ltd. for cooling solution.
- Generally, a forced lubrication solution is suggested when motor power  $P1 \geq 500kW$ .

**CH2齿轮箱规格04~12外形尺寸(卧式安装)**

Dimension of gear unit type 04-12 (horizontal mounting)

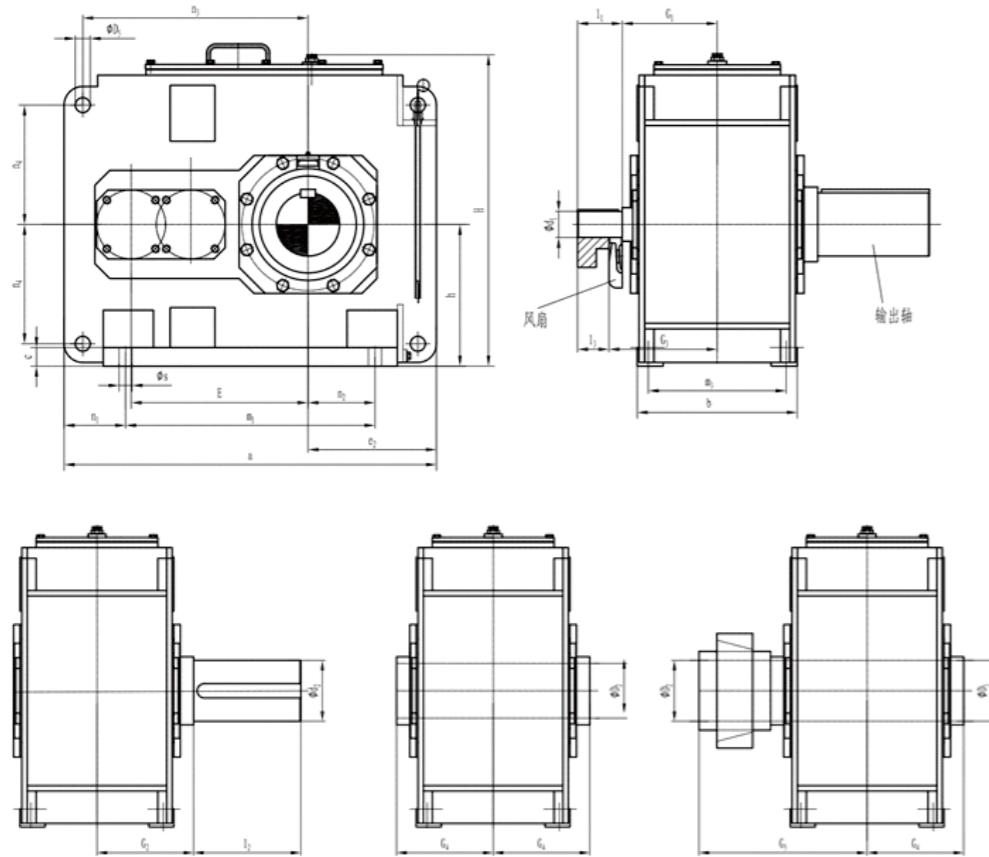

CH2SH

CH2HH

CH2DH

(实心轴平键 /solid shaft) (空心轴平键/Hollow Shaft) (空心轴锁紧盘/Hollow Shaft with shrink Disk)

**CH2SH**  
装配型式design

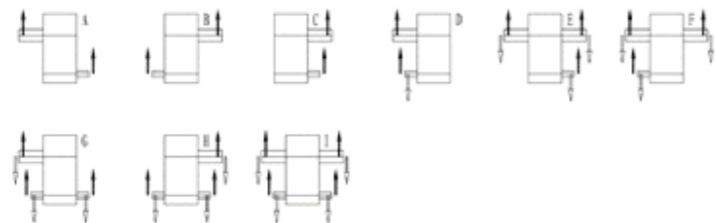

**CH2HH**  
装配型式design



**CH2DH**  
装配型式design



CH2齿轮箱规格04-12外形尺寸(卧式安装) Dimension of gear unit of size 04-12 (horizontal mounting)

规格 size	尺寸代号 Symbol													
	a	b	c	D5	E	H	h0.5	m1	m3	n1	n2	n3	n4	s
04	565	215	28	24	270	415	200	355	180	105	85	345	150	19
05	640	255	28	24	315	500	230	430	220	105	100	405	180	19
06	720	255	28	24	350	500	230	510	220	105	145	440	180	19
07	785	300	35	28	385	610	280	545	260	120	130	500	215	24
08	890	300	35	28	430	610	280	650	260	120	190	545	215	24
09	925	370	40	36	450	690	320	635	320	145	155	585	245	28
10	1025	370	40	36	500	690	320	735	320	145	205	635	245	28
11	1105	430	50	40	545	815	380	775	370	165	180	710	300	35
12	1260	430	50	40	615	815	380	930	370	165	265	780	300	35

CH2齿轮箱规格04-12输入轴尺寸(卧式安装) input shaft dimensions of size 04-12 (horizontal mounting)

规格 size	in=6.3~11.2			in=8~14			in=12.5~22.5			in=16~28			G1	G3
	d1	l1	l3	d1	l1	l3	d1	l1	l3	d1	l1	l3		
04	45	100	80				32	80	60				170	190
05	50	100	80				38	80	60				195	215
06				50	100	80				38	80	60	195	215
07	60	135	100				50	110	80				120	130
08				60	135	100				50	110	80	120	190
09	75	140	110				60	140	110				145	155
10				75	140	110				60	140	110	145	205
11	90	165	130				70	140	105				165	180
12				90	165	130				70	140	105	165	265

CH2齿轮箱规格04-12输出轴尺寸(卧式安装) output shaft dimensions of size 04-12 (horizontal mounting)

规格 size	齿轮箱输出轴尺寸(卧式安装) output shaft dimensions (horizontal mounting)									质量 weight (kg)	油量 oil quantity (L)	油站型号 oil station size (L/min)
	输出实心轴平键 solid shaft			输出空心轴平键 Hollow Shaft		输出空心轴锁紧盘 Hollow Shaft with shrink Disk						
	d2	l2	G2	D2	G4	D2	D3	G4	G5			
04	80	170	140	80	140	85	85	140	205	190	10	
05	100	210	165	95	165	100	100	165	240	300	15	
06	110	210	165	105	165	110	110	165	240	360	16	
07	120	210	195	115	195	120	120	195	280	510	27	
08	130	250	195	125	195	130	130	195	285	590	30	
09	140	250	235	135	235	140	145	235	330	830	42	
10	160	300	235	150	235	150	155	235	350	960	45	
11	170	300	270	165	270	165	170	270	400	1340	71	
12	180	300	270	180	270	180	185	270	405	1620	76	

**CH2齿轮箱规格13~24外形尺寸(卧式安装)**

Dimension of gear unit of size 13-24 (horizontal mounting)

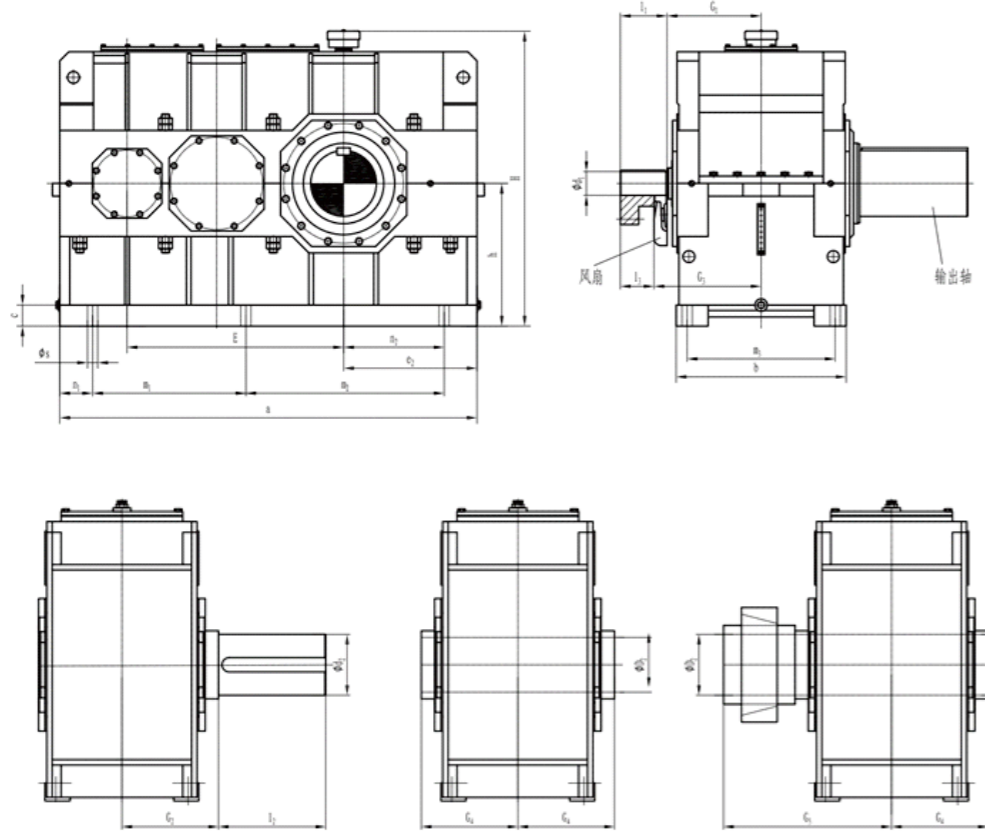

CH2SH

CH2HH

CH2DH

(实心轴平键 /solid shaft) (空心轴平键 /Hollow Shaft) (空心轴锁紧盘 /Hollow Shaft with shrink Disk)

**CH2SH**  
装配型式design

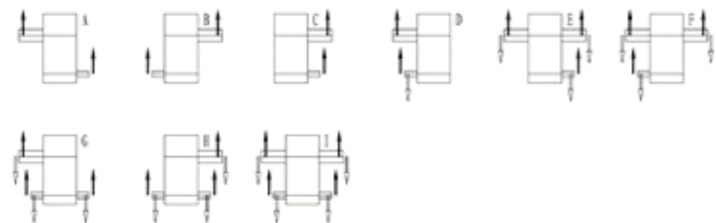

**CH2HH**  
装配型式design



**CH2DH**  
装配型式design



CH2齿轮箱规格13-24外形尺寸(卧式安装) Dimension of gear unit of size 13-24 (horizontal mounting)

规格 size	尺寸代号 Symbol														
	a	b	c	D <sub>5</sub>	E	H	h <sub>0.5</sub>	m <sub>1</sub>	m <sub>2</sub>	m <sub>3</sub>	n <sub>1</sub>	n <sub>2</sub>	n <sub>3</sub>	n <sub>4</sub>	s
13	1290	550	60	48	635	900	440	545	545	475	100	305	835	340	35
14	1430	550	60	48	705	900	440	545	685	475	100	375	905	340	35
15	1550	625	70	55	762	1000	500	655	655	535	120	365	1005	375	42
16	1640	625	70	55	808	1000	500	655	745	535	120	410	1050	375	42
17	1740	690	80	55	860	1110	550	735	735	600	135	390	1145	425	42
18	1860	690	80	55	920	1110	550	735	855	600	135	450	1205	425	42
19	2010	790	90	65	997	1240	620	850	850	690	155	435	1345	475	48
20	2130	790	90	65	1057	1240	620	850	970	690	155	495	1405	475	48
21	2140	830	100	75	1067	1390	700	900	900	720	170	485	1400	520	56
22	2250	830	100	75	1122	1390	700	900	1010	720	170	540	1455	520	56
23	2380	930	115	80	1185	1565	780	1010	1010	810	180	550	1560	580	56
24	2510	930	115	80	1250	1565	780	1010	1140	810	180	615	1625	580	56

CH2齿轮箱规格13-24输入轴尺寸(卧式安装) input shaft dimensions of size 13-24 (horizontal mounting)

规格 size	i <sub>n</sub> =6.3~11.2			i <sub>n</sub> =7.1~12.5			i <sub>n</sub> =8~14			i <sub>n</sub> =12.5~22.5			i <sub>n</sub> =14~22.5			i <sub>n</sub> =16~25			G <sub>1</sub>	G <sub>3</sub>
	d <sub>1</sub>	l <sub>1</sub>	l <sub>3</sub>	d <sub>1</sub>	l <sub>1</sub>	l <sub>3</sub>	d <sub>1</sub>	l <sub>1</sub>	l <sub>3</sub>	d <sub>1</sub>	l <sub>1</sub>	l <sub>3</sub>	d <sub>1</sub>	l <sub>1</sub>	l <sub>3</sub>	d <sub>1</sub>	l <sub>1</sub>	l <sub>3</sub>		
13	100	205	170							85	170	135							330	365
14							100	205	170							85	170	135	330	365
15	120	210	165							100	210	165							365	410
16				120	210	165							100	210	165				365	410
17	125	245	200							110	210	165							420	465
18				125	245	200							110	210	165				420	465
19	150	245	200							120	210	165							475	520
20				150	245	200							120	210	165				475	520
21	170	290	240							140	250	200							495	545
22				170	290	240							140	250	200				495	545
23	190	330								150	250								560	
24				190	330								150	250					560	

CH2齿轮箱规格13-24输出轴尺寸(卧式安装) output shaft dimensions of size 13-24 (horizontal mounting)

规格 size	齿轮箱输出轴尺寸(卧式安装) output shaft dimensions (horizontal mounting)									质量 weight (kg)	油量 oil quantity (L)	油站型号 oil station size (L/min)
	输出实心轴平键 solid shaft			输出空心轴平键 Hollow Shaft			输出空心轴锁紧盘 Hollow Shaft with shrink Disk					
	d <sub>2</sub>	l <sub>2</sub>	G <sub>2</sub>	D <sub>2</sub>	G <sub>4</sub>	D <sub>2</sub>	D <sub>3</sub>	G <sub>4</sub>	G <sub>5</sub>			
13	200	135	335	190	335	190	195	335	480	2000	135	
14	210	140	335	210	335	210	215	335	480	2570	140	
15	230	210	380	230	380	230	235	380	550	3430	210	63
16	240	215	380	240	380	240	245	380	550	3660	215	63
17	250	290	415	250	415	250	260	415	600	4650	290	63
18	270	300	415	275	415	280	285	415	600	5130	300	63
19	290	320	465			285	295	465	670	6600	320	100
20	300	340	465			310	315	465	670	7500	340	100
21	320	320	490			330	335	490	715	8900	320	100
22	340	340	490			340	345	490	725	9600	340	100
23	360	470	540			370	375	540	800	11600	470	150
24	380	500	540			390	395	540	825	13000	500	150

## 2 CH3产品参数 Overview tables

CH3齿轮箱额定输出扭矩 Nominal output torque of low speed shaft T<sub>2N</sub> (kNm)

i <sub>N</sub>	齿轮箱规格 Gear unit sizes																			
	05	06	07	08	09	10	11	12	13	14	15	16	17	18	19	20	21	22	23	24
22.4											150		196		296		414		630	
25	11.4		21.4		35.1		62.5		87		150	170	196	236	296	340	414	463	630	714
28	11.4		21.4		35.1		62.5		87		150	170	196	236	296	340	414	463	630	714
31.5	11.4	15.2	21.4	26.7	35.1	42.9	62.5	76	87	107	150	170	196	236	296	340	414	463	630	714
35.5	11.4	15.2	21.4	26.7	35.1	42.9	62.5	76	87	107	150	170	196	36	296	340	414	463	630	714
40	11.4	15.2	21.4	26.7	35.1	42.9	62.5	76	87	107	150	170	196	236	296	340	414	463	630	714
45	11.4	15.2	21.4	26.7	35.1	42.9	62.5	76	87	107	150	170	196	236	296	340	414	463	630	714
50	11.4	15.2	21.4	26.7	35.1	42.9	62.5	76	87	107	150	170	196	236	296	340	414	463	630	714
56	11.4	15.2	21.4	26.7	35.1	42.9	62.5	76	87	107	150	170	196	236	296	340	414	463	630	714
63	11.4	15.2	21.4	26.7	35.1	42.9	62.5	76	87	107	150	170	196	236	296	340	414	463	630	714
71	11.4	15.2	21.4	26.7	35.1	42.9	62.5	87	107	150	170	196	236	296	340	414	463	630	714	
80	11.4	15.2	21.4	26.7	35.1	42.9	62.5	76	87	107	150	170	196	222	296	340	414	463	630	714
90	11.4	15.2	19.7	26.7	33.9	42.9	62.5	76	87	107	150	170	196	236	296	340	414	463	630	714
100		14.2		26.7		42.9		76		107		170		236		340		463		714
112		14.7		24.7		42		76		107										

CH3齿轮箱实际传动比 Actual ratios i for types CH3

i <sub>N</sub>	齿轮箱规格 Gear unit sizes																				
	05	06	07	08	09	10	11	12	13	14	15	16	17	18	19	20	21	22	23	24	
22.4											21.5		21.7		22.0		22.4		22.1		22.2
25	24.9		24.6		24.4		25.9		24.0		24.3	24.7	24.7	24.5	24.7	25.2	25.4	25.4	25.5	24.7	
28	27.6		27.9		27.8		28.8		27.0	27.0	27.4	27.7	27.8	27.5	26.7	27.8	28.7	29.1	28.9	28.3	
31.5	31.6	31.2	30.8	31.1	30.7	30.7	31.9	30.7	30.7	30.7	31.2	31.2	31.7	31.0	30.1	30.1	32.2	33.0	32.4	32.1	
35.5	35.1	35.1	33.9	35.0	34.6	35.1	35.2	34.5	34.3	34.5	35.6	35.6	35.6	35.3	34.0	33.8	36.7	37.0	35.2	36.0	
40	40.2	40.2	38.4	39.7	38.4	38.9	38.7	37.9	38.6	38.9	39.4	40.9	39.4	41.4	38.4	37.9	41.6	40.5	40.4	39.4	
45	45.1	44.9	43.3	45.3	43.7	44.6	42.8	43.3	43.6	43.1	45.3	45.2	45.3	45.9	42.8	42.8	47.2	45.9	45.6	45.3	
50	50.4	52.2	49.4	51.3	5	49.4	49.0	48.6	48.4	47.9	50.3	51.1	50.3	49.6	48.2	48.7	53.3	52.7	50.3	51.1	
56	55.5	57.5	54.9	56.9	56.1	55.4	55.4	54.8	55.0	54.4	55.3	56.9	55.3	55.2	54.3	4.9	58.7	59.4	58.7	56.4	
63	59.4	65.4	61.4	62.8	63.5	61.1	64.9	60.5	62.3	61.1	62.0	62.5	62.0	60.7	60.7	61.8	63.8	65.6	64.9	63.7	
71	67.6	71.5	67.7	70.9	7	69.1	71.5	68.0	69.9	68.7	71.0	70.1	71.0	68.0	69.0	69.2	70.6	71.2	73.3	70.5	
80	77.1	76.6	78.5	79.4	79.2	78.3	80.9	79.7	79.1	77.8	82.0	80.2	82.0	77.8	78.2	78.6	79.1	78.8	82.2	80.9	
90	91.8	87.3	87.8	92.0	86.6	88.6	86.7	92.5	86.8	88.1	89.1	92.7	92.7	9	89.1	89.1	85.1	88.3	89.0	90.7	
100		95.4		98.6		98.3		101.8		99.0		99.0		100.1		10		99.6		100.3	
112		113.7		110.3		107.5		109.1		108.6											

CH3齿轮箱额定功率 Nominal power ratings P<sub>2N</sub>

n <sub>1</sub>	i <sub>N</sub>	齿轮箱规格 Gear unit sizes																											
		05	06	07	08	09	10	11	12	13	14	15	16	17	18	19	20	21	22	23	24								
1500	22.4																	636		1086		1397		2078		2946		4459	
	25	72		137		226		379		570		969	1080	1247	1511	1882	2123	2564	2867	3881	4548								
	28	65		120		199		340		506	623	860	964	1107	1348	1740	1923	2263	2496	3425	3959								
	31.5	57	77	109	135	179	219	308	389	445	548	754	856	970	1197	1546	1777	2019	2203	3056	3494								
	35.5	51	68	99	120	159	192	279	346	398	487	662	750	865	1049	1366	1580	1773	1965	2815	3117								
	40	45	59	88	106	144	173	254	315	354	432	598	654	782	895	1210	1410	1562	1798	2450	2846								
	45	40	53	78	93	126	151	229	276	313	390	520	591	680	808	1087	1249	1378	1584	2171	2476								
	50	36	46	68	82	110	136	200	246	282	351	468	522	612	747	965	1096	1221	1381	1968	2194								
	56	32	42	61	74	98	122	177	218	248	309	426	469	556	671	857	973	1107	1223	1687	1989								
	63	30	37	55	67	87	110	151	197	219	275	380	427	497	611	766	864	1020	1109	1524	1761								
	71	26	33	50	59	79	97	137	175	195	245	332	381	434	545	660	772	899	1022	1234	1591								
	80	23	31	43	53	70	86	121	150	173	216		333		448		659		913		1262								
90	20	27	35	46	61	76	113	129	157	191	264		332		522		764		1112										
100		23		43		69		117		170		270		370		534		730		1119									
112		20		35		61		109		155																			
1000	22.4																	424		724		931		1385		1964		2973	
	25	48		91		151		252		380		646	720	831	1007	1255	1415	1709	1911	2588	3032								
	28	43		80		132		227		337	415	573	642	738	899	1160	1282	1509	1664	2284	2639								
	31.5	38	51	73	90	120	146	205	260	296	365	503	570	647	798	1031	1185	1346	1468	2037	2329								
	35.5	34	45	66	80	106	128	186	231	266	325	441	500	577	700	911	1053	1182	1310	1877	2078								
	40	30	40	58	70	96	115	169	210	236	288	399	436	521	596	806	940	1042	1198	1633	1897								
	45	26	35	52	62	84	101	153	184	209	260	347	394	453	539	725	833	918	1056	1447	1651								
	50	24	31	45	54	74	91	133	164	188	234	312	348	408	498	643	731	814	920	1312	1463								
	56	22	28	41	49	66	81	118	145	166	206	284	313	371	448	571	648	738	816	1125	1326								
	63	20	24	36	45	58	74	101	132	146	183	253	285	331	407	511	576	680	740	1016	1174								
	71	18	22	33	39	53	65	92	117	130	163	221	254	289	363	440	515	599	681	822	1061								
	80	15	21	29	35	46	57	81	100	115	144		222		299		439		609		841								
90	13	18	23	30	41	51	75	86	105	127	176		221		348		509		741										
100		16		28		46		78		113		180		247		356		487		746									
112		14		23		41		73		103																			
750	22.4																		318		543		699		1039		1473		2229
	25	36		68		113		189		285		484	540	623	755	941	1061	1282	1434	1941	2274								
	28	32		60		99		170		253	311	430	482	553	674	870	962	1131	1248	1713	1980								
	31.5	28	38	54	67	90	110	154	195	222	274	377	428	485	598	773	889	1009	1101	1528	1747								
	35.5	26	34	50	60	80	96	139	173	199	243	331	375	432	525	683	790	886	983	1408	1559								
	40	22	30	44	53	72	87	127	157	177	216	299	327	391	447	605	705	781	899	1225	1423								
	45	20	27	39	46	63	76	115	138	157	195	260	295	340	404	544	624	689	792	1085	1238								
	50	18	23	34	41	55	68	100	123	141	176	234	261	306	373	482	548	610	690	984	1097								
	56	16	21	31	37	49	61	89	109	124	154	213	235	278	336	428	486	553	612										

CH3齿轮箱无冷却措施的许用热功率 Thermal capacities Without Other Auxiliary Cooling P <sub>G1</sub> (kW)																
n <sub>1</sub>	i <sub>N</sub>	齿轮箱规格 Gear unit sizes														
		05	06	07	08	09	10	11	12	13	14	15	16	17	18	
1500	22.5~45	PG1	44	53	68	79	91	99	132	151	166	192	223	227	224	227
	50~71	PG1	39	45	57	68	82	88	120	144	162	188	230	243	234	249
	80~112	PG1	36	40	54	58	74	75	110	124	148	161	211	221	215	226
1000	22.5~45	PG1	41	49	64	75	86	94	128	149	167	194	237	245	246	254
	50~71	PG1	36	41	53	62	75	81	110	130	150	174	216	229	221	237
	80~112	PG1	33	36	49	52	68	68	100	112	136	146	196	203	201	357
750	22.5~45	PG1	38	45	59	68	79	87	119	139	157	183	227	236	239	310
	50~71	PG1	32	37	48	56	68	73	100	121	136	159	198	210	203	351
	80~112	PG1	30	32	44	47	61	61	92	102	123	132	179	184	184	305

CH3齿轮箱带风扇冷却的许用热功率 Thermal capacities With fan P <sub>G2</sub> (kW)																
n <sub>1</sub>	i <sub>N</sub>	齿轮箱规格 Gear unit sizes														
		05	06	07	08	09	10	11	12	13	14	15	16	17	18	
1500	22.5~45	PG2	76	90	120	140	162	177	247	283	306	355	450	460	448	460
	50~71	PG2	65	75	99	116	142	153	213	256	279	325	422	447	422	450
	80~112	PG2	61	66	92	98	127	127	194	216	255	274	383	397	384	397
1000	22.5~45	PG2	60	71	95	110	128	141	199	229	250	291	390	383	397	397
	50~71	PG2	51	59	77	91	110	119	166	200	219	255	333	353	334	357
	80~112	PG2	48	51	71	76	99	99	151	168	199	213	301	310	302	310
750	22.5~45	PG2	51	60	81	95	109	120	170	197	216	252	330	342	338	351
	50~71	PG2	43	50	65	77	94	100	140	169	186	216	283	301	285	305
	80~112	PG2	40	43	60	64	84	83	128	141	168	180	255	262	257	263

注意 NOTE

- PG1: 齿轮箱内部存油, 飞溅润滑, 无额外冷却措施情况下许用热功率;
- PG2: 齿轮箱内部存油, 飞溅润滑, 带风扇冷却情况下许用热功率;
- 表中数值按每小时工作周期 100%, 室内大空间安装, 海拔高度至 1000m 得来的; 如果现场条件不同, 需对许用热功率进行修正, 所选齿轮箱的热功率必须满足:  $P_2 \times f_4 \times f_5 \times f_6 \leq PG$ ;
- 如无冷却措施许用热功率PG1或风扇冷却许用热功率PG2不能满足, 请联系重齿公司提供盘管冷却方案或强制润滑方案;
- 一般情况下, 电机功率  $\geq 500kW$  时建议采用强制润滑方案;

- PG1: Thermal capacities Without Other Auxiliary Cooling
- PG2: Thermal capacities With fan cooling
- The values in the table are obtained under conditions of 100% duty per hour, indoor large space installation and altitude of up to 1000m. if the on-site conditions are different, the values should be adjusted.
- Thermal capacities must satisfy:  $P_2 \times f_4 \times f_5 \times f_6 \leq PG$ ;
- If the thermal capacities PG1 PG2 is not suitable, please contact with Chongqing Gearbox Co., Ltd. for cooling solution.
- Generally, a forced lubrication solution is suggested when motor power  $P_1 \geq 500kW$ .

CH3齿轮箱规格05~12外形尺寸(卧式安装)

Dimension of gear unit of size 05-12 (horizontal mounting)

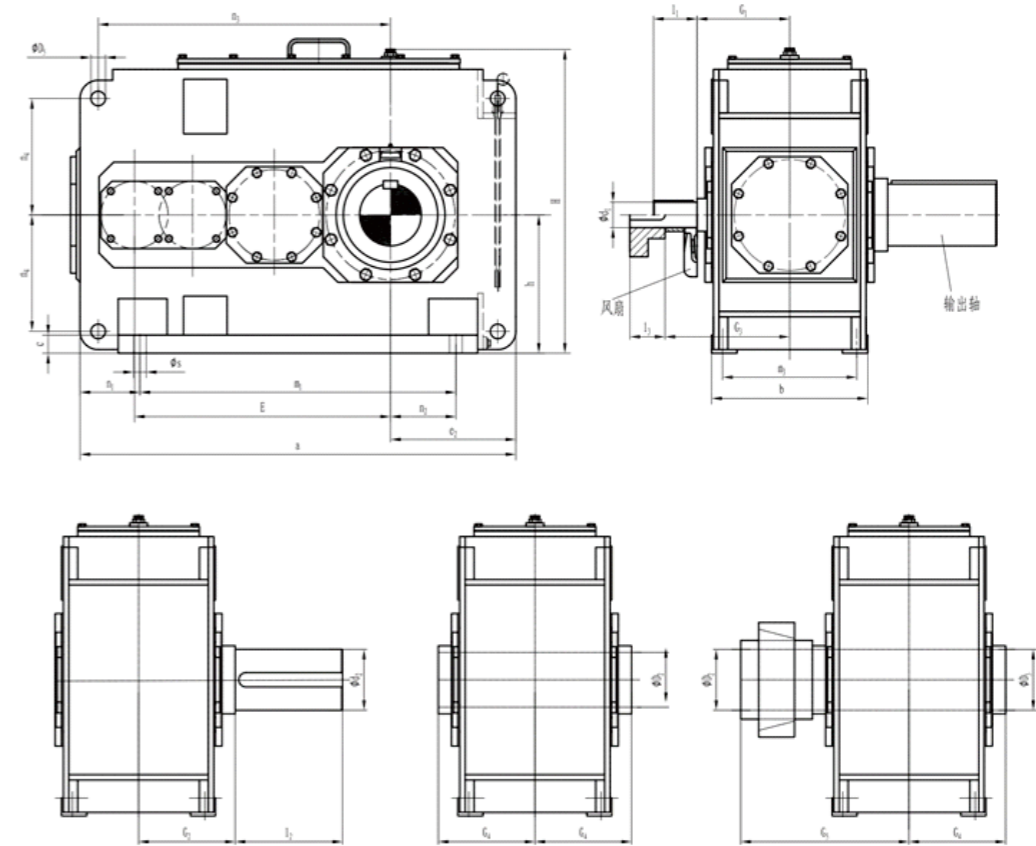

CH3SH	CH3HH	CH3DH
(实心轴平键/solid shaft)	(空心轴平键/Hollow Shaft)	(空心轴锁紧盘/Hollow Shaft with shrink Disk)

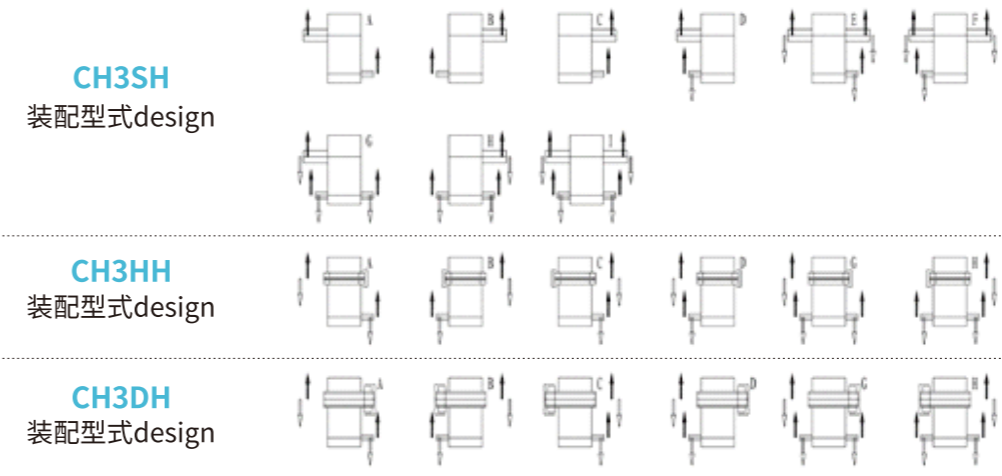

CH3齿轮箱规格05-12外形尺寸(卧式安装) Dimension of gear unit of size 05-12 (horizontal mounting)														
规格 size	尺寸代号 Symbol													
	a	b	c	D <sub>s</sub>	E	H	h <sub>0.5</sub>	m <sub>1</sub>	m <sub>3</sub>	n <sub>1</sub>	n <sub>2</sub>	n <sub>3</sub>	n <sub>4</sub>	s
05	690	255	28	24	405	500	230	480	220	105	100	455	180	19
06	740	255	28	24	440	500	230	560	220	105	145	490	180	19
07	845	300	35	28	495	610	280	605	260	120	130	560	215	24
08	950	300	35	28	540	610	280	710	260	120	190	605	215	24
09	1000	370	40	36	580	690	320	710	320	145	155	660	245	28
10	1100	370	40	36	630	690	320	810	320	145	205	710	245	28
11	1200	430	50	40	705	815	380	870	370	165	180	805	300	35
12	1355	430	50	40	775	815	380	1025	370	165	265	875	300	35

CH3齿轮箱规格05-12输入轴尺寸(卧式安装) input shaft dimensions of size 05-12 (horizontal mounting)																				
规格 size	i <sub>N</sub> =25-45			i <sub>N</sub> =50-63			i <sub>N</sub> =71-90			i <sub>N</sub> =31.5-56			i <sub>N</sub> =63-80			i <sub>N</sub> =90-112			G <sub>1</sub>	G <sub>3</sub>
	d <sub>1</sub>	l <sub>1</sub>	l <sub>3</sub>	d <sub>1</sub>	l <sub>1</sub>	l <sub>3</sub>	d <sub>1</sub>	l <sub>1</sub>	l <sub>3</sub>	d <sub>1</sub>	l <sub>1</sub>	l <sub>3</sub>	d <sub>1</sub>	l <sub>1</sub>	l <sub>3</sub>	d <sub>1</sub>	l <sub>1</sub>	l <sub>3</sub>		
05	40	70	70	30	50	50	24	40	40										160	220
06										40	70	70	30	50	50	24	40	40	160	220
07	45	80	80	35	60	60	28	50	50										185	250
08										45	80	80	35	60	60	28	50	50	185	250
09	60	125	105	45	100	80	32	80	60										230	300
10										60	125	105	45	100	80	32	80	60	230	300
11	70	120	120	50	80	80	42	70	70										255	330
12										70	120	120	50	80	80	42	70	70	255	330

CH3齿轮箱规格05-12输出轴尺寸(卧式安装) output shaft dimensions of size 05-12 (horizontal mounting)												
规格 size	齿轮箱输出轴尺寸(卧式安装) output shaft dimensions (horizontal mounting)									质量 weight (kg)	油量 oil quantity (L)	油站型号 oil station size (L/min)
	输出实心轴平键 solid shaft			输出空心轴平键 Hollow Shaft			输出空心轴锁紧盘 Hollow Shaft with shrink Disk					
	d <sub>2</sub>	l <sub>2</sub>	G <sub>2</sub>	D <sub>2</sub>	G <sub>4</sub>	D <sub>2</sub>	D <sub>3</sub>	G <sub>4</sub>	G <sub>5</sub>			
05	100	210	165	95	165	100	100	165	240	320	15	
06	110	210	165	105	165	110	110	165	240	365	18	
07	120	210	195	115	195	120	120	195	280	540	29	
08	130	250	195	125	195	130	130	195	285	620	32	
09	140	250	235	135	235	140	145	235	330	875	48	
10	160	300	235	150	235	150	155	235	350	1020	49	
11	170	300	270	165	270	165	170	270	400	1400	85	
12	180	300	270	180	270	180	185	270	405	1675	90	

CH3齿轮箱规格13-24外形尺寸(卧式安装)

Dimension of gear unit of size 13-24 (horizontal mounting)

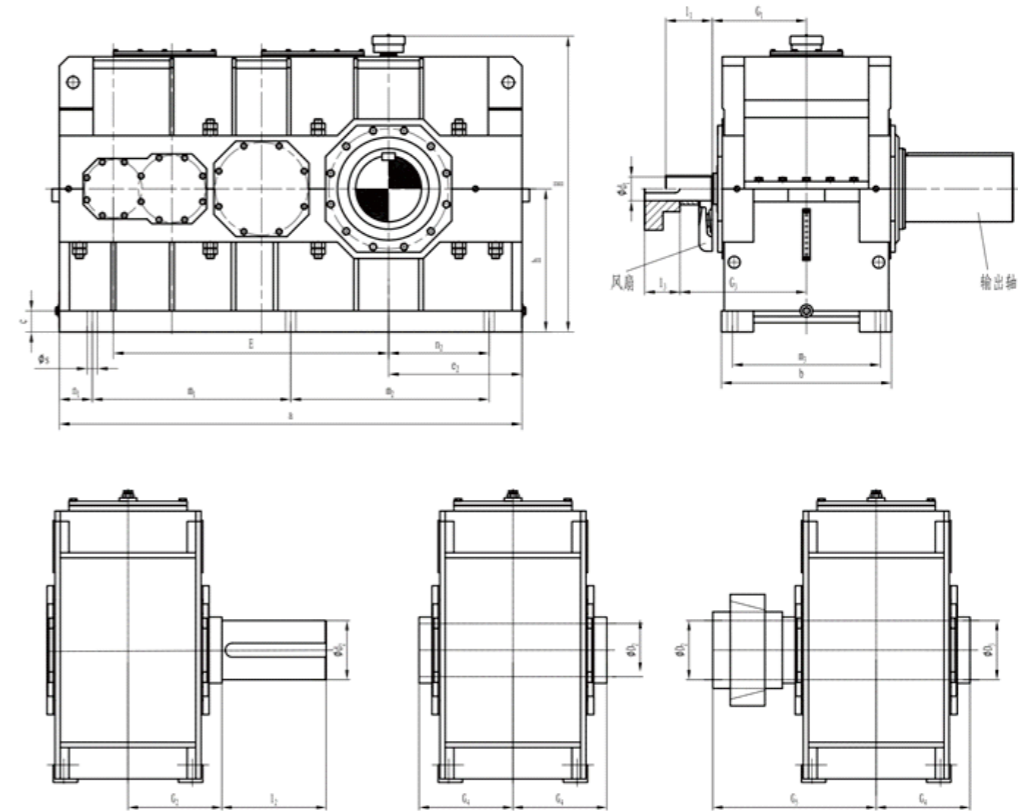

CH3SH CH3HH CH3DH

(实心轴平键/solid shaft) (空心轴平键/Hollow Shaft) (空心轴锁紧盘/Hollow Shaft with shrink Disk)

CH3SH  
装配型式design



CH3HH  
装配型式design



CH3DH  
装配型式design

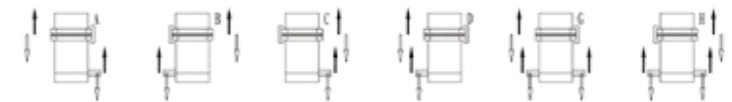

CH3齿轮箱规格13-24外形尺寸(卧式安装) Dimension of gear unit of size 13-24 (horizontal mounting)															
规格 size	尺寸代号 Symbol														
	a	b	c	D <sub>5</sub>	E	H	h <sub>0.5</sub>	m <sub>1</sub>	m <sub>2</sub>	m <sub>3</sub>	n <sub>1</sub>	n <sub>2</sub>	n <sub>3</sub>	n <sub>4</sub>	s
13	1395	550	60	48	820	900	440	597.5	597.5	475	100	305	940	340	35
14	1535	550	60	48	890	900	440	597.5	737.5	475	100	375	101	340	35
15	1680	625	70	55	987	1000	500	720	720	535	120	365	1135	375	42
16	1770	625	70	55	1033	1000	500	720	810	535	120	410	1180	375	42
17	1770	690	80	55	1035	1110	550	750	750	600	135	390	1175	425	42
18	1890	690	80	55	1095	1110	550	750	870	600	135	450	1235	425	42
19	2030	790	90	65	1190	1240	620	860	860	690	155	435	1365	475	48
20	2150	790	90	65	1250	1240	620	860	980	690	155	495	1425	475	48
21	2340	830	100	75	1387	1390	700	1000	1000	720	170	485	1600	520	56
22	2450	830	100	75	1442	1390	700	1000	1110	720	170	540	1655	520	56
23	2530	930	115	80	1505	1565	780	1085	1085	810	180	550	1725	580	56
24	2660	930	115	80	1570	1565	780	1085	1215	810	180	615	1790	580	56

CH3齿轮箱规格13-24输入轴尺寸(卧式安装) input shaft dimensions of size 13-24 (horizontal mounting)																					
规格 size	i <sub>N</sub> =22.4~45/ i <sub>N</sub> =22.4~40*			i <sub>N</sub> =50~63/ i <sub>N</sub> =45~56*			i <sub>N</sub> =71~90/ i <sub>N</sub> =63~90*			i <sub>N</sub> =25~50/ i <sub>N</sub> =25~45*/ i <sub>N</sub> =28~56**			i <sub>N</sub> =56~71/ i <sub>N</sub> =50~63*/ i <sub>N</sub> =63~80**			i <sub>N</sub> =80~100/ i <sub>N</sub> =71~100*/ i <sub>N</sub> =90~112**			G <sub>1</sub>	G <sub>3</sub>	
	d <sub>1</sub>	l <sub>1</sub>	l <sub>3</sub>	d <sub>1</sub>	l <sub>1</sub>	l <sub>3</sub>	d <sub>1</sub>	l <sub>1</sub>	l <sub>3</sub>	d <sub>1</sub>	l <sub>1</sub>	l <sub>3</sub>	d <sub>1</sub>	l <sub>1</sub>	l <sub>3</sub>	d <sub>1</sub>	l <sub>1</sub>	l <sub>3</sub>			
13	85	160	130	60	135	105	50	110	80										310	385	
14**										85	160	130	60	135	105	50	110	80		310	385
15	100	200	165	75	140	105	60	140	105											350	420
16										100	200	165	75	140	105	60	140	105		350	420
17	100	200	165	75	140	105	60	140	105											380	450
18										100	200	165	75	140	105	60	140	105		380	450
19	110	200	165	90	165		75	140												430	
20										110	200		90	165		75	140			430	
21	130	240		110	205		90	170												470	
22										130	240		110	205		90	170			470	
23*	130	255	200	110	220	165	90	185	130											515	570
24*										130	255	200	110	220	165	90	185	130		515	570

CH3齿轮箱规格13-24输出轴尺寸(卧式安装) output shaft dimensions of size 13-24 (horizontal mounting)												
规格 size	输出实心轴平键 solid shaft			输出空心轴平键 Hollow Shaft		输出空心轴锁紧盘 Hollow Shaft with shrink Disk			质量 weight (kg)	油量 oil quantity (L)	油站型号 oil station size (L/min)	
	d <sub>2</sub>	l <sub>2</sub>	G <sub>2</sub>	D <sub>2</sub>	G <sub>4</sub>	D <sub>2</sub>	D <sub>3</sub>	G <sub>4</sub>				G <sub>5</sub>
13	200	350	335	190	335	190	195	335	480	2295	160	
14	210	350	335	210	335	210	215	335	480	2625	165	
15	230	410	380	230	380	230	235	380	550	3475	235	63
16	240	410	380	240	380	240	245	380	550	3875	245	63
17	250	410	415	250	415	250	260	415	600	4560	305	63
18	270	470	415	275	415	280	285	415	600	5030	315	63
19	290	470	465			285	295	465	670	6700	420	100
20	300	500	465			310	315	465	670	8100	450	100
21	320	500	490			330	335	490	715	9100	470	100
22	340	550	490			340	345	490	725	9800	490	100
23	360	590	540			370	375	540	800	11800	620	150
24	380	590	540			390	395	540	825	13200	650	150

## 3 CH4产品参数 Overview tables

CH4齿轮箱额定输出扭矩 Nominal output torque of low speed shaft T <sub>2N</sub> (kNm)																		
i <sub>N</sub>	齿轮箱规格 Gear unit sizes																	
	07	08	09	10	11	12	13	14	15	16	17	18	19	20	21	22	23	24
100	21.4		35.1		60.4		89		150		196		296		414		630	
112	21.4		35.1		60.4		89		150	170	196	236	296	340	414	463	630	714
125	21.4	26.7	35.1	43.3	60.4	77	89	111	150	170	196	236	296	340	414	463	630	714
140	21.4	26.7	35.1	43.3	60.4	77	89	111	150	170	196	236	296	340	414	463	630	714
160	21.4	26.7	35.1	43.3	60.4	77	89	111	150	170	196	236	296	340	414	463	630	714
180	21.4	26.7	35.1	43.3	60.4	77	89	111	150	170	196	236	296	340	414	463	630	714
200	21.4	26.7	35.1	43.3	60.4	77	89	111	150	170	196	236	296	340	414	463	630	714
224	21.4	26.7	35.1	43.3	60.4	77	89	111	150	170	196	236	296	340	414	463	630	714
250	21.4	26.7	35.1	43.3	60.4	77	89	111	150	170	196	236	296	340	414	463	630	714
280	21.4	26.7	35.1	43.3	60.4	77	89	111	150	170	196	236	296	340	414	463	630	714
315	21.4	26.7	35.1	43.3	60.4	77	89	111	150	170	196	236	296	340	414	463	630	714
355	19.3	26.7	35.1	43.3	60.4	77	89	111	137	170	188	236	290	340	404	463	576	714
400		26.7		43.3		77		111		155		219		330		458		650
450		24.8		42		77		111										

CH4齿轮箱实际传动比i Actual ratios i for types CH4																		
i <sub>N</sub>	齿轮箱规格 Gear unit sizes																	
	07	08	09	10	11	12	13	14	15	16	17	18	19	20	21	22	23	24
100	97.7		97.7		99.4		96.4		96.3		97.8		94.6		101.4		103.3	
112	107.4		11		109.7		107.6		109.7	109.7	109.7	108.9	107.1	106.4	115.5	116.5	112.1	114.7
125	121.5	125.6	122.0	123.7	120.6	118.9	121.1	121.9	124.7	124.7	124.7	123.8	121.7	120.9	128.4	129.6	124.7	127.6
140	138.7	143.4	139.7	141.6	138.0	136.2	134.4	135.3	137.0	137.0	137.0	136.0	137.1	136.2	141.7	142.9	137.5	140.7
160	157.3	162.6	156.0	158.1	157.5	155.4	153.9	154.9	157.5	157.3	157.5	159.5	152.5	152.5	160.7	156.2	160.4	154.2
180	177.6	184.3	177.4	175.2	174.3	174.1	173.7	171.8	174.3	174.1	174.3	176.6	172.2	172.2	184.6	179.6	176.3	177.2
200	200.9	204.6	201.7	196.6	192.2	196.6	191.4	195.4	197.3	196.5	197.3	199.3	191.1	195.8	202.9	198.7	202.6	177.2
224	223.0	225.5	226.4	216.7	217.0	216.6	217.7	219.3	222.7	222.4	222.7	225.6	217.3	217.3	224.6	218.4	224.2	215.5
250	245.9	255.2	249.4	246.4	239.1	238.8	244.3	241.6	247.2	251.6	247.2	244.2	243.9	247.6	257.1	250.6	256.7	247.4
280	275.2	285.3	282.3	279.0	275.8	269.2	276.7	271.9	276.9	282.0	276.9	273.7	272.8	276.9	279.1	272.1	29	279.5
315	319.1	319.4	302.4	315.8	295.5	310.6	313.1	308.0	324.6	330.5	324.6	320.8	309.0	313.6	312.8	304.9	325.0	313.2
355	368.2	370.3	342.3	338.3	334.5	332.7	350.3	348.6	352.4	366.8	366.8	356.0	352.0	352.0	336.6	349.0	351.9	358.5
400		419.8		385.6		385.8		394.6		391.6		396.0		395.4		393.8		396.5
450		454.4		427.8		424.8		443.4										

CH4齿轮箱额定功率 Nominal power ratings P <sub>2N</sub>																			
n <sub>1</sub>	i <sub>N</sub>	齿轮箱规格 Gear unit sizes																	
		07	08	09	10	11	12	13	14	15	16	17	18	19	20	21	22	23	24
1500	100	34		56		95		145		245		315		491		641		958	
	112	31		50		87		130		215	243	281	340	434	502	563	624	883	977
	125	28	33	45	55	79	102	115	143	189	214	247	300	382	442	506	561	794	879
	140	24	29	39	48	69	89	104	129	172	195	225	273	339	392	459	509	720	797
	160	21	26	35	43	60	78	91	113	150	170	195	232	305	350	405	465	617	727
	180	19	23	31	39	54	69	80	101	135	153	177	210	270	310	352	405	561	633
	200	17	21	27	35	49	62	73	89	119	136	156	186	243	273	320	366	488	633
	224	15	19	24	31	44	56	64	80	106	120	138	164	214	246	290	333	441	520
	250	14	16	22	28	40	51	57	72	95	106	125	152	191	216	253	290	385	453
	280	12	15	20	24	34	45	51	64	85	95	111	135	170	193	233	267	341	401
	315	11	13	18	22	32	39	45	57	73	81	95	116	150	170	208	239	304	358
	355	8	11	16	20	28	36	40	50	61	73	81	104	129	152	189	208	257	313
	400		10		18		31		44		62		87		131		183		257
	450		9		15		28		39										
1000	100	23		38		64		97		163		210		328		427		639	
	112	21		33		58		87		143	162	187	227	289	335	375	416	589	652
	125	18	22	30	37	52	68	77	95	126	143	165	200	255	294	338	374	529	586
	140	16	20	26	32	46	59	69	86	115	130	150	182	226	261	306	339	480	531
	160	14	17	24	29	40	52	61	75	100	113	130	155	203	233	270	310	411	485
	180	13	15	21	26	36	46	54	68	90	102	118	140	180	207	235	270	374	422
	200	11	14	18	23	33	41	49	59	80	91	104	124	162	182	214	244	326	422
	224	10	12	16	21	29	37	43	53	71	80	92	110	143	164	193	222	294	347
	250	9	11	15	18	26	34	38	48	64	71	83	101	127	144	169	193	257	302
	280	8	10	13	16	23	30	34	43	57	63	74	90	114	129	155	178	227	267
	315	7	9	12	14	21	26	30	38	48	54	63	77	100	114	139	159	203	239
	355	5	8	11	13	19	24	27	33	41	49	54	69	86	101	126	139	171	209
	400		7		12		21		29		41		58		87		122		172
	450		6		10		19		26										
750	100	17		28		48		73		122		157		246		321		479	
	112	16		25		43		65		107	122	140	170	217	251	282	312	441	489
	125	14	17	23	27	39	51	58	71	94	107	123	150	191	221	253	281	397	439
	140	12	15	20	24	34	44	52	64	86	97	112	136	170	196	230	254	360	398
	160	11	13	18	22	30	39	45	56	75	85	98	116	152	175	202	233	308	364
	180	9	11	16	19	27	35	40	51	68	77	88	105	135	155	176	203	281	317
	200	8	10	14	17	25	31	37	45	60	68	78	93	122	136	160	183	244	317
	224	8	9	12	16	22	28	32	40	53	60	69	82	107	123	145	166	221	260
	250	7	8	11	14	20	25	29	36	48	53	62	76	95	108	126	145	193	227
	280	6	7	10	12	17	22	25	32	43	47	56	68	85	96	116	134	171	201
	315	5	7	9	11	16	19	22	28	36	40	47	58	75	85	104	119	152	179
	355	4	6	8	10	14	18	20	25	31	36	40	52	65	76	94	104	129	156
	400		5		9		16		22		31		43		66		91		129
	450		4		8		14		20										

CH4齿轮箱无冷却措施的许用热功率 Thermal capacities Without Other Auxiliary Cooling P <sub>G1</sub> (kW)															
n <sub>1</sub>	i <sub>N</sub>	齿轮箱规格 Gear unit sizes													
			07	08	09	10	11	12	13	14	15	16	17	18	
1500	80-140	P <sub>G1</sub>	41	47	56	62	86	103	113	132	152	159	169	177	
	160-250	P <sub>G1</sub>	34	40	48	53	72	87	98	112	128	135	143	151	
	280-450	P <sub>G1</sub>	32	34	45	46	67	74	90	96	120	123	133	138	
1000	80-140	P <sub>G1</sub>	36	42	50	55	76	92	100	118	136	142	151	158	
	160-250	P <sub>G1</sub>	30	35	43	46	63	77	87	99	113	120	126	133	
	280-450	P <sub>G1</sub>	28	30	40	41	59	65	79	85	106	109	118	121	
750	80-140	P <sub>G1</sub>	33	38	45	50	70	84	92	107	124	130	138	145	
	160-250	P <sub>G1</sub>	28	32	39	42	58	70	79	91	103	109	115	122	
	280-450	P <sub>G1</sub>	26	28	36	37	54	59	72	77	97	100	107	111	

注意 NOTE

- PG1: 齿轮箱内部存油, 飞溅润滑, 无额外冷却措施情况下许用热功率;
- PG2: 齿轮箱内部存油, 飞溅润滑, 带风扇冷却情况下许用热功率;
- 表中数值按每小时工作周期 100%, 室内大空间安装, 海拔高度至 1000m 得来的; 如果现场条件不同, 需对许用热功率进行修正, 所选齿轮箱的热功率必须满足:  $P_2 \times f_4 \times f_5 \times f_6 \leq P_G$ ;
- 如无冷却措施许用热功率PG1或风扇冷却许用热功率PG2不能满足, 请联系重齿公司提供盘管冷却方案或强制润滑方案;
- 一般情况下, 电机功率  $\geq 500kW$  时建议采用强制润滑方案;

- PG1: Thermal capacities Without Other Auxiliary Cooling
- PG2: Thermal capacities With fan cooling
- The values in the table are obtained under conditions of 100% duty per hour, indoor large space installation and altitude of up to 1000m. if the on-site conditions are different, the values should be adjusted.
- Thermal capacities must satisfy:  $P_2 \times f_4 \times f_5 \times f_6 \leq P_G$ ;
- If the thermal capacities PG1 PG2 is not suitable, please contact with Chongqing Gearbox Co., Ltd. for cooling solution.
- Generally, a forced lubrication solution is suggested when motor power  $P_1 \geq 500kW$ .

**CH4齿轮箱规格07~12外形尺寸(卧式安装)**

Dimension of gear unit of size 07-12 (horizontal mounting)

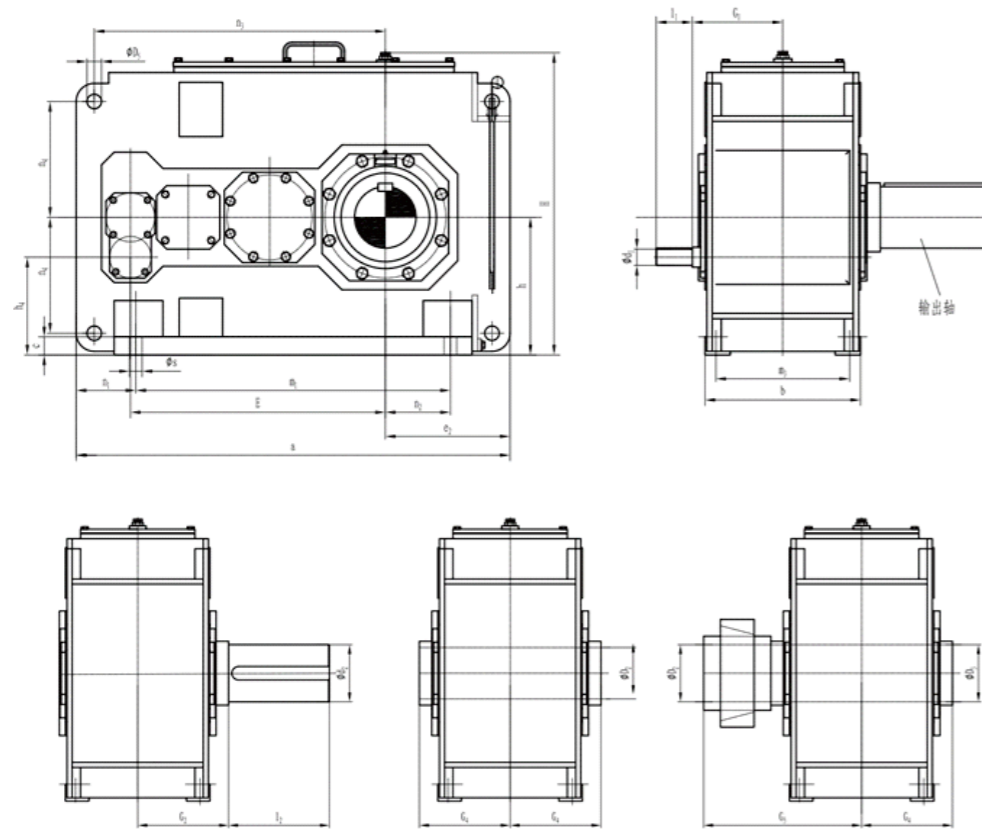

CH4SH

CH4HH

CH4DH

(实心轴平键/solid shaft) (空心轴平键/Hollow Shaft) (空心轴锁紧盘/Hollow Shaft with shrink Disk)

**CH4SH**  
装配型式design



**CH4HH**  
装配型式design



**CH4DH**  
装配型式design



CH4齿轮箱规格07-12外形尺寸(卧式安装) Dimension of gear unit of size 07-12 (horizontal mounting)

规格 size	尺寸代号 Symbol													
	a	b	c	D <sub>5</sub>	E	H	h <sub>0.5</sub>	m <sub>1</sub>	m <sub>3</sub>	n <sub>1</sub>	n <sub>2</sub>	n <sub>3</sub>	n <sub>4</sub>	s
07	845	300	35	28	495	610	280	605	260	120	130	560	215	24
08	950	300	35	28	540	610	280	710	260	120	190	605	215	24
09	1000	370	40	36	580	690	320	710	320	145	155	660	245	28
10	1100	370	40	36	630	690	320	810	320	145	205	710	245	28
11	1200	430	50	40	705	815	380	870	370	165	180	805	300	35
12	1355	430	50	40	775	815	380	1025	370	165	265	875	300	35

CH4齿轮箱规格07-12输入轴尺寸(卧式安装) input shaft dimensions of size 07-12 (horizontal mounting)

规格 size	i <sub>N</sub> =100-180		i <sub>N</sub> =200-355		i <sub>N</sub> =125-224		i <sub>N</sub> =250-450		G <sub>1</sub>
	d <sub>1</sub>	l <sub>1</sub>	d <sub>1</sub>	l <sub>1</sub>	d <sub>1</sub>	l <sub>1</sub>	d <sub>1</sub>	l <sub>1</sub>	
07	30	50	24	40					180
08					30	50	24	40	180
09	35	60	28	50					215
10					35	60	28	50	215
11	45	100	32	80					250
12					45	100	32	80	250

CH4齿轮箱规格07-12输出轴尺寸(卧式安装) output shaft dimensions of size 07-12 (horizontal mounting)

规格 size	齿轮箱输出轴尺寸(卧式安装) output shaft dimensions (horizontal mounting)									质量 weight (kg)	油量 oil quantity (L)	油站型号 oil station size (L/min)
	输出实心轴平键 solid shaft			输出空心轴平键 Hollow Shaft		输出空心轴锁紧盘 Hollow Shaft with shrink Disk						
	d <sub>2</sub>	l <sub>2</sub>	G <sub>2</sub>	D <sub>2</sub>	G <sub>4</sub>	D <sub>2</sub>	D <sub>3</sub>	G <sub>4</sub>	G <sub>5</sub>			
07	120	210	195	115	195	120	120	195	280	550	25	
08	130	250	195	125	195	130	130	195	285	645	27	
09	140	250	235	135	235	140	145	235	330	870	48	
10	160	300	235	150	235	150	155	235	350	1010	50	
11	170	300	270	165	270	165	170	270	400	1460	80	
12	180	300	270	180	270	180	185	270	405	1720	87	

**CH4齿轮箱规格13~24外形尺寸(卧式安装)**

Dimension of gear unit of size 13-24 (horizontal mounting)

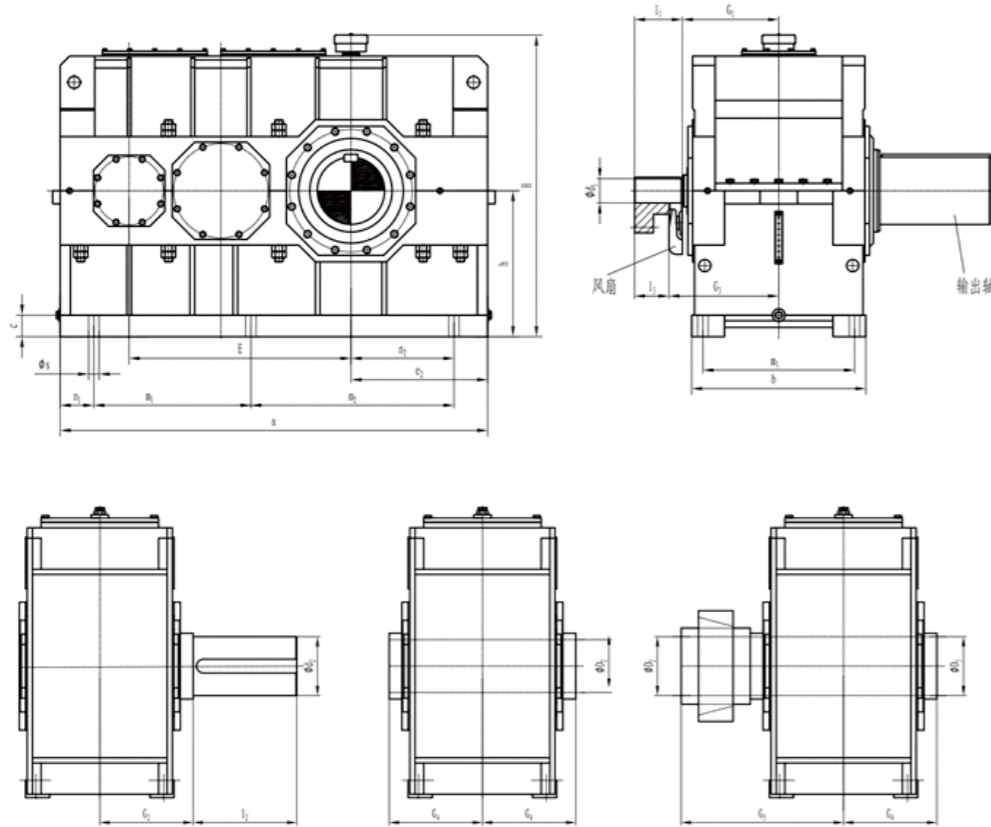

CH4SH

CH4HH

CH4DH

(实心轴平键/solid shaft) (空心轴平键/Hollow Shaft) (空心轴锁紧盘/Hollow Shaft with shrink Disk)

**CH4SH**  
装配型式design



**CH4HH**  
装配型式design



**CH4DH**  
装配型式design



CH4齿轮箱规格13-24外形尺寸(卧式安装) Dimension of gear unit of size 13-24 (horizontal mounting)

规格 size	尺寸代号 Symbol														
	a	b	c	D <sub>5</sub>	E	H	h <sub>0.5</sub>	m <sub>1</sub>	m <sub>2</sub>	m <sub>3</sub>	n <sub>1</sub>	n <sub>2</sub>	n <sub>3</sub>	n <sub>4</sub>	s
13	1395	550	60	48	820	900	440	597.5	597.5	475	100	305	940	340	35
14	1535	550	60	48	890	900	440	597.5	737.5	475	100	375	1010	340	35
15	1680	625	70	55	987	1000	500	720	720	535	120	365	1135	375	42
16	1770	625	70	55	1033	1000	500	720	810	535	120	410	1180	375	42
17	1770	690	80	55	1035	1110	550	750	750	600	135	390	1175	425	42
18	1890	690	80	55	1095	1110	550	750	870	600	135	450	1235	425	42
19	2030	790	90	65	1190	1240	620	860	860	690	155	435	1365	475	48
20	2150	790	90	65	1250	1240	620	860	980	690	155	495	1425	475	48
21	2340	830	100	75	1387	1390	700	1000	1000	720	170	485	1600	520	56
22	2450	830	100	75	1442	1390	700	1000	1110	720	170	540	1655	520	56
23	2530	930	115	80	1505	1565	780	1085	1085	810	180	550	1725	580	56
24	2660	930	115	80	1570	1565	780	1085	1215	810	180	615	1790	580	56

CH4齿轮箱规格13-24输入轴尺寸(卧式安装) input shaft dimensions of size 13-24 (horizontal mounting)

规格 size	i <sub>N</sub> =100~180		i <sub>N</sub> =200~355		i <sub>N</sub> =125~224		i <sub>N</sub> =250~450		i <sub>N</sub> =100~180		i <sub>N</sub> =224~400		G <sub>1</sub>
	d <sub>1</sub>	l <sub>1</sub>	d <sub>1</sub>	l <sub>1</sub>	d <sub>1</sub>	l <sub>1</sub>	d <sub>1</sub>	l <sub>1</sub>	d <sub>1</sub>	l <sub>1</sub>	d <sub>1</sub>	l <sub>1</sub>	
13	50	100	38	80									305
14					50	100	38	80					305
15	60	135	50	110									345
16									60	135	50	110	345
17	60	105	50	80									380
18									60	105	50	80	380
19	75	105	60	105									440
20									75	105	60	105	440
21	90	165	70	140									460
22									90	165	70	140	460
23	90	165	70	140									515
24									90	165	70	140	515

CH4齿轮箱规格13-24输出轴尺寸(卧式安装) output shaft dimensions of size 13-24 (horizontal mounting)

规格 size	齿轮箱输出轴尺寸(卧式安装) output shaft dimensions (horizontal mounting)									质量 weight (kg)	油量 oil quantity (L)	油站型号 oil station size (L/min)
	输出实心轴平键 solid shaft			输出空心轴平键 Hollow Shaft		输出空心轴锁紧盘 Hollow Shaft with shrink Disk						
	d <sub>2</sub>	l <sub>2</sub>	G <sub>2</sub>	D <sub>2</sub>	G <sub>4</sub>	D <sub>2</sub>	D <sub>3</sub>	G <sub>4</sub>	G <sub>5</sub>			
13	200	350	335	190	335	190	195	335	480	2395	130	
14	210	350	335	210	335	210	215	335	480	2725	140	
15	230	410	380	230	380	230	235	380	550	3635	230	63
16	240	410	380	240	380	240	245	380	550	3965	235	63
17	250	410	415	250	415	250	260	415	600	4680	290	63
18	270	470	415	275	415	280	285	415	600	5180	305	63
19	290	470	465			285	295	465	670	6800	360	100
20	300	500	465			310	315	465	670	8200	380	100
21	320	500	490			330	335	490	715	9200	395	100
22	340	550	490			340	345	490	725	9900	420	100
23	360	590	540			370	375	540	800	12000	520	150
24	380	590	540			390	395	540	825	13500	550	150

# 4 CK2产品参数

Overview tables

CK2齿轮箱额定输出扭矩 Nominal output torque of low speed shaft T<sub>2N</sub> (kNm)

in	齿轮箱规格 Gear unit sizes														
	04	05	06	07	08	09	10	11	12	13	14	15	16	17	18
5	6	9.2		18.7		29.5		45.3		68		120			
5.6	6.1	9.2		18.7		29.5		47.4		69		120	133	192	
6.3	6.1	9.2	11.8	18.7	23.4	29.5	37.5	49.4	58	73	84	128	138	192	
7.1	6.1	9.2	11.8	18.7	23.4	29.5	37.5	51.6	60	75	86	130	142	192	226
8	6.1	9.2	11.8	18.7	23.4	29.5	37.5	53	62	79	90	130	145	192	226
9	6.1	9.2	11.8	18.7	23.4	29.5	37.5	53	64	80	93	130	145	192	226
10	6.1	9.2	11.8	18.7	23.4	29.5	37.5	53	65	80	98	130	145	192	226
11.2	6.1	9.2	11.8	18.7	23.4	29.5	37.5	53	65	80	99	130	145	192	226
12.5			11.8		23.4		37.5		65		99		145		226
14			11.8		23.4		37.5		65		99				

CK2齿轮箱实际传动比i Actual ratios i for types CK2

in	齿轮箱规格 Gear unit sizes														
	04	05	06	07	08	09	10	11	12	13	14	15	16	17	18
5	5.0	5.1		5.0		4.9		5.2		5.0		5.0			
5.6	5.7	5.7		5.7		5.6		5.8		5.6		5.6	5.7	5.7	
6.3	6.1	6.1	6.1	6.1	6.1	6.0	6.0	6.1	6.1	6.1	6.1	6.1	6.1	6.1	
7.1	6.9	6.8	6.8	6.7	6.9	6.7	6.8	6.9	6.8	6.8	6.8	6.9	6.8	6.8	6.8
8	8.0	7.9	7.9	7.8	8.0	7.8	7.9	8.0	7.9	7.9	7.9	8.0	7.9	7.9	7.9
9	8.9	8.8	8.8	8.6	8.9	8.7	8.8	8.9	8.8	8.8	8.8	8.9	8.8	8.8	8.8
10	9.9	9.9	10.2	9.8	10.1	9.9	9.8	9.9	9.9	9.9	9.8	10.1	10.1	10.1	10.3
11.2	11.1	11.1	11.6	11.0	11.4	11.1	11.0	11.1	11.1	11.1	11.0	11.4	11.4	11.4	11.5
12.5			13.1		12.9		12.4		12.6		12.5		12.9		13.1
14			14.3		14.6		14.1		14.2		14.0				

CK2齿轮箱额定功率 Nominal power ratings P<sub>2N</sub>

m	in	齿轮箱规格 Gear unit sizes														
		04	05	06	07	08	09	10	11	12	13	14	15	16	17	18
1500	5	187	287		583		919		1412		2119		3740			
	5.6	169	255		518		817		1313		1911		3324	3684	5319	
	6.3	152	229	294	466	583	735	935	1232	1446	1820	2094	3191	3441	4787	
	7.1	135	204	261	414	518	653	830	1142	1327	1659	1903	2876	3141	4247	5000
	8	120	182	233	369	462	583	741	1047	1225	1560	1778	2568	2864	3792	4464
	9	108	163	209	331	414	522	664	938	1133	1416	1646	2301	2566	3398	4000
	10	96	145	185	294	368	463	589	832	1021	1257	1539	2042	2277	3016	3550
	11.2	86	129	165	262	328	414	526	743	912	1122	1388	1823	2033	2693	3169
	12.5			147		292		467		810		1234		1808		2817
	14			131		259		416		720		1097				
1000	5	125	191		389		613		941		1413		2493			
	5.6	113	170		345		545		875		1274		2216	2456	3546	
	6.3	101	153	196	311	389	490	623	821	964	1213	1396	2127	2294	3191	
	7.1	90	136	174	276	345	435	553	761	885	1106	1268	1917	2094	2832	3333
	8	80	121	155	246	308	388	494	698	816	1040	1185	1712	1909	2528	2976
	9	72	109	139	221	276	348	442	625	755	944	1097	1534	1711	2266	
	10	64	96	124	196	245	309	393	555	681	838	1026	1361	1518	2010	2366
	11.2	57	86	110	175	219	276	351	496	608	748	926	1215	1356	1795	2113
	12.5			98		194		312		540		823		1205		1878
	14			87		173		277		480		731				
750	5	93	143		291		460		706		1060		1870			
	5.6	84	127		259		409		657		956		1662	1842	2659	
	6.3	76	115	147	233	292	368	467	616	723	910	1047	1596	1720	2393	
	7.1	67	102	131	207	259	326	415	571	664	830	951	1438	1571	2124	2500
	8	60	91	117	185	231	291	370	523	612	780	889	1284	1432	1896	2232
	9	54	81	104	165	207	261	332	469	566	708	823	1150	1283	1699	2000
	10	48	72	93	147	184	232	295	416	510	628	770	1021	1139	1508	1775
	11.2	43	65	83	131	164	207	263	372	456	561	694	912	1017	1346	1585
	12.5			74		146		234		405		617		904		1409
	14			65		130		208		360		548				

CK2齿轮箱无冷却措施的许用热功率		Thermal capacities Without Other Auxiliary Cooling P <sub>G1</sub> (kW)															
n1	in	齿轮箱规格 Gear unit sizes															
		04	05	06	07	08	09	10	11	12	13	14	15	16	17	18	
1500	5~8	PG1	39.9	45.1	53.4	53											
	9~14	PG1	33	40.4	46	51	57.4	57.7	63.1								
1000	5~8	PG1	42.8	54.8	67.2	72.1	86.1	87.4	97.7	129	155	154	181	574	586	741	764
	9~14	PG1	33.5	44.4	49	59.8	65.1	74.5	77	114	131	145	168	162	175	169	186
750	5~8	PG1	42.2	55.6	68.6	74.7	90.3	93.1	105	148	186	194	233				
	9~14	PG1	32.7	44.4	48	60.2	65	76.4	78	122	140	165	185	203	214	227	241

CK2齿轮箱带风扇冷却的许用热功率		Thermal capacities With fan P <sub>G2</sub> (kW)															
n1	in	齿轮箱规格 Gear unit sizes															
		04	05	06	07	08	09	10	11	12	13	14	15	16	17	18	
1500	5~8	PG2	117	160	195	236	280	287	321	463	564	646	768	713	775	756	808
	9~14	PG2	89.8	125	135	188	200	232	236	382	428	555	611	641	669	714	749
1000	5~8	PG2	92.9*	128	157	192	229	237	267	400	498	588	705	705	784	793	874
	9~14	PG2	70.3	99.5	106	150	159	187	189	318	353	476	514	581	598	669	691
750	5~8	PG2	78.8	109	134	164	196	203	230	347	435	517	622	632	706	720	798
	9~14	PG2	59.4	84.4	90.6	127	135	160	161	273	303	413	443	510	524	593	610

**注意 NOTE**

- PG1: 齿轮箱内部存油, 飞溅润滑, 无额外冷却措施情况下许用热功率;
- PG2: 齿轮箱内部存油, 飞溅润滑, 带风扇冷却情况下许用热功率;
- 表中数值按每小时工作周期 100%, 室内大空间安装, 海拔高度至 1000m 得来的; 如果现场条件不同, 需对许用热功率进行修正, 所选齿轮箱的热功率必须满足:  $P_2 \times f_4 \times f_5 \times f_6 \leq PG$ ;
- 如无冷却措施许用热功率PG1或风扇冷却许用热功率PG2不能满足, 请联系重齿公司提供盘管冷却方案或强制润滑方案;
- 一般情况下, 电机功率  $\geq 500kW$  时建议采用强制润滑方案;

- PG1: Thermal capacities Without Other Auxiliary Cooling
- PG2: Thermal capacities With fan cooling
- The values in the table are obtained under conditions of 100% duty per hour, indoor large space installation and altitude of up to 1000m. if the on-site conditions are different, the values should be adjusted.
- Thermal capacities must satisfy:  $P_2 \times f_4 \times f_5 \times f_6 \leq PG$ ;
- If the thermal capacities PG1 PG2 is not suitable, please contact with Chongqing Gearbox Co., Ltd. for cooling solution.
- Generally, a forced lubrication solution is suggested when motor power  $P_1 \geq 500kW$ .

**CK2齿轮箱规格04~12外形尺寸(卧式安装)**

Dimension of gear unit of size 04-12 (horizontal mounting)

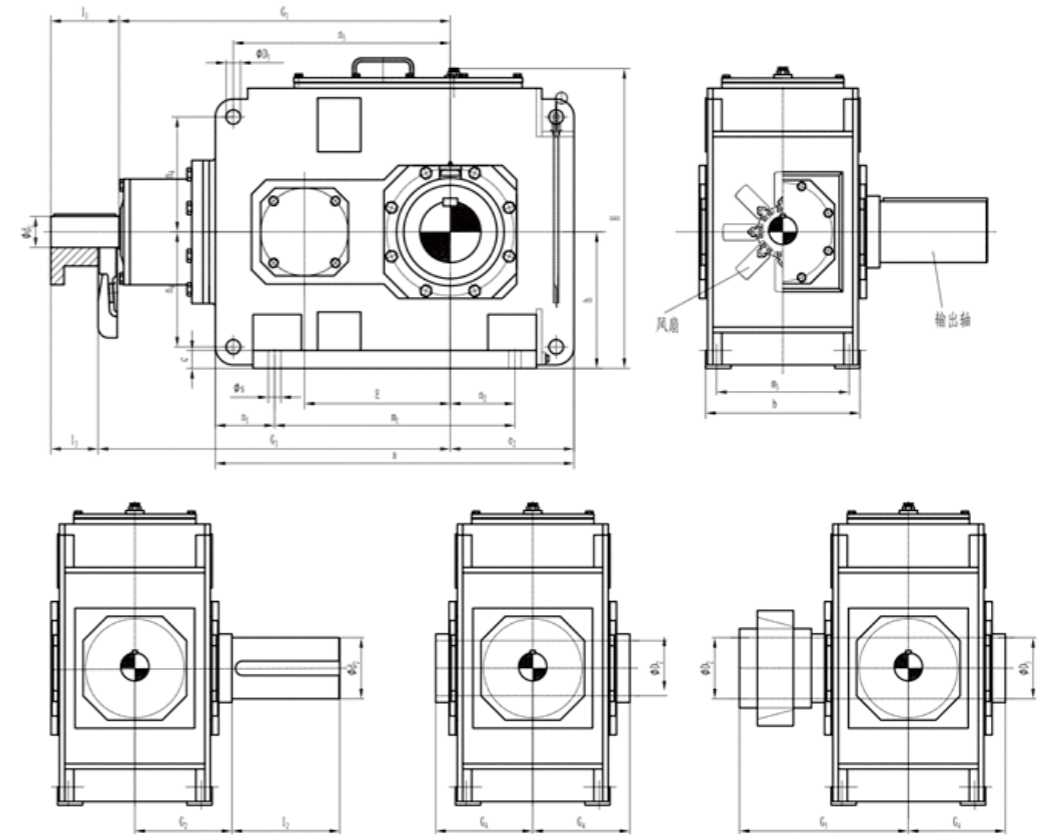

**CK2SH CK2HH CK2DH**

(实心轴平键 / solid shaft) (空心轴平键 / Hollow Shaft) (空心轴锁紧盘 / Hollow Shaft with shrink Disk)

**CK2SH**  
装配型式 design

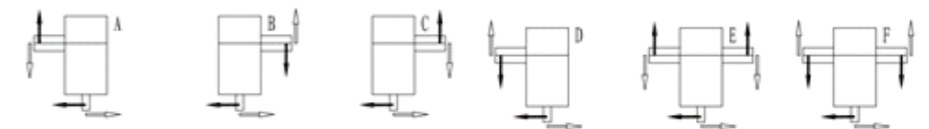

**CK2HH**  
装配型式 design

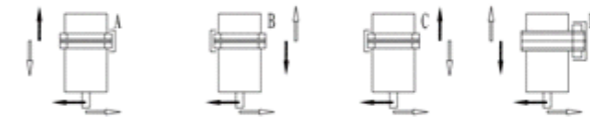

**CK2DH**  
装配型式 design

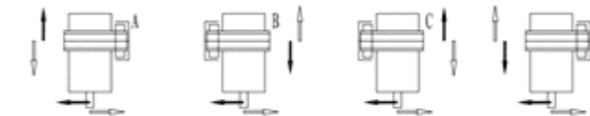

CK2齿轮箱规格04-12外形尺寸(卧式安装) Dimension of gear unit of size 04-12 (horizontal mounting)

规格 size	尺寸代号 Symbol													
	a	b	c	D <sub>5</sub>	E	H	h <sub>0.5</sub>	m <sub>1</sub>	m <sub>3</sub>	n <sub>1</sub>	n <sub>2</sub>	n <sub>3</sub>	n <sub>4</sub>	s
04	505	270	28	24	160	415	200	295	235	105	85	285	150	19
05	565	320	28	24	185	500	230	355	285	105	100	330	180	19
06	645	320	28	24	220	500	230	435	285	105	145	365	180	19
07	690	380	35	28	225	610	280	450	340	120	130	405	215	24
08	795	380	35	28	270	610	280	555	340	120	190	450	215	24
09	820	440	40	36	265	690	320	530	390	145	155	480	245	28
10	920	440	40	36	315	690	320	630	390	145	205	530	245	28
11	975	530	50	40	320	815	380	645	470	165	180	580	300	35
12	1130	530	50	40	390	815	380	800	470	165	265	650	300	35

CK2齿轮箱规格04-12输入轴尺寸(卧式安装) input shaft dimensions of size 04-12 (horizontal mounting)

规格 size	i <sub>n</sub> =5~11.2			i <sub>n</sub> =6.3~14			G <sub>1</sub>	G <sub>3</sub>
	d <sub>1</sub>	l <sub>1</sub>	l <sub>3</sub>	d <sub>1</sub>	l <sub>1</sub>	l <sub>3</sub>		
04	45	100	80				465	485
05	55	110	80				535	565
06				55	110	80	570	600
07	70	135	105				640	670
08				70	135	105	685	715
09	80	165	130				755	790
10				80	165	130	805	840
11	90	165	130				925	960
12				90	165	130	995	1030

CK2齿轮箱规格04-12输出轴尺寸(卧式安装) output shaft dimensions of size 04-12 (horizontal mounting)

规格 size	齿轮箱输出轴尺寸(卧式安装) output shaft dimensions (horizontal mounting)								质量 weight (kg)	油量 oil quantity (L)	油站型号 oil station size (L/min)	
	输出实心轴平键 solid shaft		输出空心轴平键 Hollow Shaft		输出空心轴锁紧盘 Hollow Shaft with shrink Disk							
	d <sub>2</sub>	l <sub>2</sub>	G <sub>2</sub>	D <sub>2</sub>	G <sub>4</sub>	D <sub>2</sub>	D <sub>3</sub>	G <sub>4</sub>	G <sub>5</sub>			
04	80	170	170	80	170	85	85	170	235	235	10	
05	100	210	200	100	200	100	100	200	275	360	15	
06	110	210	200	110	200	110	110	200	275	410	19	
07	120	210	235	120	235	120	120	235	320	615	31	
08	130	250	235	130	235	130	130	235	325	700	34	
09	140	250	270	140	270	140	145	270	365	1000	48	
10	160	300	270	150	270	150	155	270	385	1150	50	
11	170	300	320	165	320	165	170	320	450	1650	79	
12	180	300	320	180	320	180	185	320	455	1910	95	

CK2齿轮箱规格04~12外形尺寸(卧式安装)  
Dimension of gear unit of size 04-12 (horizontal mounting)

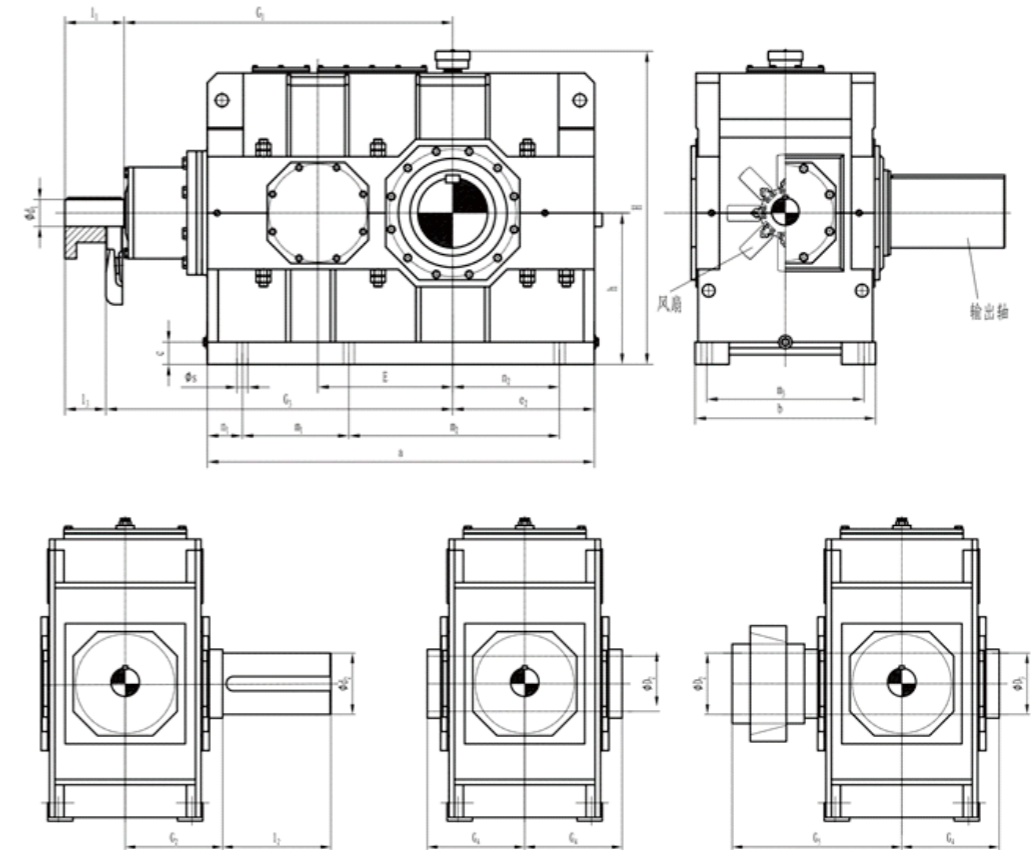

CK2SH CK2HH CK2DH

(实心轴平键/solid shaft) (空心轴平键/Hollow Shaft) (空心轴锁紧盘/Hollow Shaft with shrink Disk)

**CK2SH**  
装配型式design

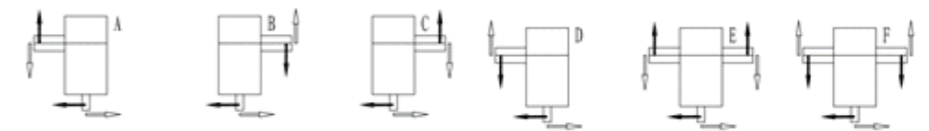

**CK2HH**  
装配型式design



**CK2DH**  
装配型式design

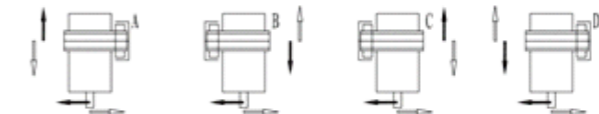



CK2齿轮箱规格13-18外形尺寸(卧式安装) Dimension of gear unit of size 13-18 (horizontal mounting)															
规格 size	尺寸代号 Symbol														
	a	b	c	D <sub>s</sub>	E	H	h <sub>0.5</sub>	m <sub>1</sub>	m <sub>2</sub>	m <sub>3</sub>	n <sub>1</sub>	n <sub>2</sub>	n <sub>3</sub>	n <sub>4</sub>	s
13	1130	655	60	48	370	900	460	465	465	580	100	305	675	340	35
14	1270	655	60	48	440	900	460	465	605	580	100	375	745	340	35
15	1350	765	70	55	442	1000	500	555	555	670	120	365	805	375	42
16	1440	765	70	55	488	1000	500	555	645	670	120	410	850	375	42
17	1490	885	80	65	490	1110	560	610	610	780	135	390	895	420	48
18	1610	885	80	65	550	1110	560	610	730	780	135	450	955	420	48

CK2齿轮箱规格13-18输入轴尺寸(卧式安装) input shaft dimensions of size 13-18 (horizontal mounting)																	
规格 size	i <sub>n</sub> =5~11.2			i <sub>n</sub> =5.6~11.2			i <sub>n</sub> =5.6~12.5			i <sub>n</sub> =6.3~14			i <sub>n</sub> =7.1~12.5			G <sub>1</sub>	G <sub>3</sub>
	d <sub>1</sub>	l <sub>1</sub>	l <sub>3</sub>	d <sub>1</sub>	l <sub>1</sub>	l <sub>3</sub>	d <sub>1</sub>	l <sub>1</sub>	l <sub>3</sub>	d <sub>1</sub>	l <sub>1</sub>	l <sub>3</sub>	d <sub>1</sub>	l <sub>1</sub>	l <sub>3</sub>		
13	110	205	165													1070	1110
14										110	205	165				1140	1180
15	130	245	200													1277	1322
16							130	245	200							1323	1368
17				150	245	200										1435	1480
18													150	245	200	1495	1540

CK2齿轮箱规格13-18输出轴尺寸(卧式安装) output shaft dimensions of size 13-18 (horizontal mounting)												
规格 size	齿轮箱输出轴尺寸(卧式安装) output shaft dimensions (horizontal mounting)									质量 weight (kg)	油量 oil quantity (L)	油站型号 oil station size (L/min)
	输出实心轴平键 solid shaft			输出空心轴平键 Hollow Shaft			输出空心轴锁紧盘 Hollow Shaft with shrink Disk					
	d <sub>2</sub>	l <sub>2</sub>	G <sub>2</sub>	D <sub>2</sub>	G <sub>4</sub>	D <sub>2</sub>	D <sub>3</sub>	G <sub>4</sub>	G <sub>5</sub>			
13	200	350	390							2450	140	
14	210	350	390	210	390	210	215	390	535	2820	160	
15	230	410	460							3980	220	63
16	240	410	460	240	450	240	245	450	520	4345	230	63
17	250	410	540							5620	320	63
18	270	470	540	275	510	280	285	510	700	6150	340	63

## 5 CK3产品参数 Overview tables

CK3齿轮箱额定输出扭矩 Nominal output torque of low speed shaft T <sub>2N</sub> (kNm)																							
i <sub>n</sub>	齿轮箱规格 Gear unit sizes																						
	04	05	06	07	08	09	10	11	12	13	14	15	16	17	18	19	20	21	22	23	24		
12.5	5.4	9.2		16.7		27.5		51.4		78		129		192		246		335					
14	5.9	9.6		179		28.9		55.6		80		134	145	192	226	258	291	355	400				
16	6.5	10.3	11.8	19.5	21.1	30.4	34.9	58.7	66	82	98	139	151	196	226	271	304	375	417				
18	6.6	11.2	12.3	20.8	22.7	33.2	36.8	60.8	69	85	100	145	157	196	236	284	316	395	433				
20	6.6	11.4	12.9	21.4	24.6	35.1	38.5	62.3	72	89	103	150	164	196	236	296	328	415	450	630			
22.4	6.6	11.4	13.9	21.4	26.1	35.1	41.1	62.3	75	89	106	150	170	196	236	296	340	415	465	630	715		
25	6.6	11.4	15.2	21.4	26.7	35.1	42.9	62.3	76	89	111	150	170	196	236	296	340	415	465	630	715		
28	6.6	11.4	15.2	21.4	26.7	35.1	42.9	62.3	76	89	111	150	170	196	236	296	340	415	465	630	715		
31.5	6.6	11.4	15.2	21.4	26.7	35.1	42.9	62.3	76	89	111	150	170	196	236	296	340	415	465	630	715		
35.5	6.6	11.4	15.2	21.4	26.7	35.1	42.9	62.3	76	89	111	150	170	196	236	296	340	415	465	620	715		
40	6.6	11.4	15.2	21.4	26.7	35.1	42.9	62.3	76	89	111	150	170	196	236	296	340	415	465	620	690		
45	6.6	11.4	15.2	21.4	26.7	35.1	42.9	62.3	76	89	111	150	170	196	236	296	340	415	465	620	690		
50	6.6	11.4	15.2	21.4	26.7	35.1	42.9	62.3	76	89	111	150	170	196	236	296	340	415	465	620	690		
56	6.6	11.4	15.2	21.4	26.7	35.1	42.9	62.3	76	89	111	150	170	196	236	296	340	415	465	620	690		
63	6.5	11.2	15.2	21.4	26.7	35.1	42.9	62.3	76	89	111	150	170	196	236	296	340	415	465	620	690		
71	6.5	10.8	15.2	19.7	26.7	33.3	42.9	58.8	76	89	111	150	170	196	236	296	340	415	465	620	690		
80			13.7		26.4		42.9		76		111		170		236		340		465		690		
90			13.7		24.8		42.2		74		111												

CK3齿轮箱实际传动比i Actual ratios i for types CK2																							
i <sub>n</sub>	齿轮箱规格 Gear unit sizes																						
	04	05	06	07	08	09	10	11	12	13	14	15	16	17	18	19	20	21	22	23	24		
12.5	12.7	12.7		12.4		12.3		12.8		12.2		12.7		12.9		12.4		12.3					
14	14.3	14.3		13.9		13.9		14.4		13.7		14.3	14.1	14.5	13.9	14.0	13.9	13.8	14.1				
16	15.4	15.4	15.2	15.0	15.1	15.0	15.0	15.5	15.0	14.8	14.8	15.4	15.6	15.6	15.3	15.1	14.9	14.9	14.9				
18	17.4	17.1	17.1	16.5	17.0	16.8	17.1	17.1	16.9	16.5	16.6	17.5	17.5	17.5	17.4	17.0	16.9	16.9	17.1				
20	19.5	19.3	19.3	18.6	19.2	18.8	19.1	19.6	19.3	18.6	18.7	19.6	19.6	19.6	19.5	19.3	19.2	19.0	19.2	18.7			
22.4	21.5	21.4	21.4	21.1	21.8	21.4	21.7	21.7	21.5	20.9	21.1	22.1	22.1	22.1	22.0	21.6	21.4	21.5	21.7	21.2	21.7		
25	25.0	24.9	24.9	24.5	25.3	24.8	25.2	25.3	24.9	24.3	24.5	25.7	25.7	25.7	25.5	25.1	24.9	24.9	25.1	24.6	25.1		
28	28.5	28.5	28.5	27.7	28.6	27.5	27.9	27.8	27.4	27.4	27.6	28.3	28.3	28.3	28.1	28.0	27.8	28.8	29.0	27.6	28.2		
31.5	31.7	31.9	33.1	31.3	32.5	31.3	30.9	30.7	30.7	30.9	30.6	32.6	32.5	32.6	33.0	31.1	31.1	32.6	31.7	32.2	30.9		
35.5	35.2	35.5	36.8	34.8	36.1	34.8	34.4	34.1	34.2	34.3	34.0	36.2	36.1	36.2	36.7	34.6	34.6	36.2	35.2	35.7	34.3		
40	39.4	40.2	40.2	40.1	40.7	39.4	38.9	38.2	38.4	38.4	38.2	39.3	40.9	40.9	39.7	39.4	39.4	39.0	40.4	38.7	39.4		
45	43.4	44.3	44.3	44.5	45.2	44.2	43.7	43.2	43.4	43.7	43.5	43.5	45.2	45.2	43.9	44.5	44.5	44.3	45.9	44.5	45.3		
50	48.8	49.8	49.8	50.1	50.9	49.8	49.1	48.6	48.8	49.1	48.9	48.9	50.9	50.9	49.4	50.0	50.0	49.8	51.6	50.0	51.0		
56	56.6	56.6	56.7	56.0	56.9	56.3	55.6	56.9	57.2	55.7	55.4	54.8	57.0	57.0	55.4	56.0	56.0	54.1	56.1	56.5	57.6		
63	63.3	55.3	62.1	63.0	61.0	63.6	61.7	63.6	63.0	61.6	62.2	63.0	60.9	61.6	61.6	62.2	62.9	62.6	63.3	63.7	63.7		
71	71.8	62.7	70.4	71.4	69.2	72.0	69.9	72.1	71.4	69.8	70.5	71.4	69.0	69.8	69.8	70.5	71.2	70.9	71.7	72.2	72.2		
80			80.3		78.3		79.4		81.9		79.2		78.3		78.3		78.2		77.8		81.0		
90			90.1		87.6		86.9		87.8		86.8												



CK3齿轮箱无冷却措施的许用热功率 Thermal capacities Without Other Auxiliary Cooling P <sub>G1</sub> (kW)																					
m1	in	PG1	齿轮箱规格 Gear unit sizes																		
			04	05	06	07	08	09	10	11	12	13	14	15	16	17	18	19	20	21	22
1500	12.5~28	PG1	31	43	50	64	75	85	93	109	131	131	155	168	172	183	182	200	*	*	*
	31.5~50	PG1	24	33	37	51	57	70	77	96	115	124	142	174	174	210	204	240	247	260	232
	56~90	PG1	20	28	31	44	48	59	60	80.2	89.6	107	115	155	161	190	196	232	240	261	262
1000	12.5~28	PG1	29	41	48	62	73	84	93	113	140	144	172	205	216	239	248	285	302	301	306
	31.5~50	PG1	23	31	35	48	54	66	74	93	112	122	141	178	179	219	216	256	267	302	283
	56~90	PG1	19	26	28	41	44	55	56	76	85	103	110	151	157	187	193	239	272	276	276
750	12.5~28	PG1	27	38	45	59	69	80	89	109	137	144	172	211	224	252	264	307	328	351	371
	31.5~50	PG1	21	29	32	44	50	62	69	87	106	116	134	172	173	213	211	252	263	306	291
	56~90	PG1	17	24	26	38	41	51	52	71	79	96	103	143	148	178	184	222	228	265	270

CK3齿轮箱带风扇冷却的许用热功率 Thermal capacities With fan P <sub>G2</sub> (kW)																					
m1	in	PG2	齿轮箱规格 Gear unit sizes																		
			04	05	06	07	08	09	10	11	12	13	14	15	16	17	18	19	20	21	22
1500	12.5~28	PG2	64	94	109	143	165	199	220	296	363	380	452	535	562	689	711	828	878	855	869
	31.5~50	PG2	49	69	77	106	119	151	169	232	281	310	358	445	453	593	594	690	730	799	757
	56~90	PG2	40	59	63	92	98	126	127	189	208	258	273	372	384	498	507	615	626	707	710
1000	12.5~28	PG2	49	73	86	112	130	157	174	238	295	312	373	453	480	596	621	731	782	811	857
	31.5~50	PG2	38	54	60	83	93	117	131	181	221	244	283	356	363	478	481	561	595	668	641
	56~90	PG2	31	45	48	71	75	98	99	146	161	201	212	292	301	393	400	487	495	569	574
750	12.5~28	PG2	42	62	72	95	110	133	147	202	251	266	318	389	412	513	536	632	677	710	754
	31.5~50	PG2	32	45	50	70	78	99	111	153	187	207	240	302	309	407	409	478	507	572	551
	56~90	PG2	26	38	41	60	64	83	84	123	136	169	179	247	255	333	338	413	420	484	488

**注意 NOTE**

- PG1: 齿轮箱内部存油, 飞溅润滑, 无额外冷却措施情况下许用热功率;
- PG2: 齿轮箱内部存油, 飞溅润滑, 带风扇冷却情况下许用热功率;
- 表中数值按每小时工作周期 100%, 室内大空间安装, 海拔高度至 1000m 得来的; 如果现场条件不同, 需对许用热功率进行修正, 所选齿轮箱的热功率必须满足:  $P_2 \times f_4 \times f_5 \times f_6 \leq P_1$ ;
- 如无冷却措施许用热功率PG1或风扇冷却许用热功率PG2不能满足, 请联系重齿公司提供盘管冷却方案或强制润滑方案;
- 一般情况下, 电机功率  $\geq 500kW$  时建议采用强制润滑方案;

- PG1: Thermal capacities Without Other Auxiliary Cooling
- PG2: Thermal capacities With fan cooling
- The values in the table are obtained under conditions of 100% duty per hour, indoor large space installation and altitude of up to 1000m. if the on-site conditions are different, the values should be adjusted.
- Thermal capacities must satisfy:  $P_2 \times f_4 \times f_5 \times f_6 \leq P_1$ ;
- If the thermal capacities PG1 PG2 is not suitable, please contact with Chongqing Gearbox Co., Ltd. for cooling solution.
- Generally, a forced lubrication solution is suggested when motor power  $P_1 \geq 500kW$ .

**CK3齿轮箱规格04~12外形尺寸(卧式安装)**

Dimension of gear unit of size 04-12 (horizontal mounting)

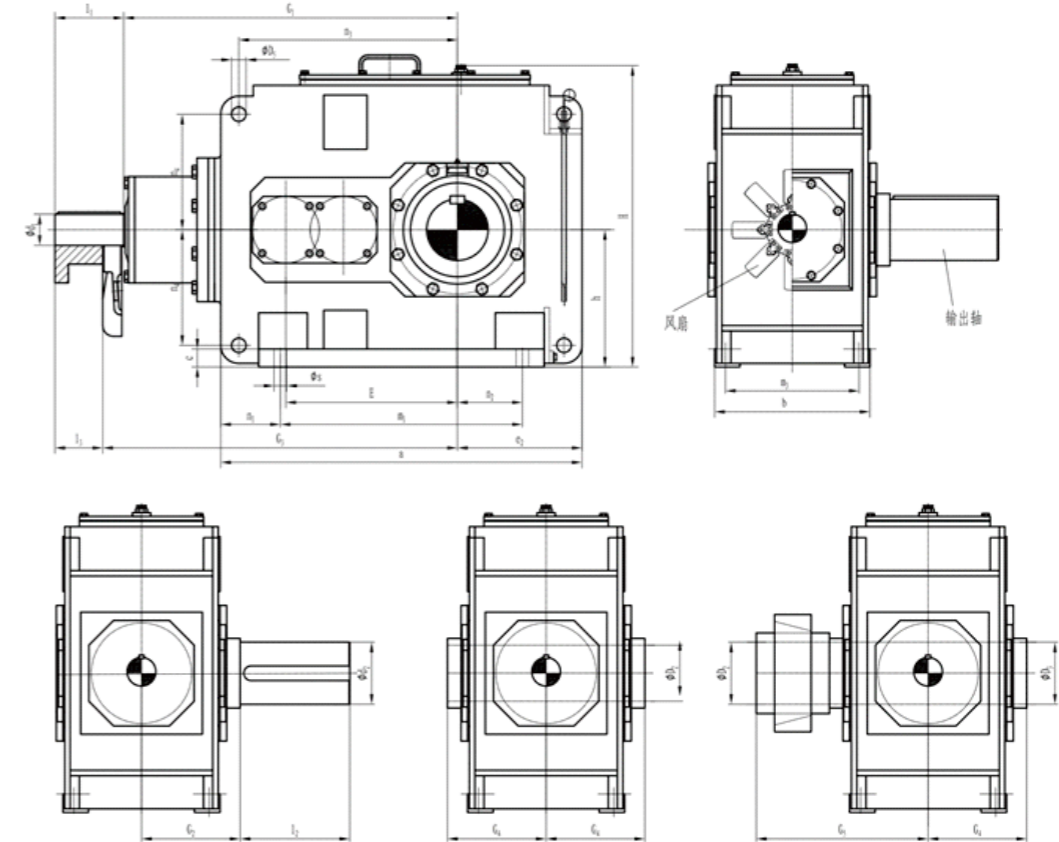

**CK3SH CK3HH CK3DH**

(实心轴平键/solid shaft) (空心轴平键/Hollow Shaft) (空心轴锁紧盘/Hollow Shaft with shrink Disk)

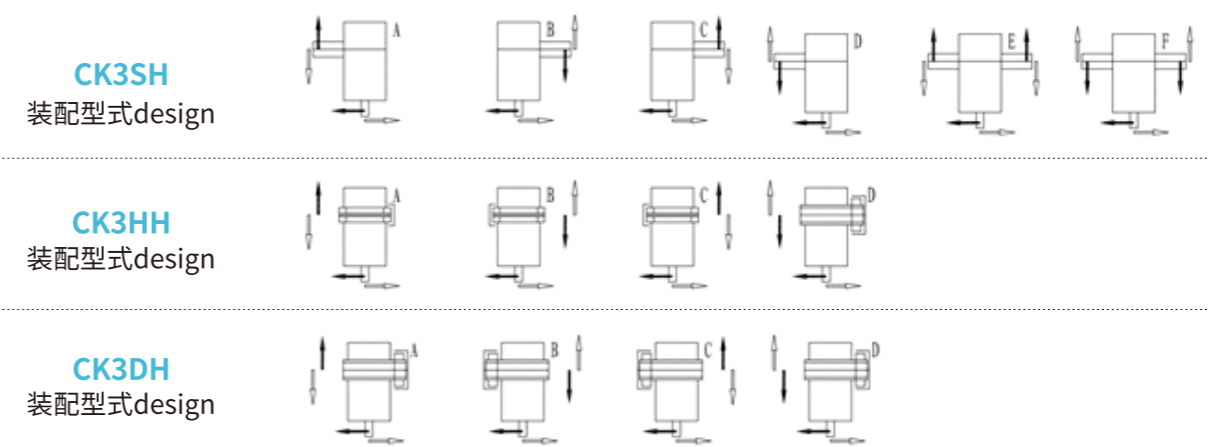

CK3齿轮箱规格04-12外形尺寸(卧式安装) Dimension of gear unit of size 04-12 (horizontal mounting)

规格 size	尺寸代号 Symbol													
	a	b	c	D <sub>5</sub>	E	H	h <sub>0.5</sub>	m <sub>1</sub>	m <sub>3</sub>	n <sub>1</sub>	n <sub>2</sub>	n <sub>3</sub>	n <sub>4</sub>	s
04	565	215	28	24	270	415	200	355	180	105	85	345	150	19
05	640	255	28	24	315	500	230	430	220	105	100	405	180	19
06	720	255	28	24	350	500	230	510	220	105	145	440	180	19
07	785	300	35	28	385	610	280	545	260	120	130	500	215	24
08	890	300	35	28	430	610	280	650	260	120	190	545	215	24
09	925	370	40	36	450	690	320	635	320	145	155	585	245	28
10	1025	370	40	36	500	690	320	735	320	145	205	635	245	28
11	1105	430	50	40	545	815	380	775	370	165	180	710	300	35
12	1260	430	50	40	615	815	380	930	370	165	265	780	300	35

CK3齿轮箱规格04-12输入轴尺寸(卧式安装) input shaft dimensions of size 04-12 (horizontal mounting)

规格 size	i <sub>n</sub> =12.5-45			i <sub>n</sub> =50-71			i <sub>n</sub> =16-56			i <sub>n</sub> =63-90			G <sub>1</sub>	G <sub>3</sub>
	d <sub>1</sub>	l <sub>1</sub>	l <sub>3</sub>	d <sub>1</sub>	l <sub>1</sub>	l <sub>3</sub>	d <sub>1</sub>	l <sub>1</sub>	l <sub>3</sub>	d <sub>1</sub>	l <sub>1</sub>	l <sub>3</sub>		
04	30	70	50	25	60	40							500	520
05	35	80	60	28	60	40							575	595
06							35	80	60	28	60	40	610	630
07	45	100	80	35	80	60							690	710
08							45	100	80	35	80	60	735	755
09	55	110	80	40	100	70							800	830
10							55	110	80	40	100	70	850	880
11	70	135	105	50	110	80							960	990
12							70	135	105	50	110	80	1030	1060

CK3齿轮箱规格04-12输出轴尺寸(卧式安装) output shaft dimensions of size 04-12 (horizontal mounting)

规格 size	齿轮箱输出轴尺寸(卧式安装) output shaft dimensions (horizontal mounting)									质量 weight (kg)	油量 oil quantity (L)	油站型号 oil station size (L/min)
	输出实心轴平键 solid shaft			输出空心轴平键 Hollow Shaft		输出空心轴锁紧盘 Hollow Shaft with shrink Disk						
	d <sub>2</sub>	l <sub>2</sub>	G <sub>2</sub>	D <sub>2</sub>	G <sub>4</sub>	D <sub>2</sub>	D <sub>3</sub>	G <sub>4</sub>	G <sub>5</sub>			
04	80	170	140	80	140	85	85	140	205	210	9	
05	100	210	165	95	165	100	100	165	240	325	14	
06	110	210	165	105	165	110	110	165	240	380	16	
07	120	210	195	115	195	120	120	195	280	550	27	
08	130	250	195	125	195	130	130	195	285	635	30	
09	140	250	235	135	235	140	145	235	330	890	42	
10	160	300	235	150	235	150	155	235	350	1020	45	
11	170	300	270	165	270	165	170	270	400	1455	71	
12	180	300	270	180	270	180	185	270	405	1730	76	

CK3齿轮箱规格13-24外形尺寸(卧式安装)  
Dimension of gear unit of size 13-24 (horizontal mounting)

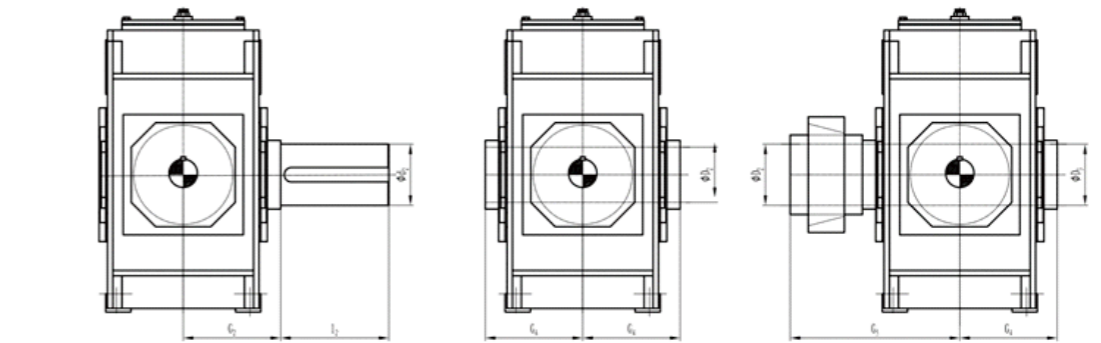
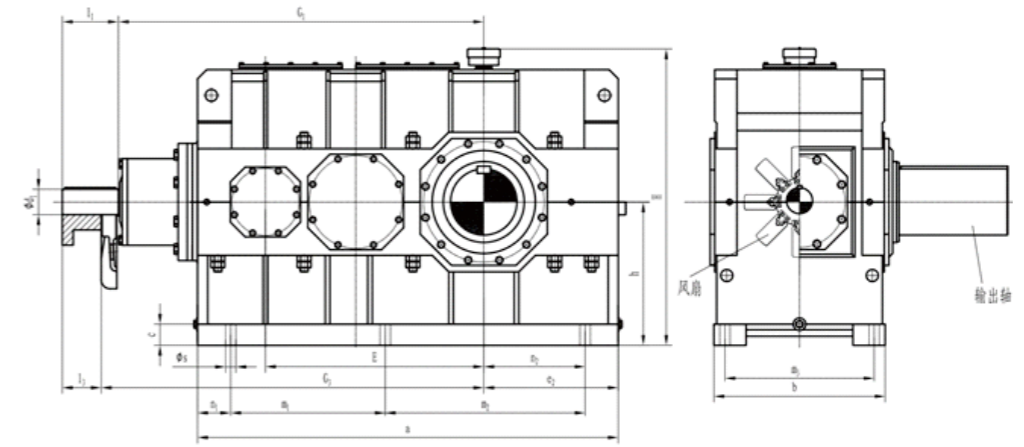

CK3SH CK3HH CK3DH

(实心轴平键/solid shaft) (空心轴平键/Hollow Shaft) (空心轴锁紧盘/Hollow Shaft with shrink Disk)

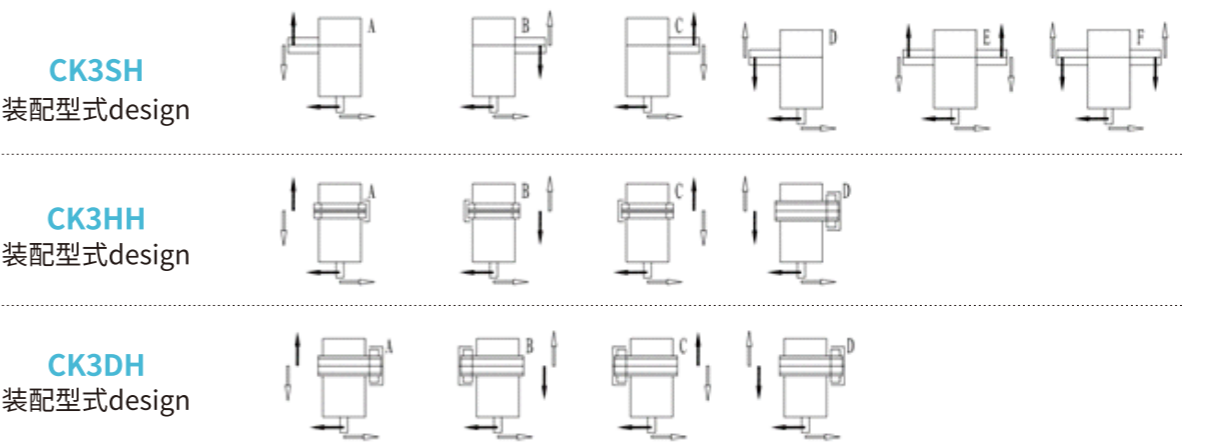

CK3齿轮箱规格13-24外形尺寸(卧式安装) Dimension of gear unit of size 13-24 (horizontal mounting)															
规格 size	尺寸代号 Symbol														
	a	b	c	D <sub>5</sub>	E	H	h <sub>0.5</sub>	m <sub>1</sub>	m <sub>2</sub>	m <sub>3</sub>	n <sub>1</sub>	n <sub>2</sub>	n <sub>3</sub>	n <sub>4</sub>	s
13	1290	550	60	48	635	900	440	545	545	475	100	305	835	340	35
14	1430	550	60	48	705	900	440	545	685	475	100	375	905	340	35
15	1550	625	70	55	762	1000	500	655	655	535	120	365	1005	375	42
16	1640	625	70	55	808	1000	500	655	745	535	120	410	1050	375	42
17	1740	690	80	55	860	1110	550	735	735	600	135	390	1145	425	42
18	1860	690	80	55	920	1110	550	735	855	600	135	450	1205	425	42
19	2010	790	90	65	997	1240	620	850	850	690	155	435	1345	475	48
20	2130	790	90	65	1057	1240	620	850	970	690	155	495	1405	475	48
21	2140	830	100	75	1067	1390	700	900	900	720	170	485	1400	520	56
22	2250	890	100	75	1122	1390	700	900	1010	720	170	540	1455	520	56
23	2380	930	115	80	1185	1565	780	1010	1010	810	180	550	1560	580	56
24	2510	930	115	80	1250	1565	780	1010	1140	810	180	615	1625	580	56

CK3齿轮箱规格13-24输入轴尺寸(卧式安装) input shaft dimensions of size 13-24 (horizontal mounting)																				
规格 size	i <sub>N</sub> =12.5-45			i <sub>N</sub> =50-71			i <sub>N</sub> =16-56			i <sub>N</sub> =63-90			i <sub>N</sub> =14-50			i <sub>N</sub> =56-80			G <sub>1</sub>	G <sub>3</sub>
	d <sub>1</sub>	l <sub>1</sub>	l <sub>3</sub>	d <sub>1</sub>	l <sub>1</sub>	l <sub>3</sub>	d <sub>1</sub>	l <sub>1</sub>	l <sub>3</sub>	d <sub>1</sub>	l <sub>1</sub>	l <sub>3</sub>	d <sub>1</sub>	l <sub>1</sub>	l <sub>3</sub>	d <sub>1</sub>	l <sub>1</sub>	l <sub>3</sub>		
13	80	165	130	60	140	105													1125	1160
14							80	165	130	60	140	105							1195	1230
15	90	165	130	70	140	105													1367	1402
16													90	165	130	70	140	105	1413	1448
17	110	205	165	80	170	130													1560	1600
18													110	205	165	80	170	130	1620	1660
19	130	245	200	100	210	165													1832	1877
20													130	245	200	100	210	165	1892	1937
21	130	245	200	100	210	165													1902	1947
22													130	245	200	100	210	165	1957	2022
规格	i <sub>N</sub> =20-45			i <sub>N</sub> =50-71			i <sub>N</sub> =22.4-50			i <sub>N</sub> =56-80										
23	150	245	200	100	210	165													2130	2175
24							150	245	200	100	210	165							2195	2240

CK3齿轮箱规格13-24输出轴尺寸(卧式安装) output shaft dimensions of size 13-24 (horizontal mounting)													
规格 size	齿轮箱输出轴尺寸(卧式安装) output shaft dimensions (horizontal mounting)									质量 weight (kg)	油量 oil quantity (L)	油站型号 oil station size (L/min)	
	输出实心轴平键 solid shaft			输出空心轴平键 Hollow Shaft			输出空心轴锁紧盘 Hollow Shaft with shrink Disk						
	d <sub>2</sub>	l <sub>2</sub>	G <sub>2</sub>	D <sub>2</sub>	G <sub>4</sub>	D <sub>2</sub>	D <sub>3</sub>	G <sub>4</sub>	G <sub>5</sub>				
13	200	350	335	190	335	190	195	335	480	2380	130		
14	210	350	335	210	335	210	215	335	480	2750	140		
15	230	410	380	230	380	230	235	380	550	3730	210	63	
16	240	410	380	240	380	240	245	380	550	3950	220	63	
17	250	410	415	250	415	250	260	415	600	4990	290	63	
18	270	470	415	275	415	280	285	415	600	5490	300	63	
19	290	470	465			285	295	465	670	7000	380	100	
20	300	500	465			310	315	465	670	8100	420	100	
21	320	500	490			330	335	490	715	9200	430	100	
22	340	550	490			340	345	490	725	9900	490	100	
23	360	590	540			370	375	540	800	12000	630	150	
24	380	590	540			390	395	540	820	13400	730	150	

## 6 CK4产品参数 Overview tables

CK4齿轮箱额定输出扭矩 Nominal output torque of low speed shaft T <sub>2N</sub> (kNm)																				
i <sub>N</sub>	齿轮箱规格 Gear unit sizes																			
	05	06	07	08	09	10	11	12	13	14	15	16	17	18	19	20	21	22	23	24
80	11.4		21.4		35.1		60.4		89		150		196		296		415		630	
90	11.4		21.4		35.1		60.4		89		150	170	196	236	296	340	415	465	630	715
100	11.4	15.2	21.4	26.7	35.1	43.3	60.4	77	89	111	150	170	196	236	296	340	415	465	630	715
112	11.4	15.2	21.4	26.7	35.1	43.3	60.4	77	89	111	150	170	196	236	296	340	415	465	630	715
125	11.4	15.2	21.4	26.7	35.1	43.3	60.4	77	89	111	150	170	196	236	296	340	415	465	630	715
140	11.4	15.2	21.4	26.7	35.1	43.3	60.4	77	89	111	150	170	196	236	296	340	415	465	630	715
160	11.4	15.2	21.4	26.7	35.1	43.3	60.4	77	89	111	150	170	196	236	296	340	415	465	630	715
180	11.4	15.2	21.4	26.7	35.1	43.3	60.4	77	89	111	150	170	196	236	296	340	415	465	630	715
200	11.4	15.2	21.4	26.7	35.1	43.3	60.4	77	89	111	150	170	196	236	296	340	415	465	630	715
224	11.4	15.2	21.4	26.7	35.1	43.3	60.4	77	89	111	150	170	196	236	296	340	415	465	630	715
250	11.4	15.2	21.4	26.7	35.1	43.3	60.4	77	89	111	150	170	196	236	296	340	415	465	620	715
280	11.4	15.2	21.4	26.7	34.6	43.3	60.4	77	89	111	150	170	196	236	296	340	415	465	600	700
315	11	15.2	20.1	26.7	33.3	43.3	58.8	77	89	111	150	170	196	236	296	340	415	465	575	680
355		15.2		26		43.3		77		111		170								
400		15.2		26		43.3		77		111		170								

CK4齿轮箱实际传动比i Actual ratios i for types CK4																				
i <sub>N</sub>	齿轮箱规格 Gear unit sizes																			
	05	06	07	08	09	10	11	12	13	14	15	16	17	18	19	20	21	22	23	24
80	81.2		78.0		78.6		77.1		78.5		81.9		81.9		76.8		83.4		83.3	
90	87.4		83.9		84.6		83.0		84.5		88.1	88.0	88.1	89.3	82.7	82.7	89.8	87.3	89.7	86.2
100	101.5	105.2	97.5	101.2	98.2	97.0	96.4	96.2	98.1	97.0	102.3	102.2	102.3	103.7	96.0	96.0	104.3	101.4	104.1	100.1
112	112.8	116.9	108.3	112.4	109.1	107.8	107.1	106.9	109.0	107.8	113.7	113.6	113.7	115.2	106.7	106.7	115.9	112.7	115.7	111.2
125	126.9	131.5	121.8	126.4	122.8	121.3	120.4	120.3	122.6	121.3	127.9	127.8	127.9	129.6	120.0	120.0	130.3	126.8	130.1	125.1
140	141.6	146.8	139.0	144.3	140.6	138.9	137.9	137.7	136.1	134.6	140.6	140.5	140.6	142.5	135.2	135.2	143.8	139.8	143.5	138.0
160	157.0	157.1	158.3	159.2	158.7	156.9	156.6	155.8	153.8	153.1	150.2	156.3	156.3	151.7	154.6	154.6	158.1	163.9	158.8	161.8
180	176.6	176.7	178.0	179.1	178.6	176.5	176.2	175.3	173.1	172.3	169.0	175.8	175.8	170.7	173.9	173.9	177.8	184.4	178.7	182.0
200	200.2	200.3	201.8	203.0	202.4	200.0	199.7	198.6	196.2	195.2	191.5	199.3	199.3	193.4	197.1	197.1	201.5	209.0	202.5	206.3
224	227.7	227.8	222.5	223.8	223.0	220.4	220.0	218.9	220.1	219.1	216.2	225.0	225.0	218.4	224.1	224.1	223.0	231.3	224.1	228.3
250	259.0	259.1	249.0	250.5	252.4	249.4	253.9	252.5	249.3	248.1	242.2	252.1	252.1	244.7	250.6	250.6	242.2	251.1	253.2	257.9
280	295.2	295.3	288.7	290.4	287.1	283.7	288.8	287.2	282.2	280.9	283.9	295.5	295.5	286.8	283.9	283.9	271.3	281.3	283.7	289.0
315	323.0	323.6	324.4	314.4	324.2	314.7	319.3	316.3	312.4	315.6	326.2	315.5	319.1	319.1	318.9	318.9	306.9	317.5	319.8	319.6
355		363.0		351.6		307.3		355.3		356.2		352.4		356.4		353.1		364.8		345.1
400		394.6		383.1		344.7		398.6		389.8										

CK4齿轮箱额定功率 Nominal power ratings P <sub>2N</sub>																					
n <sub>1</sub>	i <sub>N</sub>	齿轮箱规格 Gear unit sizes																			
		05	06	07	08	09	10	11	12	13	14	15	16	17	18	19	20	21	22	23	24
1500	80	81.2		78.0		78.6		77.1		78.5		81.9		81.9		76.8		83.4		83.3	
	90	87.4		83.9		84.6		83.0		84.5		88.1	88.0	88.1	89.3	82.7	89.8	87.3	89.7	86.2	
	100	101.5	105.2	97.5	101.2	98.2	97.0	96.4	96.2	98.1	97.0	102.3	102.2	102.3	103.7	96.0	96.0	104.3	101.4	104.1	100.1
	112	112.8	116.9	108.3	112.4	109.1	107.8	107.1	106.9	109.0	107.8	113.7	113.6	113.7	115.2	106.7	106.7	115.9	112.7	115.7	111.2
	125	126.9	131.5	121.8	126.4	122.8	121.3	120.4	120.3	122.6	121.3	127.9	127.8	127.9	129.6	120.0	120.0	130.3	126.8	130.1	125.1
	140	141.6	146.8	139.0	144.3	140.6	138.9	137.9	137.7	136.1	134.6	140.6	140.5	140.6	142.5	135.2	135.2	143.8	139.8	143.5	138.0
	160	157.0	157.1	158.3	159.2	158.7	156.9	156.6	155.8	153.8	153.1	150.2	156.3	156.3	151.7	154.6	154.6	158.1	163.9	158.8	161.8
	180	176.6	176.7	178.0	179.1	178.6	176.5	176.2	175.3	173.1	172.3	169.0	175.8	175.8	170.7	173.9	173.9	177.8	184.4	178.7	182.0
	200	200.2	200.3	201.8	203.0	202.4	200.0	199.7	198.6	196.2	195.2	191.5	199.3	199.3	193.4	197.1	197.1	201.5	209.0	202.5	206.3
	224	227.7	227.8	222.5	223.8	223.0	220.4	220.0	218.9	220.1	219.1	216.2	225.0	225.0	218.4	224.1	224.1	223.0	231.3	224.1	228.3
	250	259.0	259.1	249.0	250.5	252.4	249.4	253.9	252.5	249.3	248.1	242.2	252.1	252.1	244.7	250.6	250.6	242.2	251.1	253.2	257.9
	280	295.2	295.3	288.7	290.4	287.1	283.7	288.8	287.2	282.2	280.9	283.9	295.5	295.5	286.8	283.9	283.9	271.3	281.3	283.7	289.0
315	323.0	323.6	324.4	314.4	324.2	314.7	319.3	316.3	312.4	315.6	326.2	315.5	319.1	319.1	318.9	318.9	306.9	317.5	319.8	319.6	
355		363.0		351.6		307.3		355.3		356.2		352.4		356.4		353.1		364.8		345.1	
400		394.6		383.1		344.7		398.6		389.8											
1000	80	15		29		47		82		119		192		251		403		521		792	
	90	14		27		43		76		110		178	202	233	277	375	431	484	558	736	869
	100	12	15	23	28	37	47	66	84	95	120	153	174	201	238	323	371	417	480	634	748
	112	11	14	21	25	34	42	59	75	85	108	138	157	180	215	291	334	375	432	570	673
	125	9	12	18	22	30	37	53	67	76	96	123	139	160	191	258	297	333	384	507	599
	140	8	11	16	19	26	33	46	59	68	86	112	127	146	173	229	263	302	348	460	543
	160	8	10	14	18	23	29	40	52	61	76	105	114	131	163	201	230	275	297	415	463
	180	7	9	13	16	21	26	36	46	54	67	93	101	117	145	178	205	244	264	369	411
	200	6	8	11	14	18	23	32	41	48	60	82	89	103	128	157	181	216	233	326	363
	224	5	7	10	12	16	21	29	37	42	53	73	79	91	113	138	159	195	211	294	328
	250	5	6	9	11	15	18	25	32	37	47	65	71	81	101	124	142	179	194	256	290
	280	4	5	8	10	13	16	22	28	33	41	55	60	69	86	109	125	160	173	221	254
315	4	5	6	9	11	14	19	25	30	37	48	56	64	77	97	112	142	153	188	223	
355		4		8		15		23		33		51		69		101		133		206	
400		4		7		13		20		30											
750	80	11		22		35		62		89		144		188		303		391		594	
	90	10		20		33		57		83		134	152	175	208	281	323	363	418	552	652
	100	9	11	17	21	28	35	49	63	71	90	115	131	150	179	242	278	313	360	475	561
	112	8	10	16	19	25	32	44	57	64	81	104	118	135	161	218	250	281	324	428	505
	125	7	9	14	17	22	28	39	50	57	72	92	104	120	143	194	222	250	288	380	449
	140	6	8	12	15	20	24	34	44	51	65	84	95	109	130	172	198	227	261	345	407
	160	6	8	11	13	17	22	30	39	45	57	78	85	98	122	150	173	206	223	312	347
	180	5	7	9	12	15	19	27	35	40	51	70	76	88	109	134	154	183	198	277	309
	200	4	6	8	10	14	17	24	30	36	45	62	67	77	96	118	135	162	175	244	272
	224	4	5	8	9	12	15	22	28	32	40	54	59	68	85	104	119	146	158	221	246
	250	3	5	7	8	11	14	19	24	28	35	49	53	61	76	93	107	135	145	192	218
	280	3	4	6	7	9	12	16	21	25	31	41	45	52	65	82	94	120	130	166	190
315	3	4	5	7	8	11	14	19	22	28	36	42	48	58	73	84	106	115	141	167	
355		3		6		11		17		24		38		52		76		100		155	
400		3		5		10		15		22											

CK4齿轮箱无冷却措施的许用热功率 Thermal capacities Without Other Auxiliary Cooling P <sub>G1</sub> (kW)																						
n <sub>1</sub>	i <sub>N</sub>		齿轮箱规格 Gear unit sizes																			
			05	06	07	08	09	10	11	12	13	14	15	16	17	18	19	20	21	22		
1500	80-140	PG1	26	31	38	45	54	60	81	98	107	125	139	148	155	165	211	225	294	304		
	160-250	PG1	21	25	31	36	43	48	65	79	87	101	114	120	127	136	176	187	241	252		
	280-400	PG1	19	20	27	29	39	39	58	64	79	84	100	103	113	117	158	162	217	220		
1000	80-140	PG1	24	28	34	40	48	54	76	89	98	114	128	137	144	154	198	211	281	294		
	160-250	PG1	19	22	27	32	38	43	58	71	78	91	102	108	114	122	158	168	217	227		
	280-400	PG1	17	18	24	26	34	35	55	57	70	75	90	93	101	104	140	144	193	196		
750	80-140	PG1	22	26	32	38	45	51	68	83	91	106	119	127	134	143	184	196	262	274		
	160-250	PG1	18	21	25	30	36	40	54	66	72	85	95	100	106	113	147	156	202	212		
	280-400	PG1	16	17	22	24	32	33	48	53	65	70	84	87	95	98	131	134	180	182		

注意 NOTE

- PG1: 齿轮箱内部存油, 飞溅润滑, 无额外冷却措施情况下许用热功率;
- PG2: 齿轮箱内部存油, 飞溅润滑, 带风扇冷却情况下许用热功率;
- 表中数值按每小时工作周期 100%, 室内大空间安装, 海拔高度至 1000m 得来的; 如果现场条件不同, 需对许用热功率进行修正, 所选齿轮箱的热功率必须满足:  $P_2 \times f_4 \times f_5 \times f_6 \leq P_G$ ;
- 如无冷却措施许用热功率PG1或风扇冷却许用热功率PG2不能满足, 请联系重齿公司提供盘管冷却方案或强制润滑方案;
- 一般情况下, 电机功率  $\geq 500kW$  时建议采用强制润滑方案;

- PG1: Thermal capacities Without Other Auxiliary Cooling
- PG2: Thermal capacities With fan cooling
- The values in the table are obtained under conditions of 100% duty per hour, indoor large space installation and altitude of up to 1000m. if the on-site conditions are different, the values should be adjusted.  
Thermal capacities must satisfy:  $P_2 \times f_4 \times f_5 \times f_6 \leq P_G$ ;
- If the thermal capacities PG1 PG2 is not suitable, please contact with Chongqing Gearbox Co., Ltd. for cooling solution.
- Generally, a forced lubrication solution is suggested when motor power  $P \geq 500kW$ .

**CK4齿轮箱规格05~12外形尺寸(卧式安装)**

Dimension of gear unit of size 05-12 (horizontal mounting)

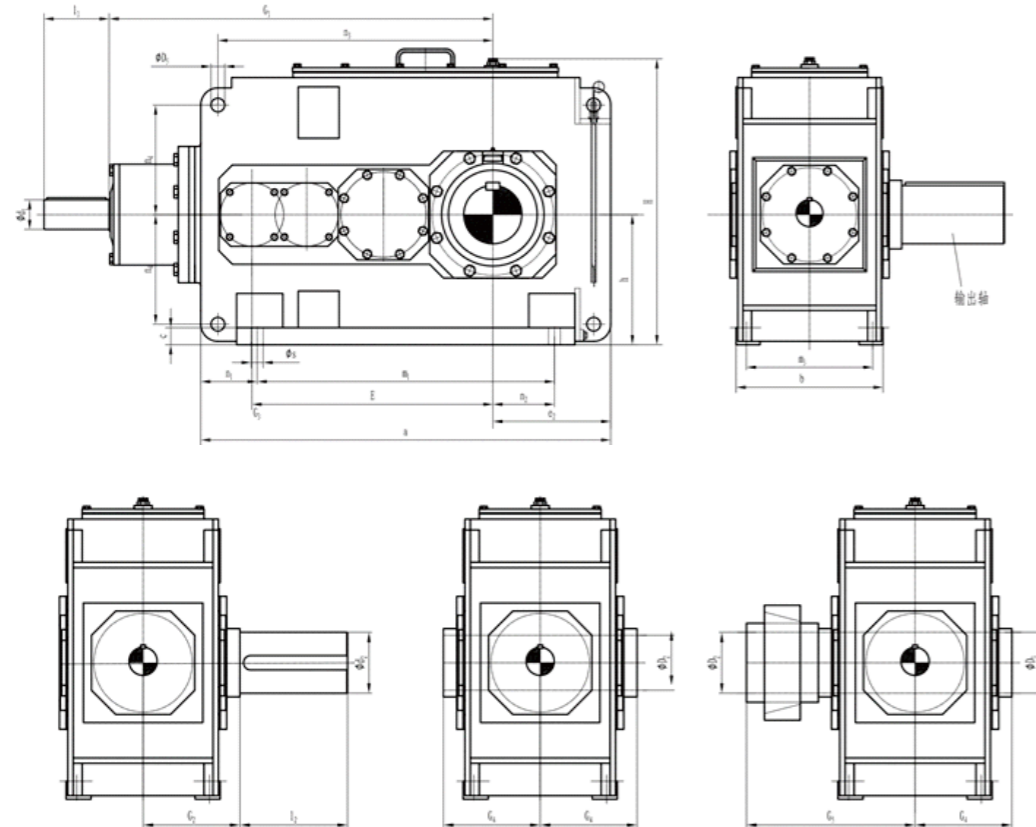

CK4SH

CK4HH

CK4DH

(实心轴平键 /solid shaft) (空心轴平键/Hollow Shaft) (空心轴锁紧盘/Hollow Shaft with shrink Disk)

**CK4SH**  
装配型式design

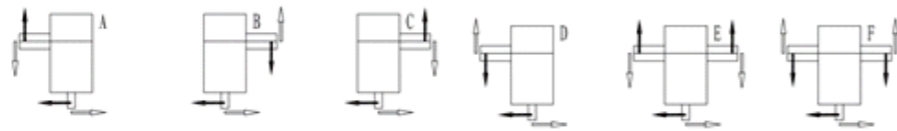

**CK4HH**  
装配型式design



**CK4DH**  
装配型式design



CK4齿轮箱规格05-12外形尺寸(卧式安装) Dimension of gear unit of size 05-12 (horizontal mounting)

规格 size	尺寸代号 Symbol													
	a	b	c	D <sub>5</sub>	E	H	h <sub>0.5</sub>	m <sub>1</sub>	m <sub>3</sub>	n <sub>1</sub>	n <sub>2</sub>	n <sub>3</sub>	n <sub>4</sub>	s
05	690	255	28	24	405	500	230	480	220	105	100	455	180	19
06	770	255	28	24	440	500	230	560	220	105	145	490	180	19
07	845	300	35	28	495	610	280	605	260	120	130	560	215	24
08	950	300	35	28	540	610	280	710	260	120	190	605	215	24
09	1000	370	40	36	580	690	320	710	320	145	155	660	245	28
10	1100	370	40	36	630	690	320	810	320	145	205	710	245	28
11	1200	430	50	40	705	815	380	870	370	165	180	805	300	35
12	1355	430	50	40	775	815	380	1025	370	165	265	875	300	35

CK4齿轮箱规格05-12输入轴尺寸(卧式安装) input shaft dimensions of size 05-12 (horizontal mounting)

规格 size	i <sub>n</sub> =80~180		i <sub>n</sub> =200~315		i <sub>n</sub> =100~224		i <sub>n</sub> =250~400		G <sub>1</sub>
	d <sub>1</sub>	l <sub>1</sub>	d <sub>1</sub>	l <sub>1</sub>	d <sub>1</sub>	l <sub>1</sub>	d <sub>1</sub>	l <sub>1</sub>	
05	28	55	20	50					615
06					28	55	20	50	650
07	30	70	25	60					725
08					30	70	25	60	770
09	35	80	28	60					840
10					35	80	28	60	890
11	45	100	35	80					1010
12					45	100	35	80	1080

CK4齿轮箱规格05-12输出轴尺寸(卧式安装) output shaft dimensions of size 05-12 (horizontal mounting)

规格 size	齿轮箱输出轴尺寸(卧式安装) output shaft dimensions (horizontal mounting)								质量 weight (kg)	油量 oil quantity (L)	油站型号 oil station size (L/min)	
	输出实心轴平键 solid shaft			输出空心轴平键 Hollow Shaft		输出空心轴锁紧盘 Hollow Shaft with shrink Disk						
	d <sub>2</sub>	l <sub>2</sub>	G <sub>2</sub>	D <sub>2</sub>	G <sub>4</sub>	D <sub>2</sub>	D <sub>3</sub>	G <sub>4</sub>	G <sub>5</sub>			
05	100	210	165	95	165	100	100	165	240	335	15	
06	110	210	165	105	165	110	110	165	240	385	18	
07	120	210	195	115	195	120	120	195	280	555	30	
08	130	250	195	125	195	130	130	195	285	655	33	
09	140	250	235	135	235	140	145	235	330	890	48	
10	160	300	235	150	235	150	155	235	350	1020	50	
11	170	300	270	165	270	165	170	270	400	1480	80	
12	180	300	270	180	270	180	185	270	405	1750	90	

**CK4齿轮箱规格13~24外形尺寸(卧式安装)**

Dimension of gear unit of size 13-24 (horizontal mounting)

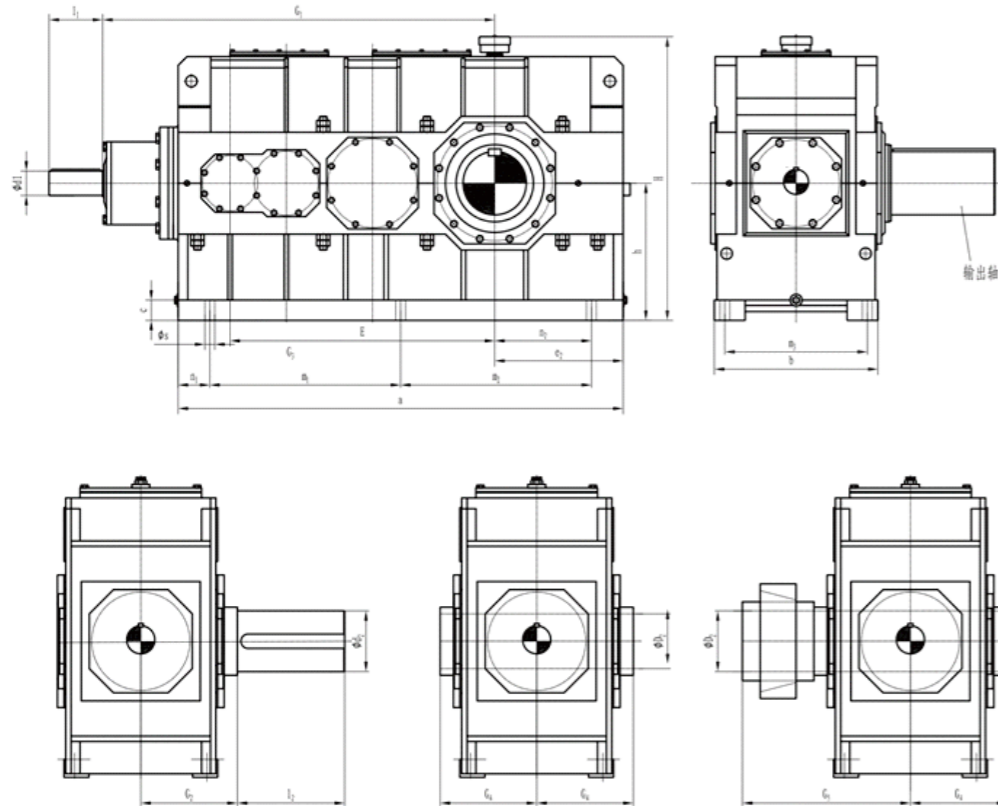

CK4SH

CK4HH

CK4DH

(实心轴平键 /solid shaft) (空心轴平键 /Hollow Shaft) (空心轴锁紧盘 /Hollow Shaft with shrink Disk)

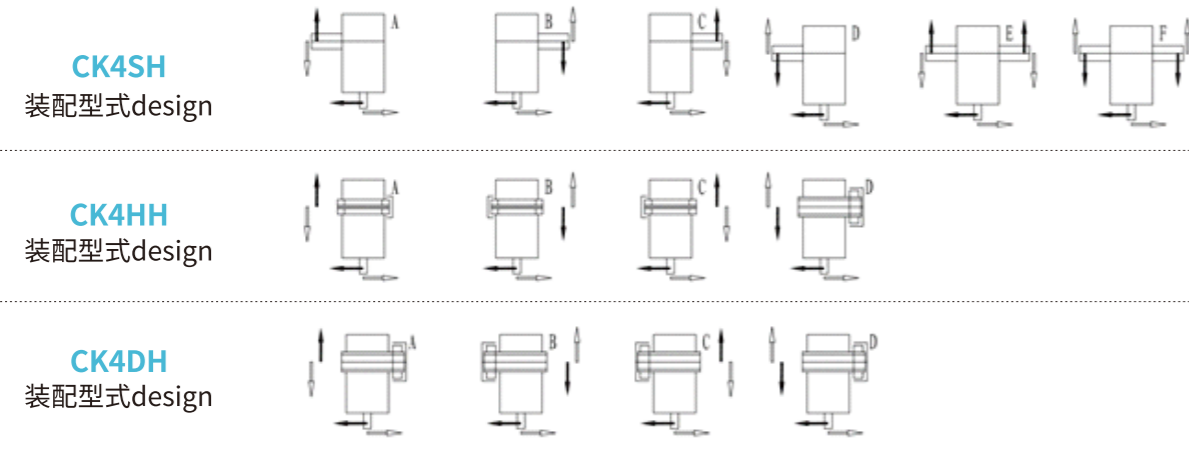

**CK4齿轮箱规格13-24外形尺寸(卧式安装)** Dimension of gear unit of size 13-24 (horizontal mounting)

规格 size	尺寸代号 Symbol														
	a	b	c	D <sub>5</sub>	E	H	h <sub>0.5</sub>	m <sub>1</sub>	m <sub>2</sub>	m <sub>3</sub>	n <sub>1</sub>	n <sub>2</sub>	n <sub>3</sub>	n <sub>4</sub>	s
13	1395	550	60	48	820	900	450	597.5	597.5	475	100	305	940	340	35
14	1535	550	60	48	890	900	450	597.5	737.5	475	100	375	1010	340	35
15	1680	625	70	55	987	1000	490	720	720	535	120	365	1135	375	42
16	1770	625	70	55	1033	1000	490	720	810	535	120	410	1180	375	42
17	1770	690	80	55	1035	1110	555	750	750	600	135	390	1175	425	42
18	1890	690	80	55	1095	1110	555	750	870	600	135	450	1235	425	42
19	2030	790	90	65	1190	1240	615	860	86	690	155	435	1365	475	48
20	2150	790	90	65	1250	1240	615	860	980	690	155	495	1425	475	48
21	2340	830	100	75	1387	1390	685	1000	1000	720	170	485	1600	520	56
22	2450	830	100	75	1442	1390	685	1000	1110	720	170	540	1655	520	56
23	2530	930	115	80	1505	1565	780	1085	1085	810	180	550	1725	580	56
24	2660	930	115	80	1570	1565	780	1085	1215	810	180	615	1790	580	56

**CK4齿轮箱规格13-24输入轴尺寸(卧式安装)** input shaft dimensions of size 13-24 (horizontal mounting)

规格 size	i <sub>n</sub> =80~180		i <sub>n</sub> =200~315		i <sub>n</sub> =100~224		i <sub>n</sub> =250~400		i <sub>n</sub> =90~200		i <sub>n</sub> =224~355		G <sub>1</sub>
	d <sub>1</sub>	l <sub>1</sub>	d <sub>1</sub>	l <sub>1</sub>	d <sub>1</sub>	l <sub>1</sub>	d <sub>1</sub>	l <sub>1</sub>	d <sub>1</sub>	l <sub>1</sub>	d <sub>1</sub>	l <sub>1</sub>	
13	55	110	40	100									1170
14					55	110	40	100					1240
15	70	135	50	110									1402
16									70	135	50	110	1448
17	70	135	50	110									1450
18									70	135	50	110	1510
19	80	165	60	140									1680
20									80	165	60	140	1740
21	90	165	70	140									1992
22									90	165	70	140	2047
23	90	165	70	140									2110
24									90	165	70	140	2175

**CK4齿轮箱规格13-24输出轴尺寸(卧式安装)** output shaft dimensions of size 13-24 (horizontal mounting)

规格 size	齿轮箱输出轴尺寸(卧式安装) output shaft dimensions (horizontal mounting)									质量 weight (kg)	油量 oil quantity (L)	油站型号 oil station size (L/min)
	输出实心轴平键 solid shaft			输出空心轴平键 Hollow Shaft		输出空心轴锁紧盘 Hollow Shaft with shrink Disk						
	d <sub>2</sub>	l <sub>2</sub>	G <sub>2</sub>	D <sub>2</sub>	G <sub>4</sub>	D <sub>2</sub>	D <sub>3</sub>	G <sub>4</sub>	G <sub>5</sub>			
13	200	350	335	190	335	190	195	335	480	2395	130	
14	210	350	335	210	335	210	215	335	480	2725	140	
15	230	410	380	230	380	230	235	380	550	3635	230	63
16	240	410	380	240	380	240	245	380	550	3965	235	63
17	250	410	415	250	415	250	260	415	600	4680	290	63
18	270	470	415	275	415	280	285	415	600	5180	305	63
19	290	470	465			285	295	465	670	6800	480	100
20	300	500	465			310	315	465	670	8200	550	100
21	320	500	490			330	335	490	715	9200	590	100
22	340	550	490			340	345	490	725	9900	680	100
23	360	590	540							12000	790	150
24	380	590	540							13500	910	150

# 四、其它说明

OTHER EXPLANATIONS

## 1 输出空心轴 Output Hollow Shaft

CH2/CH3/CH4/CK3/CK4型齿轮箱输出空心轴带长平键接口尺寸(卧式安装)

Hollow shaft dimensions (horizontal mounting)

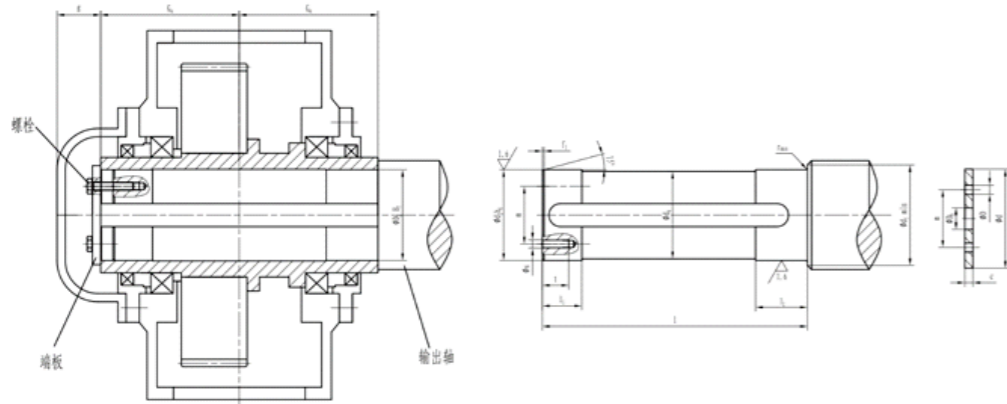

规格 size	工作机轴 driven machine shaft										挡板 End plate				螺栓 Screw		空心轴 Hollow shaft		
	d <sub>2</sub>	d <sub>4</sub>	d <sub>5</sub>	f <sub>1</sub>	l	l <sub>1</sub>	r	s	t	c	D	D <sub>9</sub>	d	m	s	数量	D <sub>2</sub>	G <sub>4</sub>	g
04	80	79.5	88	4	278	35	1.2	M10	18	10	11	22	100	60	M10×25	2	80	140	35
05	95	94.5	105	5	328	40	1.6	M10	18	10	11	26	120	70	M10×25	2	95	165	40
06	105	104.5	116	5	328	45	1.6	M10	18	10	11	26	120	70	M10×25	2	105	165	40
07	115	114.5	126	5	388	50	1.6	M12	20	12	13.5	26	140	80	M12×30	2	115	195	40
08	125	124.5	136	6	388	55	2.5	M12	20	12	13.5	26	150	85	M12×30	2	125	195	40
09	135	134.5	147	6	467	60	2.5	M12	20	12	13.5	33	160	90	M12×30	2	135	235	45
10	150	149.5	162	6	467	65	2.5	M12	20	12	13.5	33	185	110	M12×30	2	150	235	45
11	165	164.5	177	7	537	70	2.5	M16	28	15	17.5	33	195	120	M16×40	2	165	270	45
12	180	179.5	192	7	537	75	2.5	M16	28	15	17.5	33	220	130	M16×40	2	180	270	45
13	190	189.5	206	7	667	80	3	M16	28	18	17.5	33	230	140	M16×40	2	190	335	45
14	210	209.5	226	8	667	85	3	M16	28	18	17.5	33	250	160	M16×40	2	210	335	45
15	230	229.5	248	8	756	100	3	M20	38	25	22	39	270	180	M20×55	4	230	380	60
16	240	239.5	258	8	756	100	3	M20	38	25	22	39	280	180	M20×55	4	240	380	60
17	250	249.5	270	8	826	110	4	M20	38	25	22	39	300	190	M20×55	4	250	415	60
18	275	274.5	295	9	826	120	4	M20	38	25	22	39	330	210	M20×55	4	275	415	60

CK2型齿轮箱输出空心轴带长平键接口尺寸(卧式安装)

Hollow shaft dimensions (horizontal mounting)

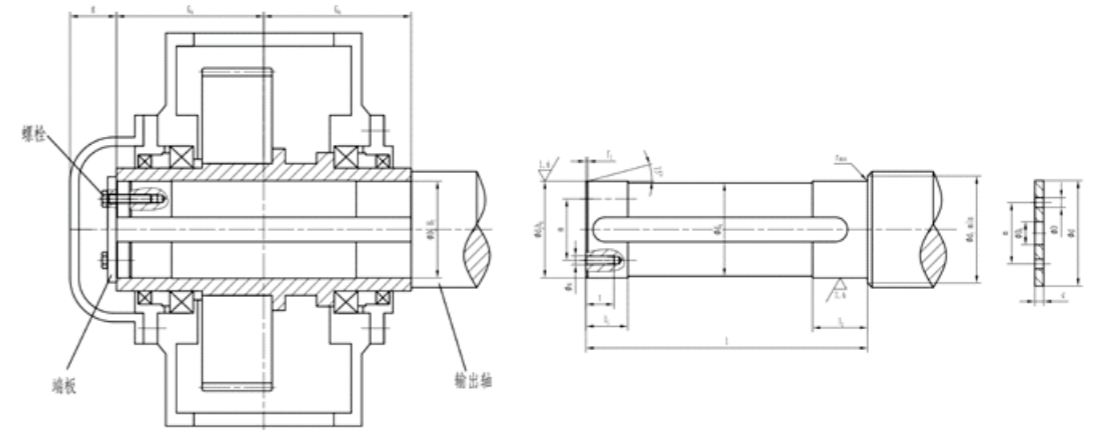

规格 size	工作机轴 driven machine shaft										挡板 End plate				螺栓 Screw		空心轴 Hollow shaft		
	d <sub>2</sub>	d <sub>4</sub>	d <sub>5</sub>	f <sub>1</sub>	l	l <sub>1</sub>	r	s	t	c	D	D <sub>9</sub>	d	m	s	数量	D <sub>2</sub>	G <sub>4</sub>	g
04	80	79.5	88	4	338	35	1.2	M10	18	10	11	22	100	60	M10×25	2	80	170	35
05	95	94.5	105	5	398	40	1.6	M10	18	10	11	26	120	70	M10×25	2	95	200	40
06	105	104.5	116	5	398	45	1.6	M10	18	10	11	26	120	70	M10×25	2	105	200	40
07	115	114.5	126	5	468	50	1.6	M12	20	12	13.5	26	140	80	M12×30	2	115	235	40
08	125	124.5	136	6	468	55	2.5	M12	20	12	13.5	26	150	85	M12×30	2	125	235	40
09	135	134.5	147	6	537	60	2.5	M12	20	12	13.5	33	160	90	M12×30	2	135	270	45
10	150	149.5	162	6	537	65	2.5	M12	20	12	13.5	33	185	110	M12×30	2	150	270	45
11	165	164.5	177	7	637	70	2.5	M16	28	15	17.5	33	195	120	M16×40	2	165	320	45
12	180	179.5	192	7	637	75	2.5	M16	28	15	17.5	33	220	130	M16×40	2	180	32	45
13																			
14	210	209.5	226	8	777	85	3	M16	28	18	17.5	33	250	160	M16×40	2	210	390	45
15																			
16	240	239.5	258	8	896	100	3	M20	38	25	22	39	280	180	M20×55	4	240	450	60
17																			
18	275	274.5	295	9	1016	120	4	M20	38	25	22	39	330	210	M20×55	4	275	510	60

## 2 输出空心轴带锁紧盘 Hollow Shaft with shrink Disk

### CH2/CH3/CH4/CK3/CK4型齿轮箱输出空心轴带锁紧盘接口尺寸(卧式安装)

Hollow shaft (with shrink Disk) dimensions (horizontal mounting)

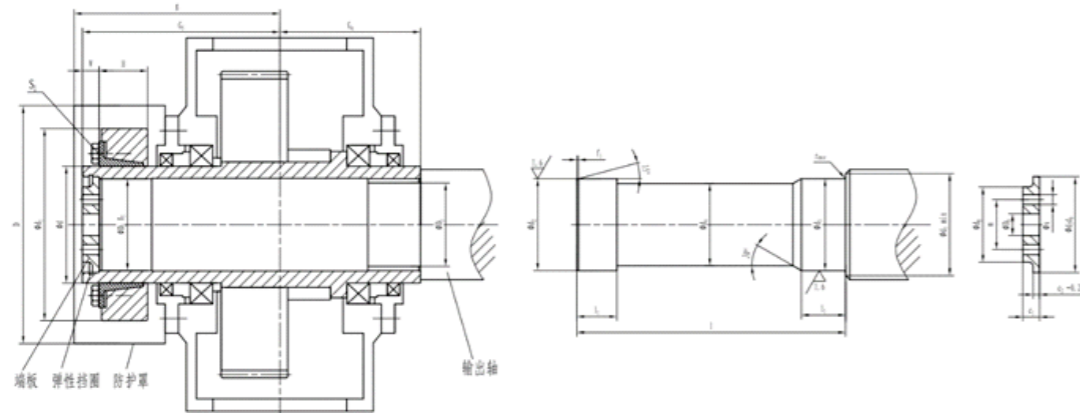

规格 size	工作机轴 driven machine shaft								挡板 End plate						螺栓 Screw		弹性挡圈 circlip
	d <sub>2</sub>	d <sub>3</sub>	d <sub>4</sub>	d <sub>5</sub>	f <sub>1</sub>	L	L <sub>1</sub>	r	c <sub>1</sub>	c <sub>2</sub>	d <sub>7</sub>	d <sub>8</sub>	d <sub>9</sub>	m	s	数量	s
04	85 g6	85 h6	84.5	95	4	326	48	2	17	7	90	70	22	50	M8	2	90×3
05	100 g6	100 h6	99.5	114	5	383	53	2	20	8	105	80	26	55	M10	2	105×4
06	110 g6	110 h6	109.5	124	5	383	58	3	20	8	115	85	26	60	M10	2	115×4
07	120 g6	120 h6	119.5	134	5	453	68	3	20	8	125	90	26	65	M12	2	125×4
08	130 g6	130 h6	129.5	145	6	458	73	3	20	8	135	100	26	70	M12	2	135×4
09	140 g6	145 m6	139.5	160	6	539	82	4	23	10	150	110	33	80	M12	2	150×4
10	150 g6	155 m6	149.5	170	6	559	92	4	23	10	160	120	33	90	M12	2	160×4
11	165 f6	170 m6	164.5	185	7	644	112	4	23	10	175	130	33	90	M12	2	175×4
12	180 f6	185 m6	179.5	200	7	649	122	4	23	10	190	140	33	100	M16	2	190×4
13	190 f6	195 m6	189.5	213	7	789	137	5	23	10	200	150	33	110	M16	2	200×4
14	210 f6	215 m6	209.5	233	8	784	147	5	28	14	220	170	33	130	M16	2	220×5
15	230 f6	235 m6	229.5	253	8	899	157	5	28	14	240	180	39	140	M16	2	240×5
16	240 f6	245 m6	239.5	263	8	899	157	5	28	14	250	190	39	150	M20	2	250×5
17	250 f6	260 m6	249.5	278	8	982	177	5	30	14	265	200	39	150	M20	2	265×5
18	280 f6	285 m6	279.5	306	9	982	177	5	30	14	290	210	39	160	M20	2	290×5
19	285 f6	295 m6	284.5	316	9	1100	187	5	32	15	300	220	39	170	M24	2	300×5
20	310 f6	315 m6	309.5	336	9	1100	187	5	32	15	320	230	39	180	M24	2	320×6
21	330 f6	335 m6	329	358	9	1160	205	5	40	20	340	250	45	190	M24	2	340×6
22	340 f6	345 m6	339	368	9	1170	215	5	40	20	350	260	45	200	M24	2	350×6

规格 size	空心轴 Hollow shaft				型号	锁紧盘 Shrink disk				螺栓 Screw	防护罩 Guard	
	D <sub>3</sub>	D <sub>4</sub>	G <sub>4</sub>	G <sub>5</sub>		d	d <sub>1</sub>	H	W	s	D	g
04	85	85	140	205	110	110	185	40	20	M 12	235	225
05	100	100	165	240	125	125	215	53	20	M 12	275	260
06	110	110	165	240	140	140	230	58	20	M 14	285	255
07	120	120	195	280	155	155	263	62	23	M 14	330	305
08	130	130	195	285	165	165	290	68	23	M 16	340	305
09	140	145	235	330	175	175	300	68	28	M 16	360	355
10	150	155	235	350	200	200	350	85	28	M 16	395	365
11	165	170	270	400	220	220	370	103	30	M 20	435	420
12	180	185	270	405	240	240	405	107	30	M 20	450	420
13	190	195	335	480	260	260	430	119	30	M 20	500	505
14	210	215	335	480	280	280	460	132	30	M 20	525	505
15	230	235	380	550	300	300	485	140	35	M 24	575	575
16	240	245	380	550	320	320	520	140	35	M 24	595	575
17	250	260	415	600	340	340	570	155	35	M 24	615	630
18	280	285	415	600	360	360	590	159	35	M 24	635	625
19	285	295	465	670	380	380	640	166	40	M 27		
20	310	315	465	670	390	390	650	166	40	M 27		
21	330	335	490	715	420	420	670	186	45	M 27		
22	340	345	490	725	440	440	720	194	45	M 27		

#### 注意 NOTE

- 工作机轴材质为 42CrMo 或强度更高的钢材, 工作机轴表面不得沾有机油或润滑脂;
- 在订货时锁紧盘以散件形式提供;

.....

• The shaft material of the driven machine is 42CrMo or steel with higher strength. The surface of the driven machine shaft must not be contaminated with engine oil or grease.

- The shrink disk will be provided separately.

**CK2型齿轮箱输出空心轴带锁紧盘接口尺寸(卧式安装)**

Hollow shaft (with shrink Disk) dimensions (horizontal mounting)

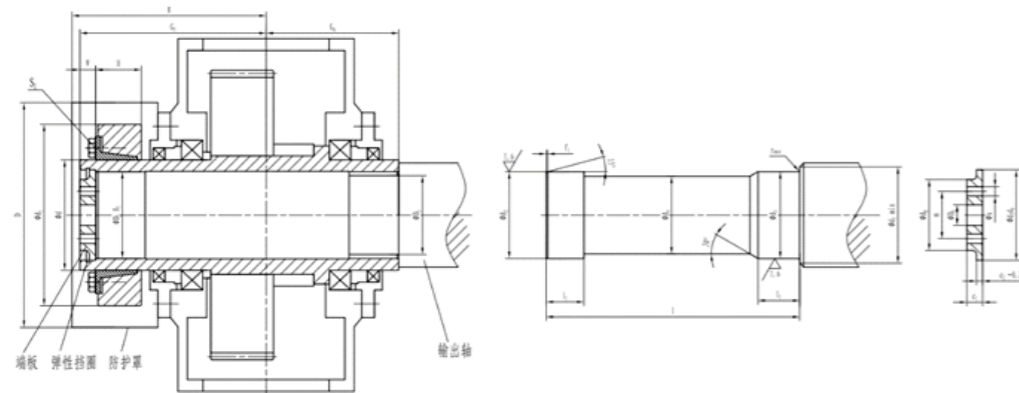

规格 size	工作机轴 driven machine shaft								挡板 End plate						螺栓 Screw		弹性挡圈 circlip
	d <sub>2</sub>	d <sub>3</sub>	d <sub>4</sub>	d <sub>5</sub>	f <sub>1</sub>	L	L <sub>1</sub>	r	c <sub>1</sub>	c <sub>2</sub>	d <sub>7</sub>	d <sub>8</sub>	d <sub>9</sub>	m	s	数量	s
04	85g6	85h6	85	95	4	386	48	2	17	7	90	70	22	50	M8	2	90×3
05	100g6	100h6	100	114	5	453	53	2	20	8	105	80	26	55	M10	2	105×4
06	110g6	110h6	110	124	5	453	58	3	20	8	115	85	26	60	M10	2	115×4
07	120g6	120h6	120	134	5	533	68	3	20	8	125	90	26	65	M12	2	125×4
08	130g6	130h6	130	145	6	538	73	3	20	8	135	100	26	70	M12	2	135×4
09	140g6	145m6	140	160	6	609	82	4	23	10	150	110	33	80	M12	2	150×4
10	150g6	155m6	150	170	6	629	92	4	23	10	160	120	33	90	M12	2	160×4
11	165f6	170m6	165	185	7	744	112	4	23	10	175	130	33	90	M12	2	175×4
12	180f6	185m6	180	200	7	749	122	4	23	10	190	140	33	100	M16	2	190×4
13																	
14	210f6	215m6	210	233	8	894	147	5	28	14	220	170	33	130	M16	2	220×5
15																	
16	240f6	245m6	240	263	8	1039	157	5	28	14	250	190	39	150	M20	2	250×5
17																	
18	280f6	285m6	280	306	9	1177	177	5	30	14	290	210	39	160	M20	2	290×5

规格 size	空心轴 Hollow shaft				锁紧盘 Shrink disk					螺栓 Screw	防护罩 Guard	
	D <sub>3</sub>	D <sub>4</sub>	G <sub>4</sub>	G <sub>5</sub>	型号	d	d <sub>i</sub>	H	W	s	D	g
04	85	85	170	235	110	110	185	40	20	M12	235	225
05	100	100	200	275	125	125	215	53	20	M12	275	260
06	110	110	200	275	140	140	230	58	20	M14	285	255
07	120	120	235	320	155	155	263	62	23	M14	330	305
08	130	130	235	325	165	165	290	68	23	M16	340	305
09	140	145	270	365	175	175	300	68	28	M16	360	355
10	150	155	270	385	200	200	350	85	28	M16	395	365
11	165	170	320	450	220	220	370	103	30	M20	435	420
12	180	185	320	455	240	240	405	107	30	M20	450	420
13												
14	210	215	390	535	280	280	460	132	30	M20	525	505
15												
16	240	245	450	620	320	320	520	140	35	M24	595	575
17												
18	280	285	510	700	360	360	590	159	35	M24	635	625

注意 NOTE

- 工作机轴材质为 42CrMo 或强度更高的钢材, 工作机轴表面不得沾有机油或润滑脂;
  - 在订货时锁紧盘以散件形式提供;
- 
- The shaft material of the driven machine is 42CrMo or steel with higher strength. The surface of the driven machine shaft must not be contaminated with engine oil or grease.
  - The shrink disc will be provided separately.

**齿齿相依·带动未来**  
GEARING INTERDEPENDENCE MOVING FUTURE